

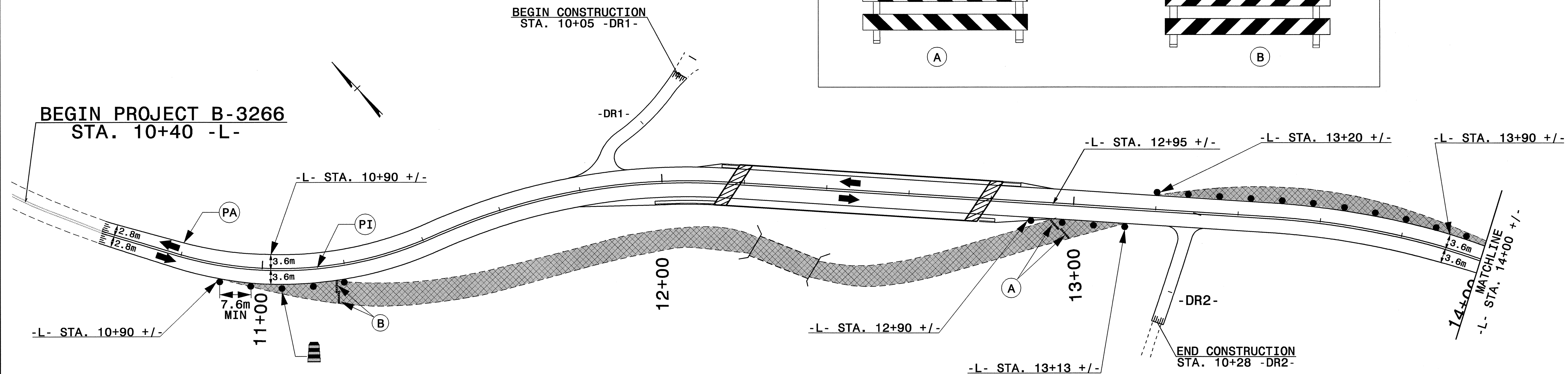

PROJ. REFERENCE NO.	SHEET NO.
B-3266	TCP-4

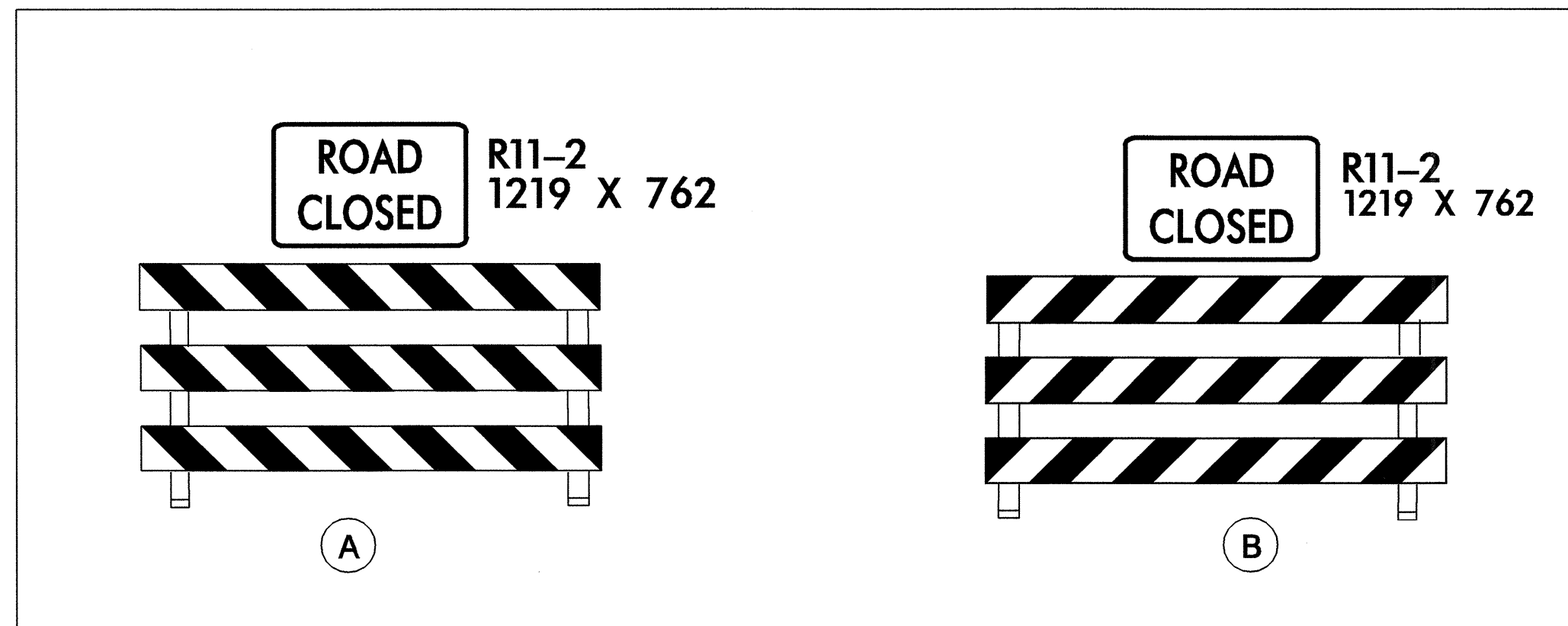

PHASE II

WORK IN A CONTINUOUS MANNER TO COMPLETE STEPS 1 THRU 3

NOTE: - RETURN TRAFFIC TO A TWO-LANE, TWO-WAY TRAFFIC PATTERN ON PROPOSED -L- BY THE END OF THE WORKDAY
 - NOTIFY STATE FORCES TWENTY-ONE (21) DAYS PRIOR TO COMPLETION OF PROPOSED SR 1567, SO THAT PERMANENT SIGNING CAN BE INSTALLED.

- STEP 1: USING ROADWAY STANDARD DRAWING 1101.02, SHEET 1 OF 7, PLACE TRAFFIC IN SOUTHBOUND LANE OF EXISTING ROADWAY IN A TEMPORARY ONE-LANE, TWO-WAY TRAFFIC PATTERN. CONSTRUCT STA. 10+60 +/- TO STA. 11+30 +/- AND STA. 12+90 +/- TO STA. 13+20 +/- UP TO BUT NOT INCLUDING THE FINAL SURFACE LAYER, COMPLETE TIE IN OF THE NORTHBOUND LANE AND PLACE INTERIM PAVEMENT MARKINGS ON NORTHBOUND LANE OF PROPOSED -L- FROM STA. 10+60 +/- TO STA. 14+46 +/-.
- STEP 2: USING ROADWAY STANDARD DRAWING 1101.02, SHEET 1 OF 7, SWITCH TRAFFIC INTO THE NORTHBOUND LANE OF PROPOSED -L- IN A TEMPORARY ONE-LANE, TWO-WAY TRAFFIC PATTERN. COMPLETE TIE IN OF SOUTHBOUND LANE AND PLACE INTERIM PAVEMENT MARKINGS ON SOUTHBOUND LANE OF PROPOSED -L- FROM STA. 10+60 +/- TO STA. 14+46. (REFER TO ROADWAY STANDARD DRAWING NUMBERS 1205.01, 1205.02, AND 1205.12 FOR PAVEMENT MARKINGS.)
- STEP 3: SWITCH TRAFFIC ONTO PROPOSED -L- IN A TWO LANE, TWO WAY TRAFFIC PATTERN. PLACE TYPE III BARRICADES AND DRUMS ON EXISTING ROAD (SEE TCP-4).
- STEP 4: USING ROADWAY STANDARD DRAWINGS 1101.02, SHEET 1 OF 7, AND 1101.04, AS NEEDED, COMPLETE SHOULDER CONSTRUCTION FROM STA. 13+20 +/- TO STA. 14+20 +/-.

REMOVE EXISTING STRUCTURE AND ROADWAY APPROACHES.
- STEP 5: USING ROADWAY STANDARD DRAWING 1101.02, SHEET 1 OF 7, PLACE FINAL LAYER OF SURFACE COURSE AND FINAL PAVEMENT MARKINGS FROM STA. 10+60 TO STA. 14+46. (REFER TO ROADWAY STANDARD DRAWING NUMBERS 1205.01, 1205.02, AND 1205.12 FOR PAVEMENT MARKINGS.)
- STEP 6: UPON INSTALLATION OF PERMANENT SIGNING BY STATE FORCES, REMOVE ALL TYPE III BARRICADES, DRUMS AND ADVANCE WARNING SIGNING.

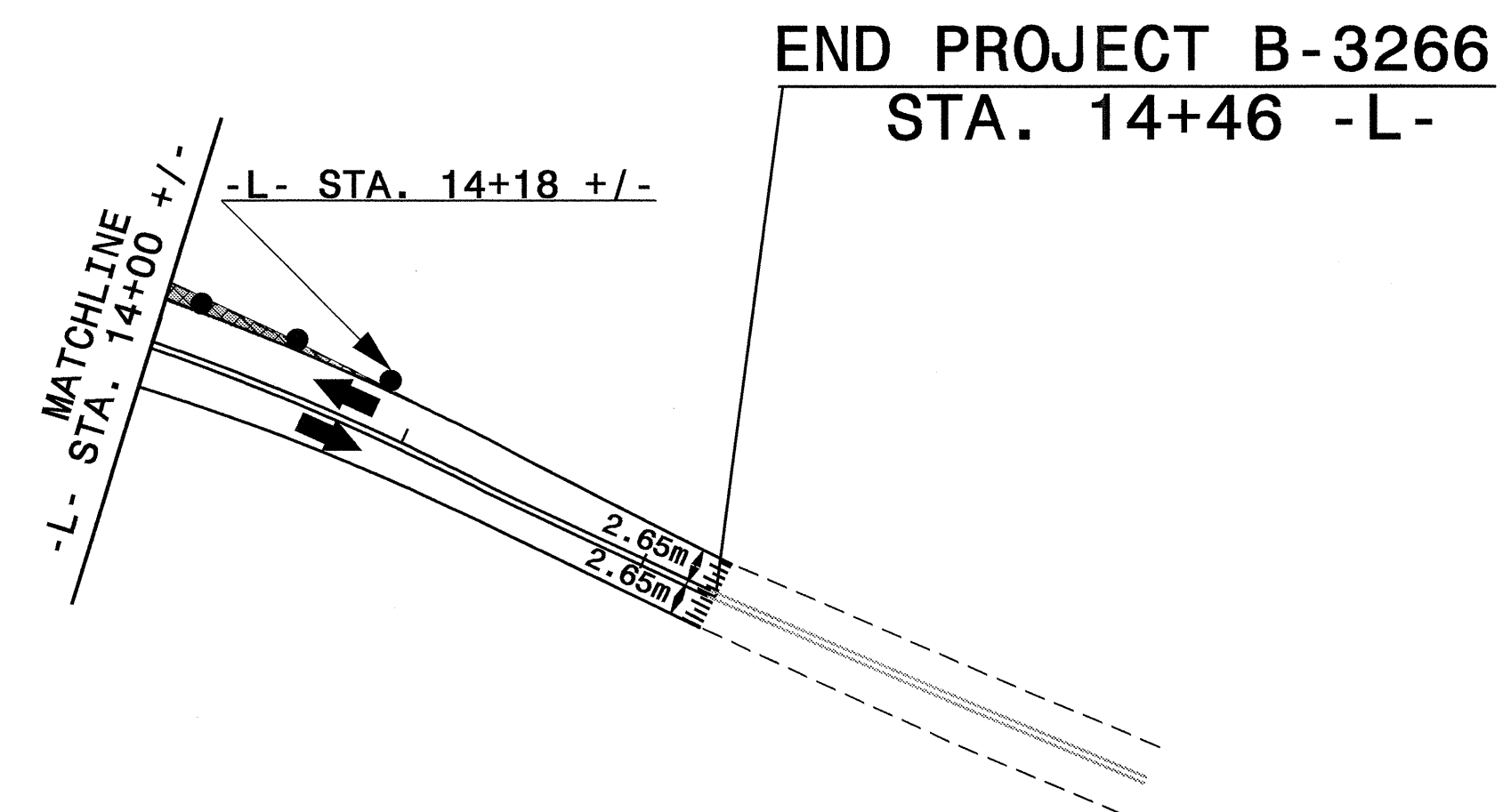

APPROVED: <i>Jessica D. Tuse</i> DATE: 10/22/04	PHASE II AND PAVEMENT MARKING		
	SCALE: NONE		
	DATE: 7/2004		REVISIONS
	DWG. BY: MLM		
	DESIGN BY: MLM		
	REVIEWED BY: JDK		

20-OCT-2004 11:26
 H:\TCP\B3266_T0_top04.dgn
 mmarley AT TET088647