

SURVEY CONTROL SHEET 8.2407801

WBS 33243.1.1

NCDOT GPS STATION B3703-2
 LOCALIZED PROJECT COORDINATES
 N=691496.8682
 E=2078763.3129



NCDOT GPS STATION B3703-1
 LOCALIZED PROJECT COORDINATES
 N=690589.8261
 E=2077980.3453

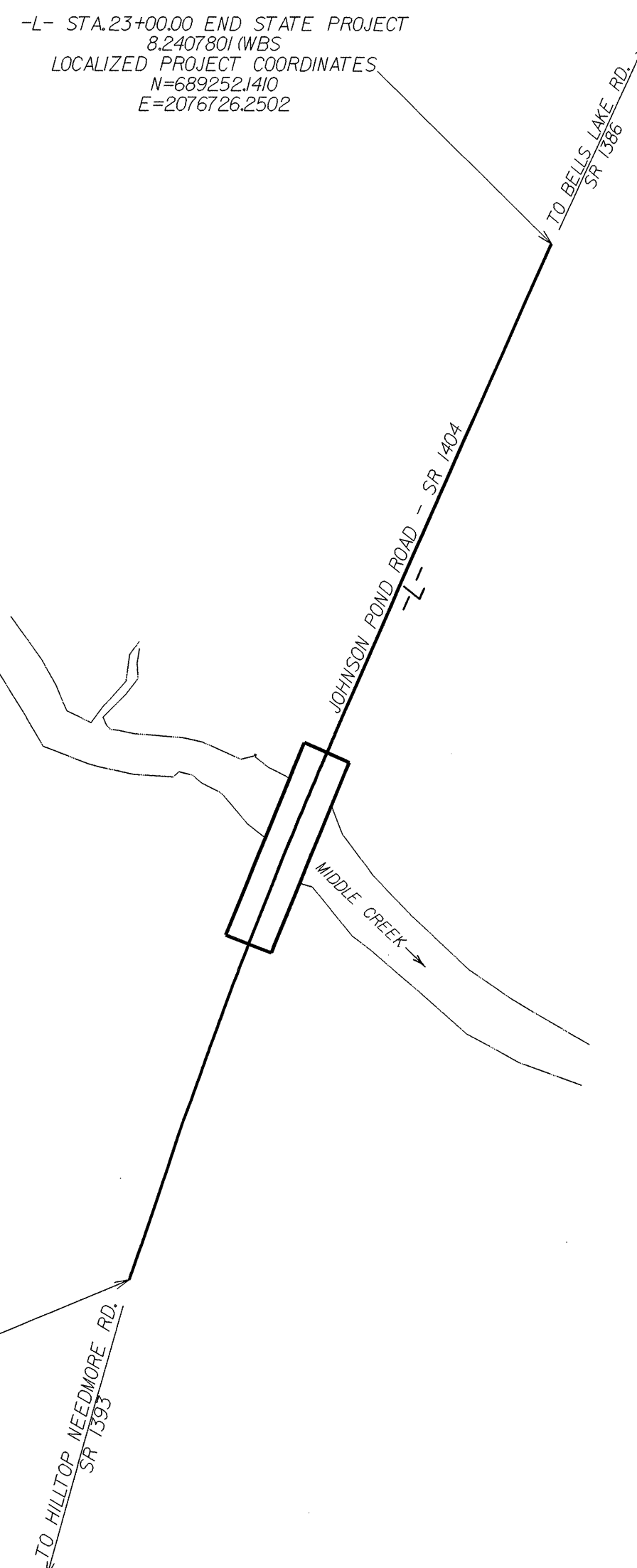

-L- STA.23+00.00 END STATE PROJECT
 8.2407801 WBS
 LOCALIZED PROJECT COORDINATES
 N=689252.1410
 E=2076726.2502

-L- STA.14+80.00 BEGIN STATE PROJECT
 8.2407801 WBS
 LOCALIZED PROJECT COORDINATES
 N=688492.9698
 E=2076417.7460

BL	POINT	DESC.	NORTH	EAST	ELEVATION	L STATION	OFFSET
1		BL-1	689039.0459	2076255.5691	278.62	OUTSIDE PROJECT LIMITS	
2		BL-2	688400.0795	2076370.6688	272.94	13+76.96	15.11 LT
3		BL-3	688887.9209	2076550.5043	271.21	18+95.87	13.57 LT
4		BL-4	689227.5707	2076700.7129	270.12	22+67.20	13.43 LT
5		BL-5	689576.6321	2076854.2034	271.47	26+48.52	14.11 LT

.....
 BM1 ELEVATION = 282.31
 N 689083 E 2076177
 L STATION 10+23 102 LEFT
 R/R SPIKE SET IN 10' OAK

 BM2 ELEVATION = 269.55
 N 688922 E 2076484
 L STATION 19+00 88 LEFT
 R/R SPIKE SET IN 15' OAK

 BM3 ELEVATION = 269.79
 N 689643 E 2076816
 L STATION 26+67
 N 46° 50' 03.4" W DIST 80.41
 R/R SPIKE SET IN 8' OAK

DATUM DESCRIPTION

THE LOCALIZED COORDINATE SYSTEM DEVELOPED FOR THIS PROJECT IS BASED ON THE STATE PLANE COORDINATES ESTABLISHED BY NCDOT FOR MONUMENT "B3703-1" WITH NAD 1983 STATE PLANE GRID COORDINATES OF NORTHING: 690589.8261(ft) EASTING: 2077980.3453(ft) THE AVERAGE COMBINED GRID FACTOR USED ON THIS PROJECT (GROUND TO GRID) IS: 0.99988555 THE N.C. LAMBERT GRID BEARING AND LOCALIZED HORIZONTAL GROUND DISTANCE FROM "B3703-1" TO -L- STATION 14+80.00 IS S 36° 41' 37.91" W 2615.057 FT ALL LINEAR DIMENSIONS ARE LOCALIZED HORIZONTAL DISTANCES VERTICAL DATUM USED IS NAVD88

NOTES:

THE CONTROL DATA FOR THIS PROJECT CAN BE FOUND ELECTRONICALLY BY SELECTING PROJECT CONTROL DATA AT:
[HTTP://WWW.DOH.DOT.STATE.NC.US/PRECONSTRUCT/HIGHWAY/LOCATION/PROJECT/B3703_LS_CONTROL_041130.TXT](http://www.doh.dot.state.nc.us/preconstruct/highway/location/project/B3703_LS_CONTROL_041130.TXT)

SITE CALIBRATION INFORMATION HAS NOT BEEN PROVIDED FOR THIS PROJECT. IF FURTHER INFORMATION IS NEEDED, PLEASE CONTACT THE LOCATION AND SURVEYS UNIT.

● INDICATES GEODETIC CONTROL MONUMENTS USED OR SET FOR HORIZONTAL PROJECT CONTROL BY THE NCDOT LOCATION AND SURVEYS UNIT.

PROJECT CONTROL ESTABLISHED USING GLOBAL POSITIONING SYSTEM.

NOTE: DRAWING NOT TO SCALE