

**DATUM DESCRIPTION**

THE LOCALIZED COORDINATE SYSTEM DEVELOPED FOR THIS PROJECT IS BASED ON THE STATE PLANE COORDINATES ESTABLISHED BY NCDOT FOR MONUMENT "B3376-1" WITH NAD 83 STATE PLANE GRID COORDINATES OF NORTHING: 218812.248 EASTING: 645690.466 THE AVERAGE COMBINED GRID FACTOR USED ON THIS PROJECT (GROUND TO GRID) IS: 0.99989708 THE NC LAMBERT GRID BEARING LOCALIZED HORIZONTAL GROUND DISTANCE FROM "B3376-1" TO -L- STATION 10+62.132 IS N 6° 58' 03.32" E DISTANCE 439.027m ALL LINEAR DIMENSIONS ARE LOCALIZED HORIZONTAL DISTANCES VERTICAL DATUM USED IS NGVD 29

PROJECT REFERENCE NO. **B-3376** SHEET NO. **U0-2**

**UTILITIES BY OTHERS**

NOTE: ALL PROPOSED UTILITY WORK SHOWN ON THIS SHEET WILL BE DONE BY OTHERS

METRIC

5 0 10 SCALE

-DET-

PI Sta 10+11.615	PI Sta 11+62.483
$\Delta = 10' 37" 01.6" (LT)$	$\Delta = 36' 08" 59.6" (RT)$
L = 23.163	L = 94.640
T = 11.615	T = 48.955
R = 125.000	R = 150.000

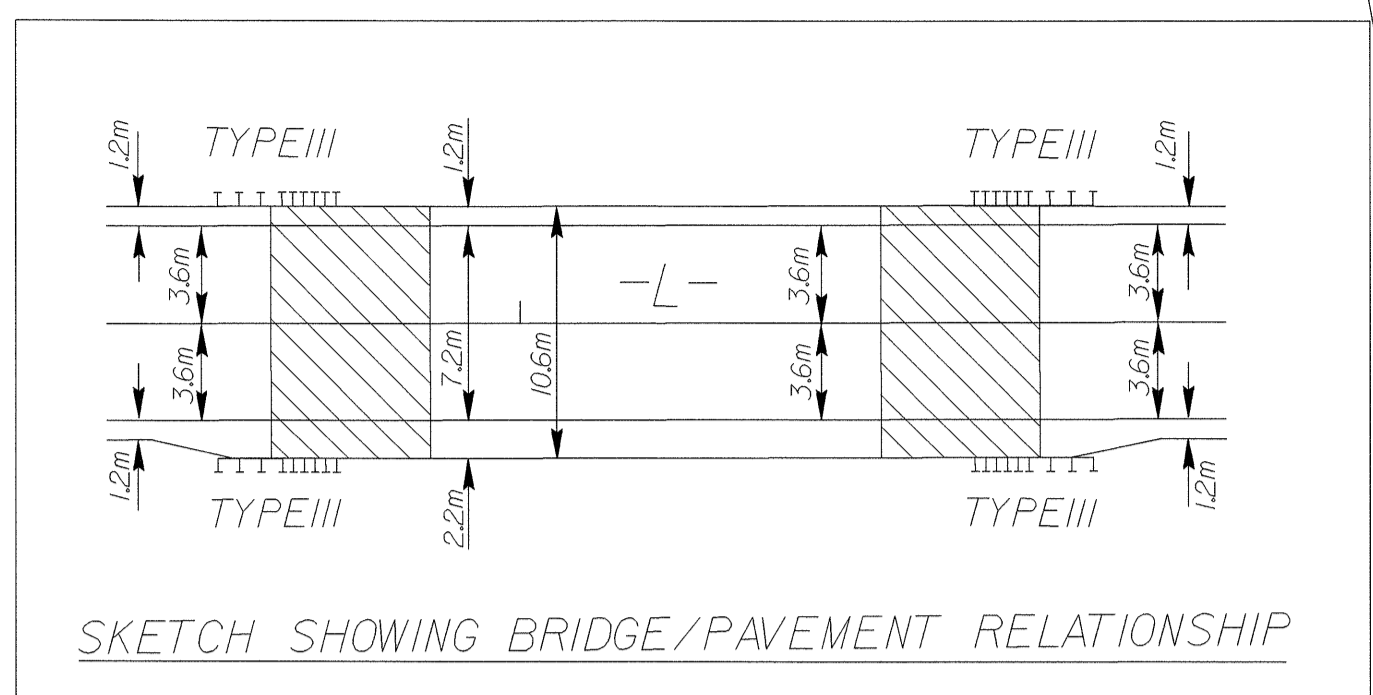

FOR DETOUR PLANS SEE SHEET NO. 6 & 7  
FOR PROFILES SEE SHEET NO. 8 & 9

NOTE: SHOULDER BERM GUTTER REQUIRED AT THE FOLLOWING APPR. STATIONS  
-L- STA. 12+58 TO 12+66.38+- RT  
-L- STA. 13+13.62+- TO 13+26 RT

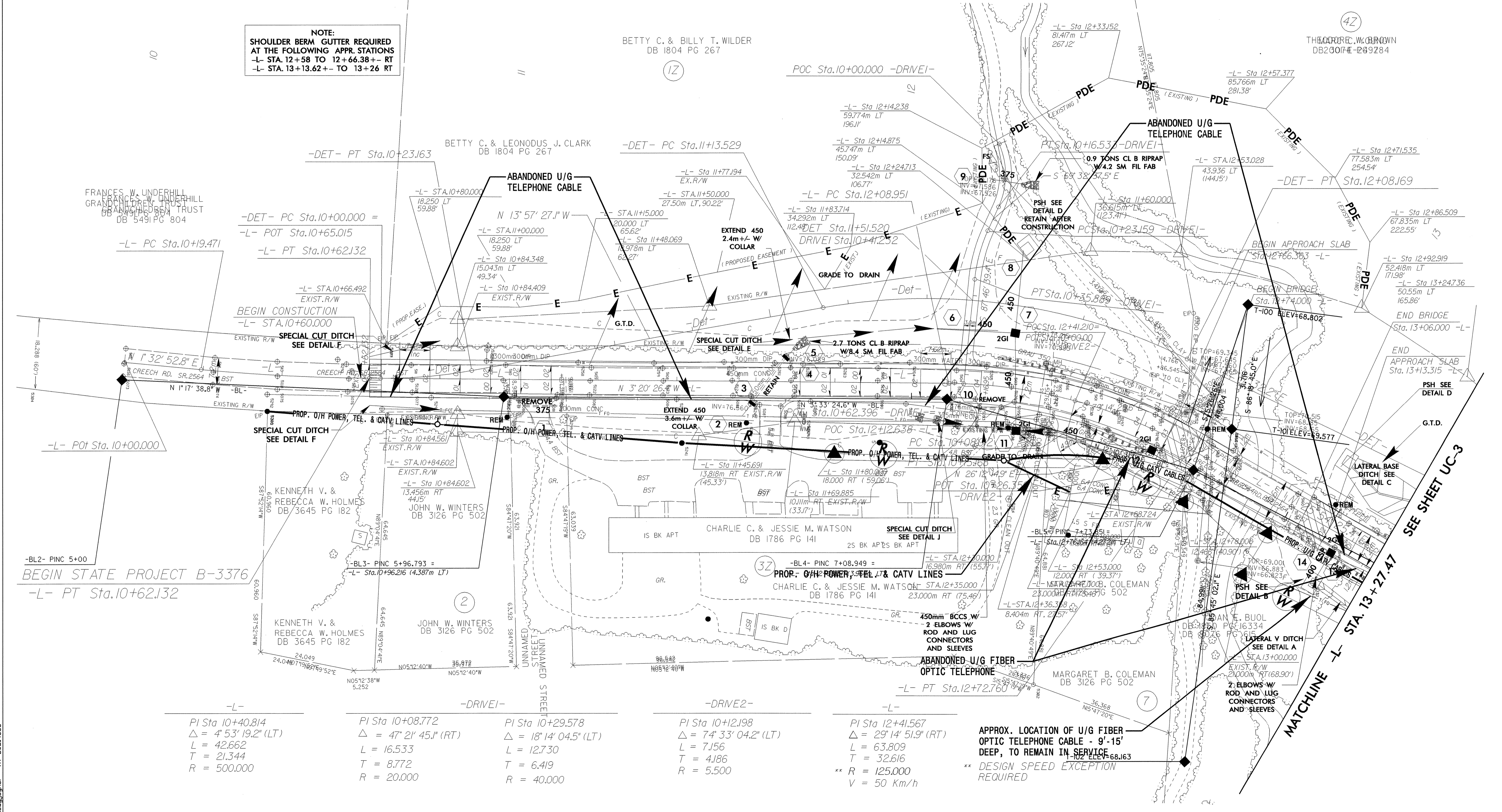

-L-	-DRIVE 1-	-DRIVE 2-	-L-
PI Sta 10+40.814	PI Sta 10+08.772	PI Sta 10+29.578	PI Sta 12+41.567
$\Delta = 4' 53" 19.2" (LT)$	$\Delta = 47' 21" 45.1" (RT)$	$\Delta = 18' 14" 04.5" (LT)$	$\Delta = 29' 14" 51.9" (RT)$
L = 42.662	L = 16.533	L = 12.730	L = 63.809
T = 21.344	T = 8.772	T = 6.419	T = 32.616
R = 500.000	R = 20.000	R = 40.000	** R = 125.000
			V = 50 Km/h

APPROX. LOCATION OF U/G FIBER OPTIC TELEPHONE CABLE - 9'-15" DEEP, TO REMAIN IN SERVICE  
\*\* DESIGN SPEED EXCEPTION REQUIRED

8/17/2004  
 C:\Users\pjh\Documents\Projects\B3376\B3376s4\_U02.ut.pah.dgn  
 11:21:48 AM  
 PJH