

DATUM DESCRIPTION

THE LOCALIZED COORDINATE SYSTEM DEVELOPED FOR THIS PROJECT IS BASED ON THE STATE PLANE COORDINATES ESTABLISHED BY NCDOT FOR MONUMENT B3376-1 WITH NAD 83 STATE PLANE GRID COORDINATES OF NORTHING: 218812.248 EASTING: 645690.466 THE AVERAGE COMBINED GRID FACTOR USED ON THIS PROJECT (GROUND TO GRID) IS: 0.99989708 THE NC LAMBERT GRID BEARING LOCALIZED HORIZONTAL GROUND DISTANCE FROM 'B3376-1' TO -L- STATION 10+60.000 IS N 7° 01' 01.24" E DISTANCE 436.928m ALL LINEAR DIMENSIONS ARE LOCALIZED HORIZONTAL DISTANCES VERTICAL DATUM USED IS NGVD 29

-DET-

PI Sta 10+11.615	PI Sta 11+62.483
$\Delta = 10^{\circ} 37' 01.6" (LT)$	$\Delta = 36^{\circ} 08' 59.6" (RT)$
L = 23.163	L = 94.640
T = 11.615	T = 48.955
R = 125.000	R = 150.000

METRIC

5 0 10

CONSTR. REV.

R / W REV.

PROJECT REFERENCE NO. B-3376 SHEET NO. 4

R / W SHEET NO.

ROADWAY DESIGN ENGINEER

HYDRAULICS ENGINEER

PROFESSIONAL SEAL 18181

PROFESSIONAL SEAL 18181

GREGORY E. BRUN

9-28-04

9/27/04

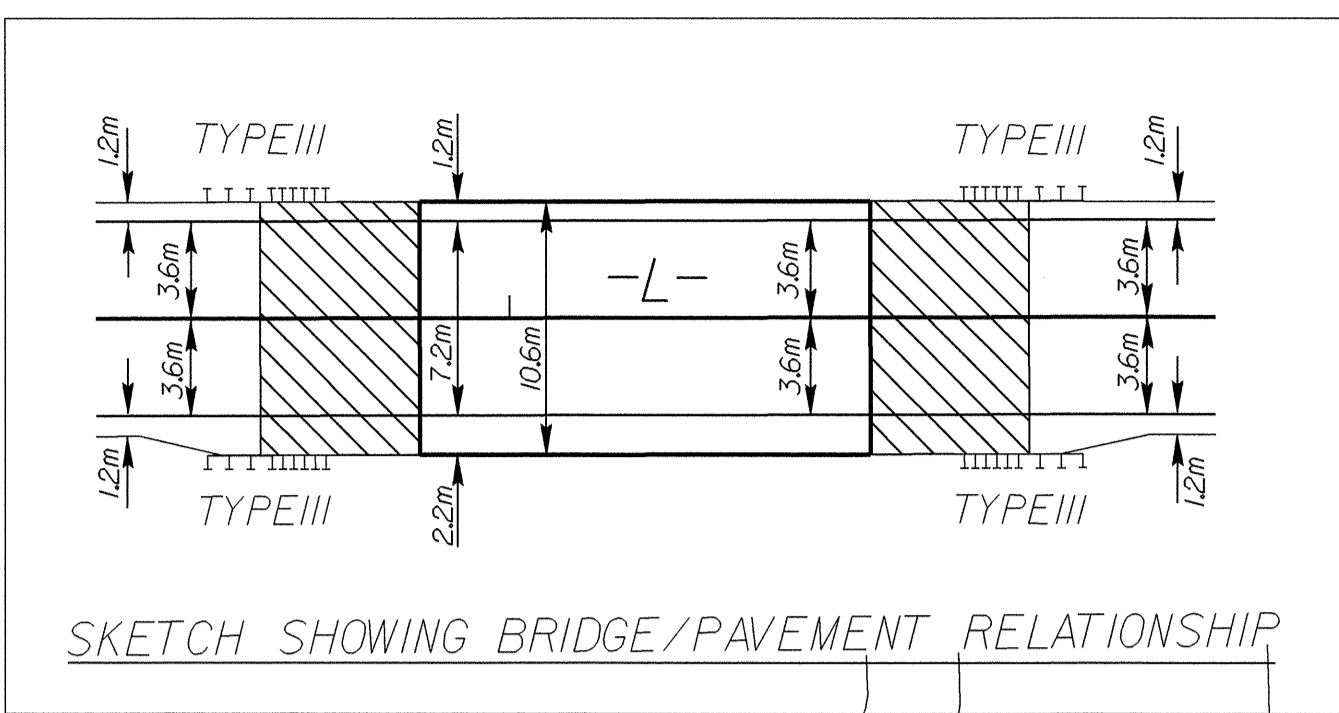

SEE SHEET NO. S-1 THRU. S-23 FOR STRUCTURE PLANS FOR DETOUR PLANS SEE SHEET NO. 6 & 7 FOR PROFILES SEE SHEET NO. 8 & 9 FOR DITCH DETAIL SEE SHEET NO. 2-B

NOTE:
SHOULDER BERM GUTTER REQUIRED AT THE FOLLOWING APPR. STATIONS
-L- STA. 12+58 TO 12+66.38+- RT
-L- STA. 13+13.62+- TO 13+26 RT

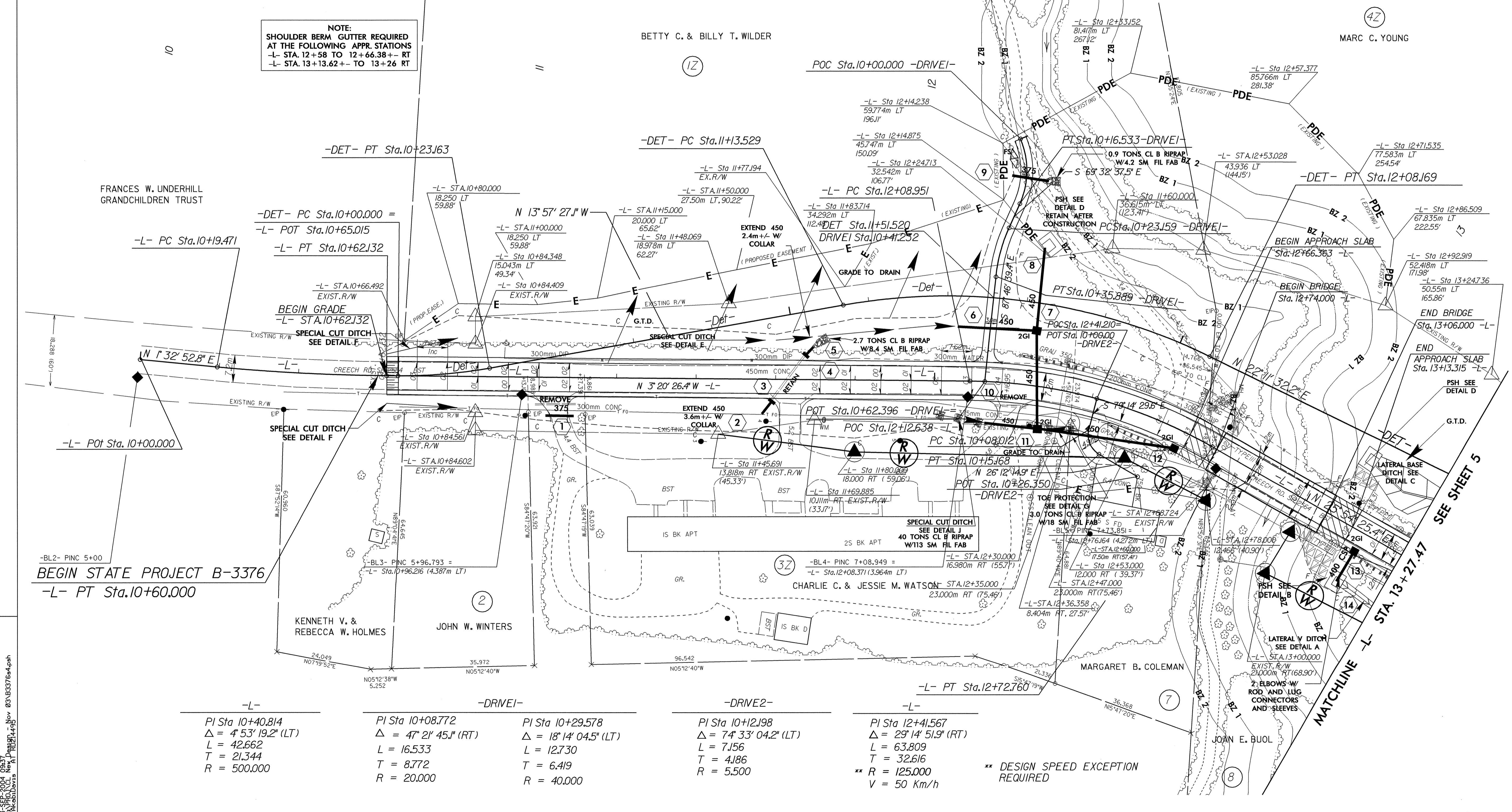
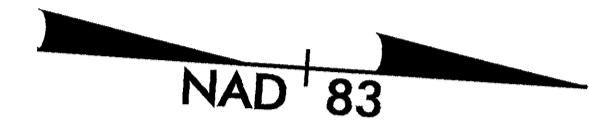

-L-	-DRIVE1-	-DRIVE2-	-L-
PI Sta 10+40.814	PI Sta 10+08.772	PI Sta 10+29.578	PI Sta 12+41.567
$\Delta = 4^{\circ} 53' 19.2" (LT)$	$\Delta = 47^{\circ} 21' 45.1" (RT)$	$\Delta = 18^{\circ} 14' 04.5" (LT)$	$\Delta = 29^{\circ} 14' 51.9" (RT)$
L = 42.662	L = 16.533	L = 12.730	L = 63.809
T = 21.344	T = 8.772	T = 6.419	T = 32.616
R = 500.000	R = 20.000	R = 40.000	R = 125.000
			** DESIGN SPEED EXCEPTION REQUIRED
			V = 50 Km/h

REVISIONS

3-SEP-04 09:27
 WAKABIDAVIS
 083\B3376s4f.wakabiDavis