

METRIC

CONST. REV.
R / W REV.

PROJECT REFERENCE NO. B-3376	SHEET NO. EC-8/CONST.6
R / W SHEET NO.	
ROADWAY DESIGN ENGINEER	HYDRAULICS ENGINEER

NOTE:
UTILIZE TEMPORARY ROCK SEDIMENT DAM TYPE - B AS STILLING BASIN WHERE APPLICABLE.

-DET-
 PI Sta 10+11.615 PI Sta 11+62.483
 $\Delta = 10' 37" 01.6" (LT)$ $\Delta = 36' 08" 59.6" (RT)$
 L = 23.163 L = 94.640
 T = 11.615 T = 48.955
 R = 125.000 R = 150.000

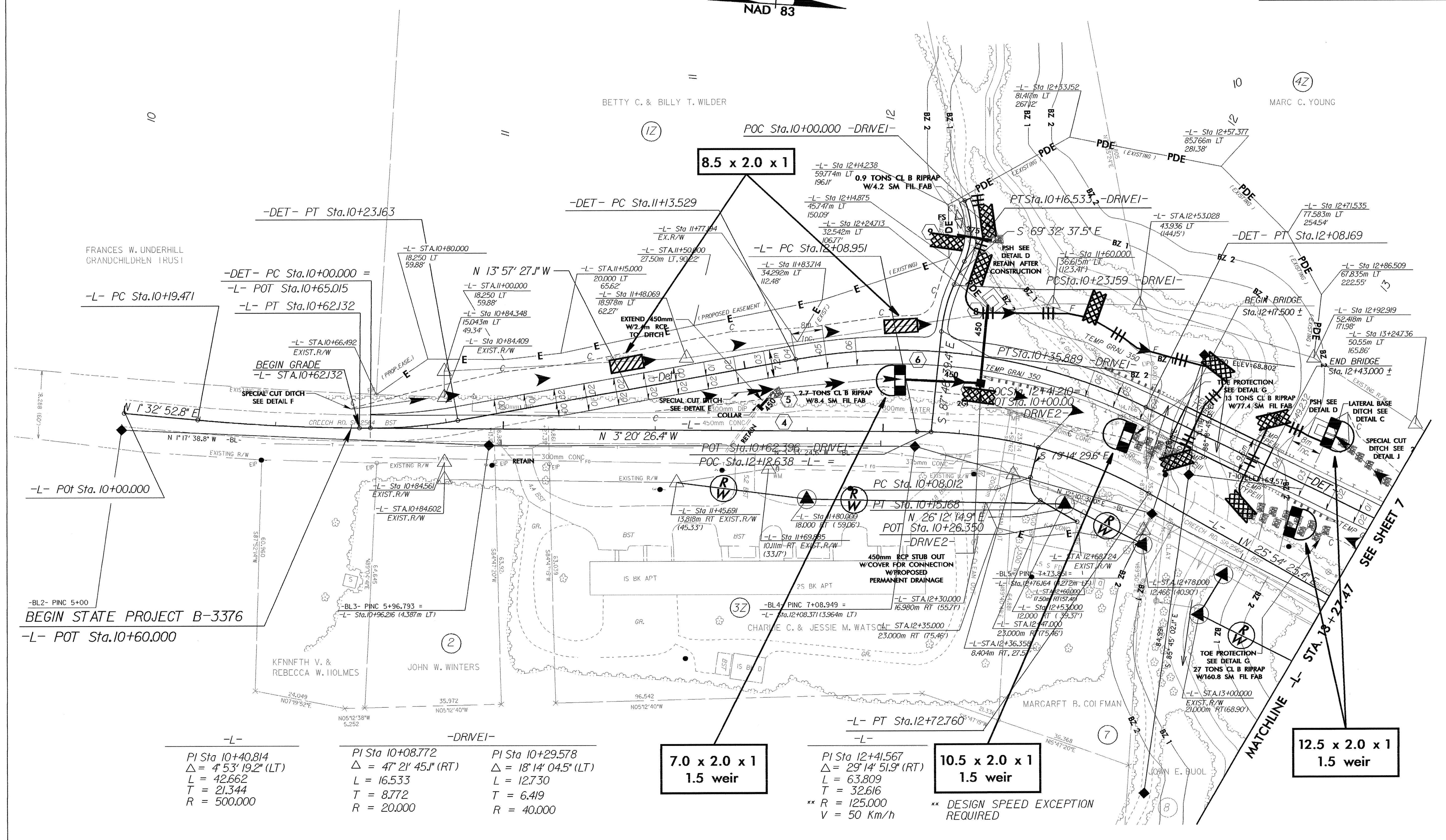
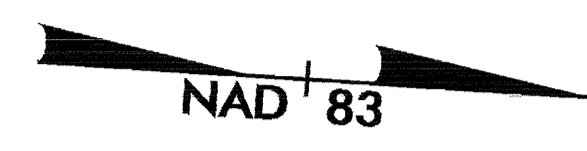

-BL2- PINC 5+00
BEGIN STATE PROJECT B-3376
 -L- POT Sta. 10+60.000

-L-
 PI Sta 10+40.814
 $\Delta = 4' 53" 19.2" (LT)$
 L = 42.662
 T = 21.344
 R = 500.000

-DRIVE1-
 PI Sta 10+08.772 PI Sta 10+29.578
 $\Delta = 47' 21" 45.1" (RT)$ $\Delta = 18' 14" 04.5" (LT)$
 L = 16.533 L = 12.730
 T = 8.772 T = 6.419
 R = 20.000 R = 40.000

7.0 x 2.0 x 1
 1.5 weir

10.5 x 2.0 x 1
 1.5 weir

-L-
 PI Sta 12+41.567 PI Sta 12+51.9 (RT)
 $\Delta = 29' 14" 51.9" (RT)$
 L = 63.809
 T = 32.616
 ** R = 125.000
 V = 50 Km/h

** DESIGN SPEED EXCEPTION REQUIRED

12.5 x 2.0 x 1
 1.5 weir

SEE SHEET 7

MATCHLINE -L- STA. 13+27.47