

CONTRACT: C201116 TIP PROJECT: R-2539C

STATE OF NORTH CAROLINA
DIVISION OF HIGHWAYS

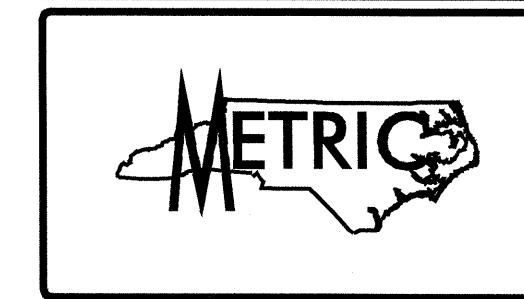

STATE	STATE PROJECT REFERENCE NO.	SHEET NO.	TOTAL SHEETS
N.C.	R-2539C		
STATE PROJ. NO.	F.A. PROJ. NO.	DESCRIPTION	
34452.1.1	STP-55(1)	P.E.	
34452.2.4	STP-55(31)	RW, UTIL.	
34452.3.7	STP-55(33)	CONSTR.	

PAMLICO COUNTY

**LOCATION: NC 55 FROM EAST OF SR 1129
TO NC 304 IN BAYBORO**

**TYPE OF WORK: GRADING, DRAINAGE, PAVING,
CURB & GUTTER, CULVERTS
SIGNALS, & SIGNING**

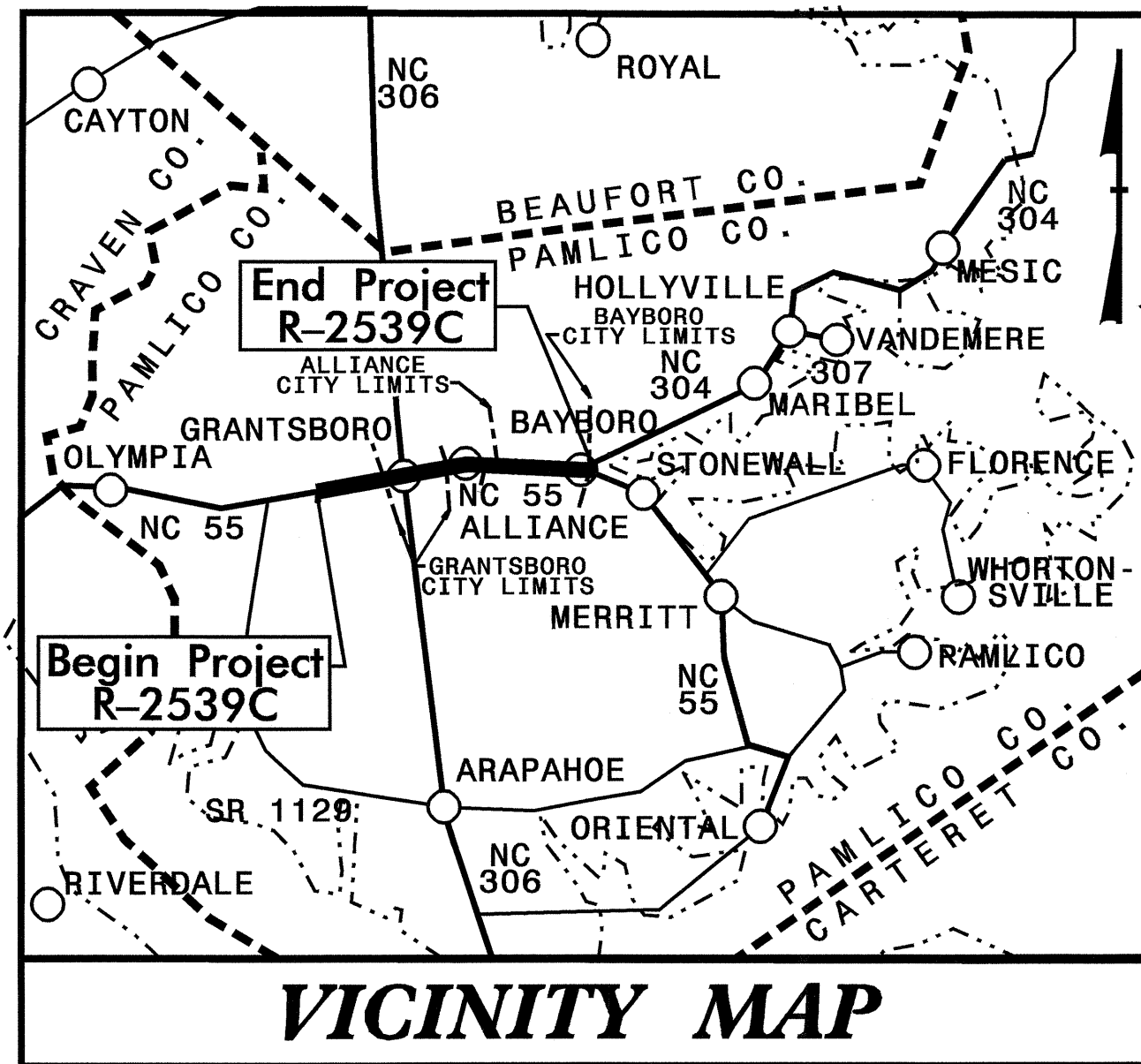

CULVERTS

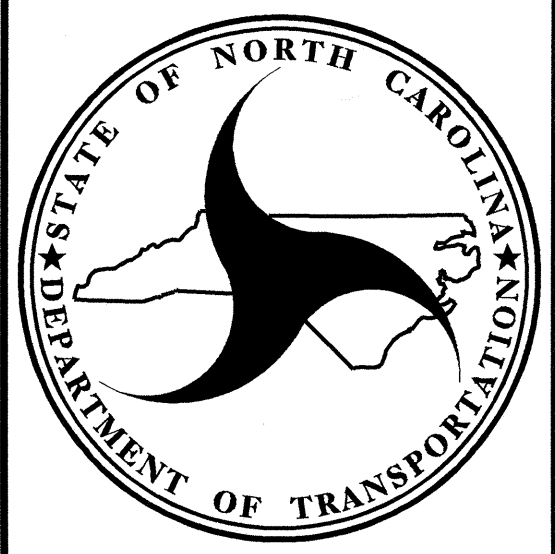
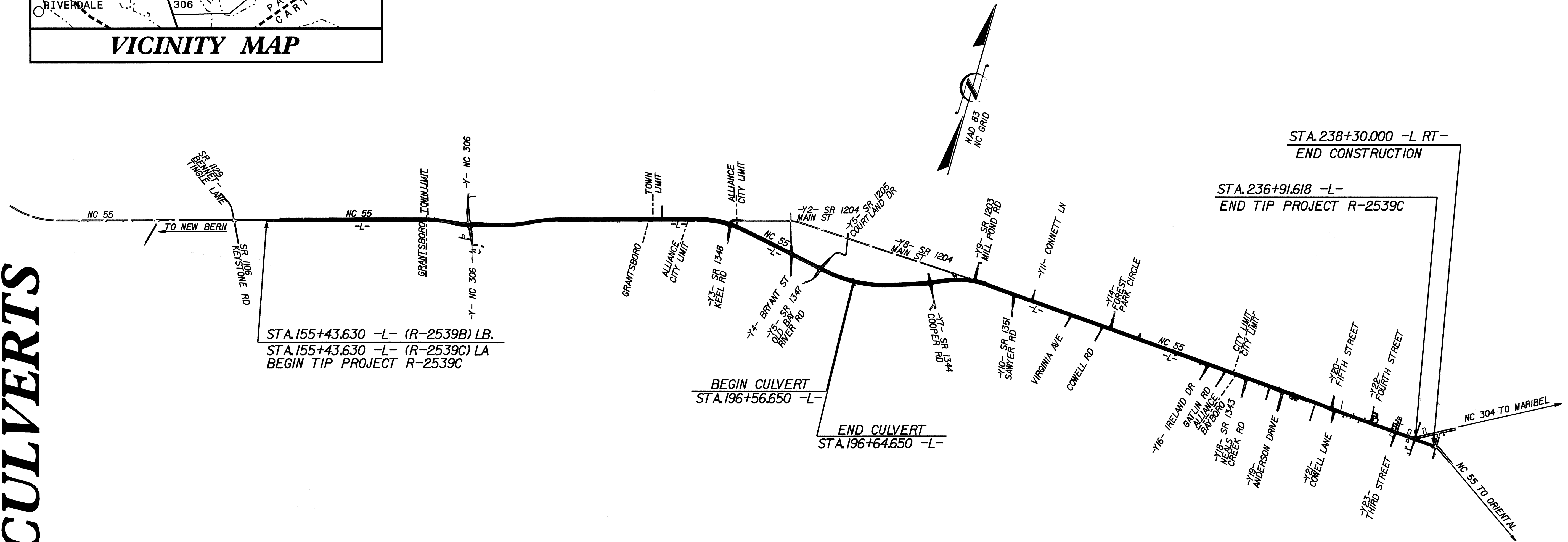

DESIGN DATA

ADT (2005) = 8,100-15,200
ADT (2025) = 12,800-24,100

DHV = 12%
D = 60% / 63%
T = 7% *

V = 100 km/h (SHOULDER SECTION)
V = 80 km/h (CURB & GUTTER SECTION)

* (TTST 2%+ DUAL 5%)

PROJECT LENGTH

LENGTH ROADWAY TIP PROJECT R-2539C = 8.140 Km
LENGTH STRUCTURE TIP PROJECT R-2539C = 0.008 Km
TOTAL LENGTH OF TIP PROJECT R-2539C = 8.148 Km

Prepared In the Office of:
DIVISION OF HIGHWAYS

2002 STANDARD SPECIFICATIONS

LETTING DATE:
FEBRUARY 15, 2005

JOHN C. FRYE, P.E.
PROJECT ENGINEER

BRIAN C. HANKS, P.E.
PROJECT DESIGN ENGINEER

STRUCTURE DESIGN UNIT
1000 BIRCH RIDGE DRIVE
RALEIGH, NC 27610

PROFESSIONAL SEAL
14552
ENGINEER
GREGORY R. PERETTI

Gregory R. Peretti
10.28.04

**DIVISION OF HIGHWAYS
STATE OF NORTH CAROLINA**

P.E.
STATE DESIGN ENGINEER

DEPARTMENT OF TRANSPORTATION
FEDERAL HIGHWAY ADMINISTRATION

APPROVED
DIVISION ADMINISTRATOR

DATE