

UTILITIES BY OTHERS

NOTE:
ALL PROPOSED UTILITY WORK
SHOWN ON THIS SHEET WILL
BE DONE BY OTHERS

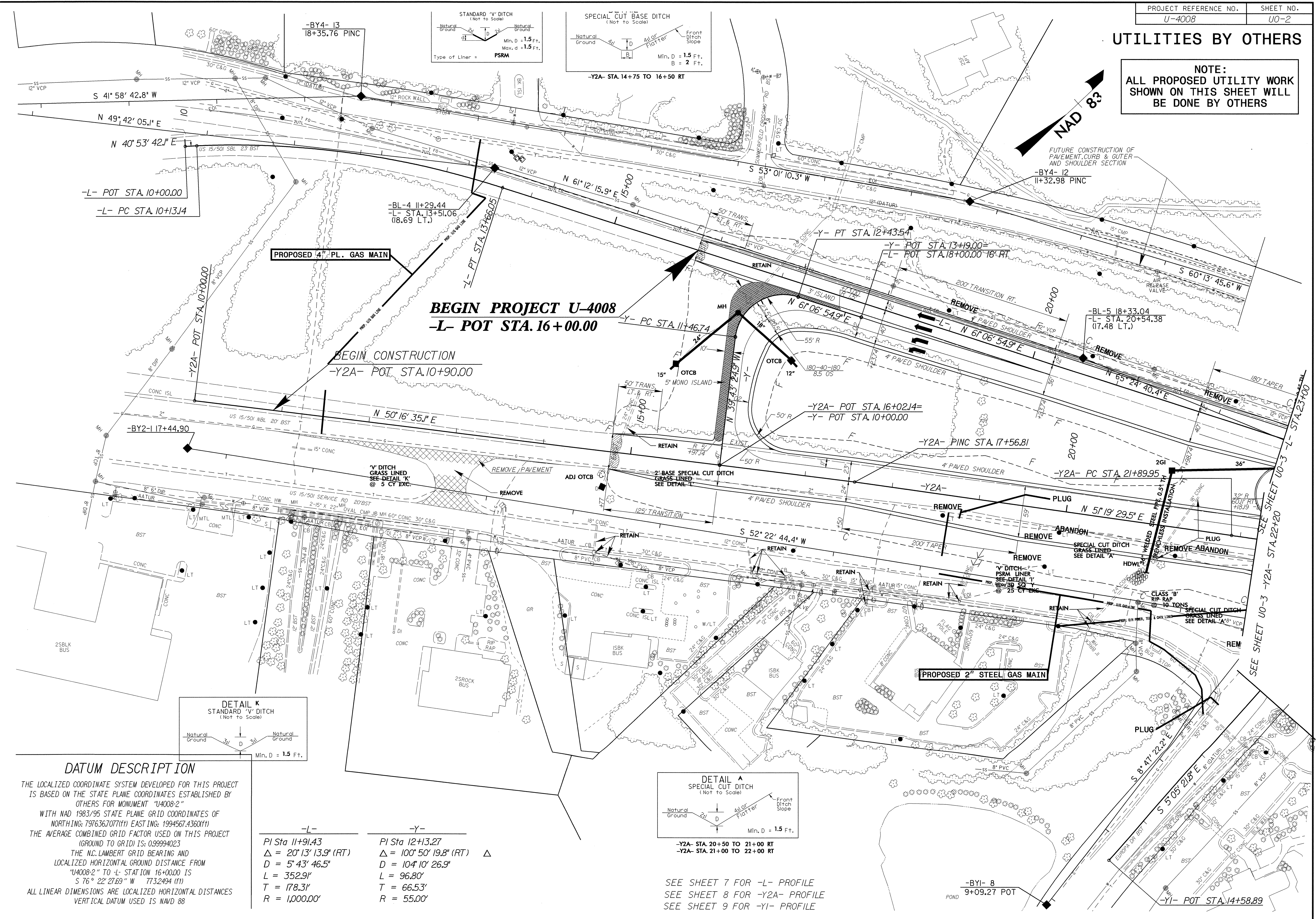

BEGIN PROJECT U-4008
-L- POT STA. 16+00.00

BEGIN CONSTRUCTION
-Y2A- POT STA. 10+90.00

DATUM DESCRIPTION

THE LOCALIZED COORDINATE SYSTEM DEVELOPED FOR THIS PROJECT IS BASED ON THE STATE PLANE COORDINATES ESTABLISHED BY OTHERS FOR MONUMENT "U4008-2"
WITH NAD 1983/95 STATE PLANE GRID COORDINATES OF NORTHING: 797636.7077(F1) EASTING: 1994567.4360(F1)
THE AVERAGE COMBINED GRID FACTOR USED ON THIS PROJECT (GROUND TO GRID) IS: 0.99994023
THE N.C. LAMBERT GRID BEARING AND LOCALIZED HORIZONTAL DISTANCE FROM "U4008-2" TO -L- STATION 16+00.00 IS
S 76° 22' 27.69" W 773.2494 (F1)
ALL LINEAR DIMENSIONS ARE LOCALIZED HORIZONTAL DISTANCES
VERTICAL DATUM USED IS NAVD 88

-L-	-Y-
PI Sta 11+91.43	PI Sta 12+13.27
Δ = 20° 13' 13.9" (RT)	Δ = 100° 50' 19.8" (RT)
D = 5' 43' 46.5"	D = 104' 10' 26.9"
L = 352.91'	L = 96.80'
T = 178.31'	T = 66.53'
R = 1,000.00'	R = 55.00'

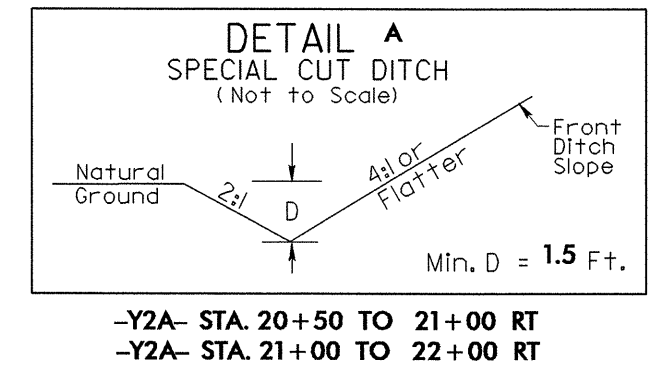

SEE SHEET 7 FOR -L- PROFILE
SEE SHEET 8 FOR -Y2A- PROFILE
SEE SHEET 9 FOR -Y1- PROFILE

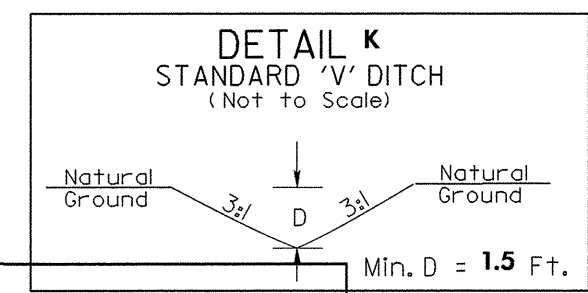

-BYI- 8
9+09.27 POT

8/17/99
09-SEP-2004 15:36
R:\Utilities\Proj\U4008-ut_s4_U02_pos.dgn
benburcuss AT 15214154