

SR 1734 ERWIN RD

BEGIN CONSTRUCTION
-Y3- STA. 18+50.00
TIE TO EXIST

-Y4A- STA 10+43+/-

SEE PM-4 FOR PAVEMENT
MARKINGS FOR
-Y3- (ERWIN RD)
AND WEST DOBBINS DR

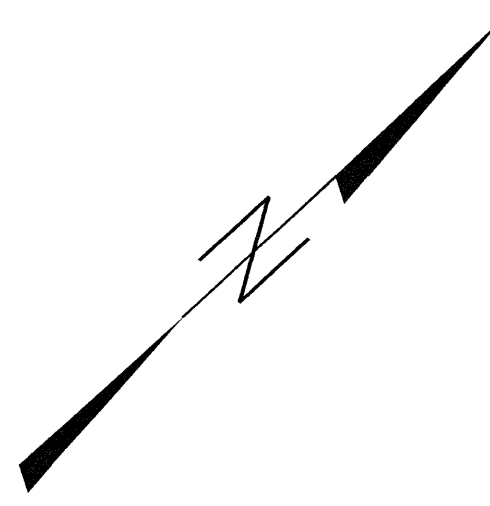

MATCHLINE SEE PM-2

* = PROPOSED TRAFFIC SIGNAL

END PROJECT U-4008
-L- POT STA. 36+70

END CONSTRUCTION
-Y4A- POT STA. 22+40.00
TIE TO EXIST

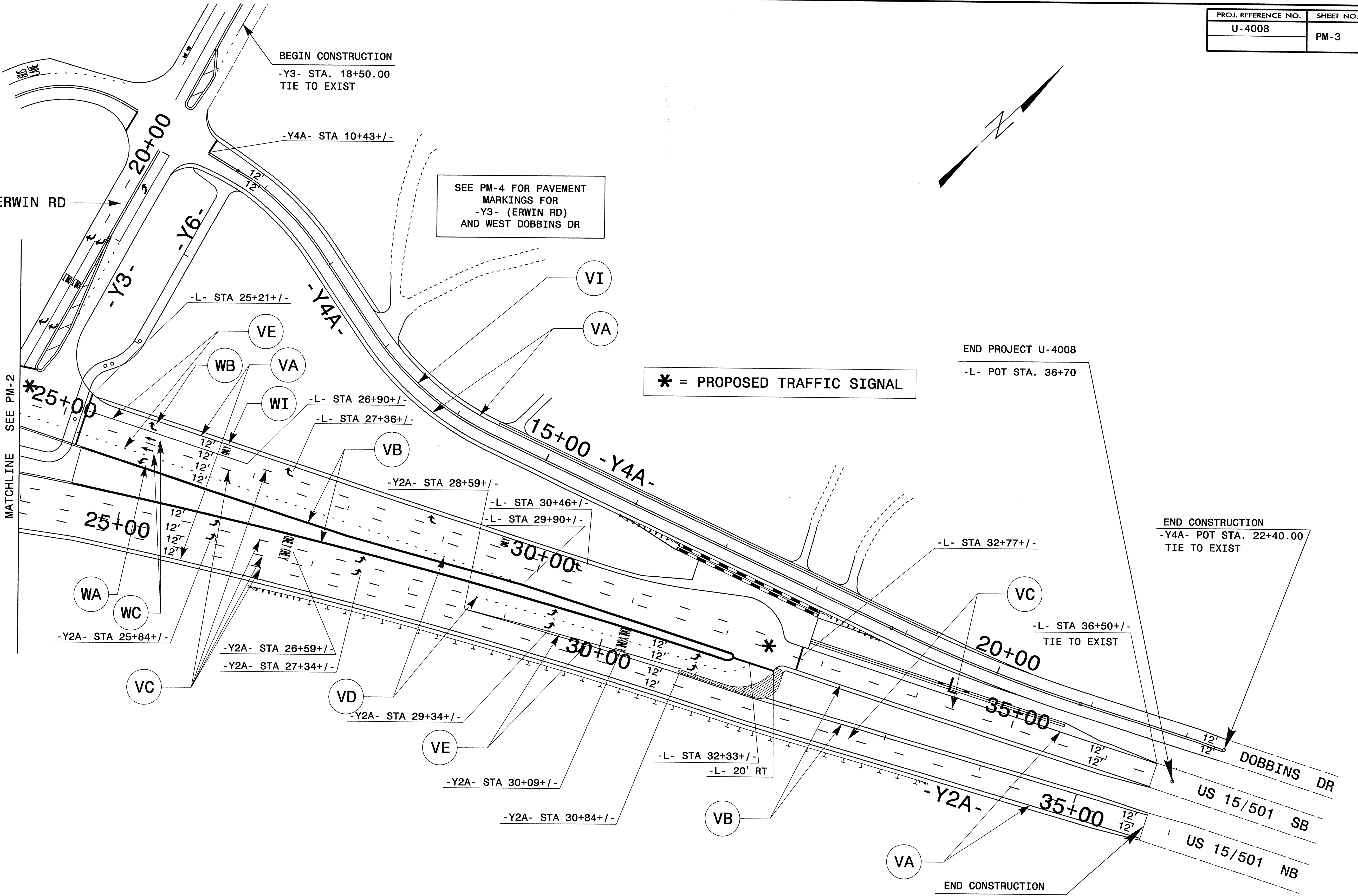

END CONSTRUCTION
-Y2A- POT STA. 35+74
TIE TO EXIST

APPROVED: *Joseph T. Shook* DATE: 9/9/04

SEAL

FINAL PAVEMENT MARKING PLANS

SCALE: NONE		REVISIONS
DATE: 2004		
DWG. BY: DER		
DESIGN BY: DER		
REVIEWED BY: MJH		

03-SEP-2004 14:01
c:\p1\03\04\008\1\CP\U4008-pm-pm03.dgn
DER\richardson AT TFC206432