

PROJECT REFERENCE NO.		SHEET NO.	
U-4008		EC-6/CONST.5	
RW SHEET NO.		HYDRAULICS ENGINEER	
ROADWAY DESIGN ENGINEER			

-Y4A-		
PI Sta 11+22.70	PI Sta 13+63.65	PI Sta 19+86.96
$\Delta = 25^\circ 30' 33.5''$ (RT)	$\Delta = 30^\circ 42' 07.3''$ (LT)	$\Delta = 7^\circ 47' 55.0''$ (LT)
$D = 19^\circ 05' 54.9''$	$D = 19^\circ 05' 54.9''$	$D = 3^\circ 49' 11.0''$
$L = 133.57'$	$L = 160.76'$	$L = 204.17'$
$T = 67.91'$	$T = 82.36'$	$T = 102.24'$
$R = 300.00'$	$R = 300.00'$	$R = 1500.00'$
SE = SEE PLANS	SE = SEE PLANS	SE = SEE PLANS

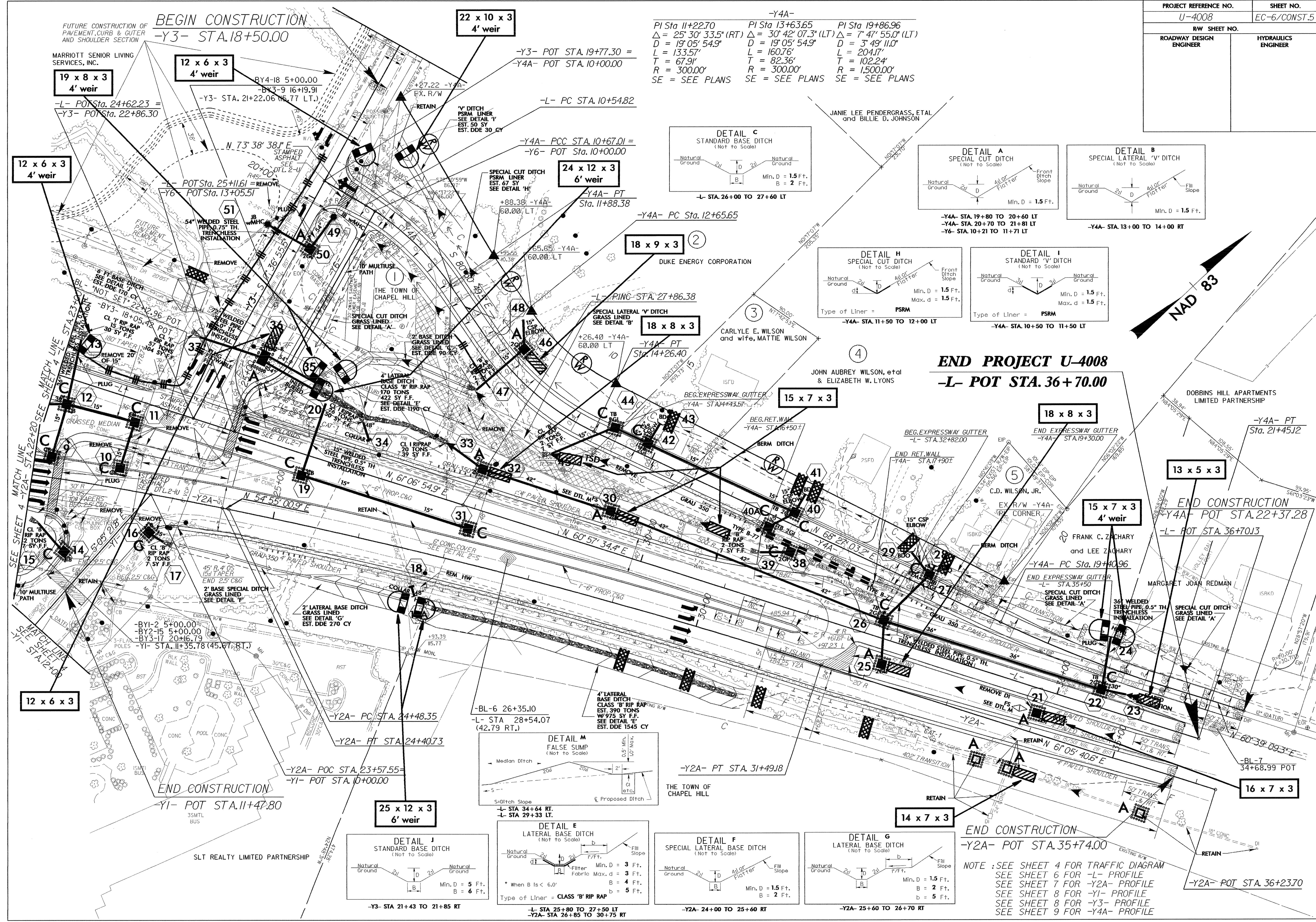

END PROJECT U-4008
-L- POT STA. 36+70.00

NOTE : SEE SHEET 4 FOR TRAFFIC DIAGRAM
 SEE SHEET 6 FOR -L- PROFILE
 SEE SHEET 7 FOR -Y2A- PROFILE
 SEE SHEET 8 FOR -Y1- PROFILE
 SEE SHEET 8 FOR -Y3- PROFILE
 SEE SHEET 9 FOR -Y4A- PROFILE