

PHASE I

- STEP 1: INSTALL ALL WORK ZONE ADVANCE WARNING SIGNS PRIOR TO ANY CONSTRUCTION ACTIVITY.
- STEP 2: USING LANE CLOSURE AND FLAGGERS AS DESCRIBED IN RSD 1101.02, SHEET 1 OF 7, CONSTRUCT PROPOSED -Y- LINE STA 11+00+/- TO 14+38+/-, PROPOSED DRIVEWAY (PEACE MTN RD) -DR- STA 10+15+/- TO STA 11+62+/- AND -L- STA 12+30+/- TO 13+86+/- UP TO BUT NOT INCLUDING FINAL LAYER OF SURFACE COURSE.
- STEP 3: USING LANE CLOSURES AND FLAGGERS AS DESCRIBED IN RSD 1101.02, SHEET 1 OF 7, INSTALL INTERIM PAVEMENT MARKINGS FROM -Y- STA 11+00+/- TO STA 14+38+/-.
- STEP 4: AT END OF DAY SHIFT TRAFFIC ONTO PROPOSED -Y- LINE & -DR- AND CLOSE EXISTING -Y- LINE & -DR- (SEE SHEET TCP-3, PHASE II DETAIL).

PHASE II

- STEP 1: REMOVE ADVANCED WARNING SIGNS AND USING RSD NO. 1101.03, SHEET 1 OF 9, PLACE DETOUR SIGNING (SEE SHEET TCP-4)
- STEP 2: CLOSE -L- (SR 1147) FROM STA 13+86+/- TO STA 17+20+/- AND SHIFT TRAFFIC ONTO THE OFF-SITE DETOUR.
- STEP 3: REMOVE PAVEMENT FROM OLD ALIGNMENT OF -Y- LINE AND -DR-. WHILE MAINTAINING LOCAL ACCESS, CONSTRUCT PROPOSED BRIDGE & -L- FROM STA 13+86+/- TO STA 17+10+/- UP TO BUT NOT INCLUDING FINAL LAYER OF THE SURFACE COURSE AND PLACE TEMPORARY PAVEMENT MARKINGS.
- STEP 4: SHIFT TRAFFIC ONTO THE PROPOSED PATTERN AND REMOVE OFF-SITE DETOUR SIGNS AND DEVICES.

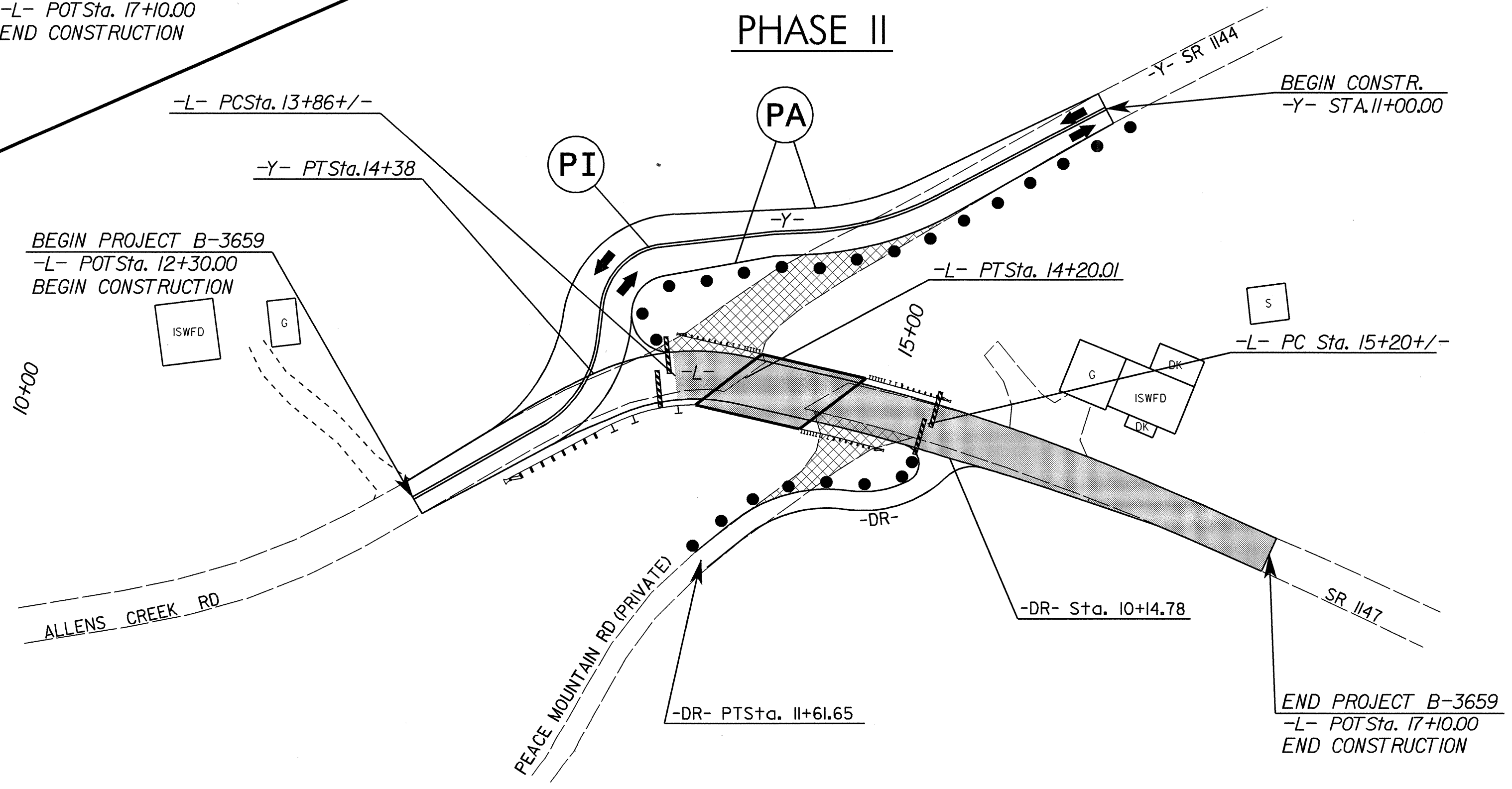

PHASE II

SEE SHEET TCP-1 FOR TEMPORARY PAVEMENT MARKING SCHEDULE

PHASE III

- STEP 1: USING LANE CLOSURE AND FLAGGERS AS DESCRIBED IN RSD 1101.02, SHEET 1 OF 7, INSTALL FINAL LAYER OF THE SURFACE COURSE, INSTALL FINAL PAVEMENT MARKINGS ON NEW PROPOSED -Y- AND -L- LINES.
- STEP 2: OPEN ROADWAY TO THE PROPOSED TRAFFIC PATTERN AND REMOVE ALL WORK ZONE SIGNS AND DEVICES.

APPROVED: *J.W. Wooland* DATE: 6-1-04

SEAL

PHASING

SCALE: NONE		REVISIONS
DATE: 2004 MAY 19		
DWG. BY: CSM		
DESIGN BY: CSM		
REVIEWED BY: JWW		

27-MAY-2004 07:28
 T:\TCP\B3659-TCP-3\PhaseI-3.dgn
 CSMozingo AT 11:10:51 AM