

PROJECT REFERENCE NO.	U-2913B	SHEET NO.	UC-14
DESIGNED BY:	DMP		
DRAWN BY:	DMP		
CHECKED BY:	DMP		
APPROVED BY:			
REVISOR:		NORTH CAROLINA DEPARTMENT OF TRANSPORTATION PROJECT SERVICES UNIT PHONE: (919) 250-4128 FAX: (919) 250-4119	
UTILITY CONSTRUCTION			UTILITY CONSTRUCTION PLANS ONLY

**PROP. - 3 - BREAK DOWN & FILL ABANDONED SEPTIC TANKS
3 - SANITARY SEWER CLEANOUTS
43 M OF 100 MM SEWER PIPE, SCH 40 PVC
CONNECT USING NECESSARY FITTINGS**

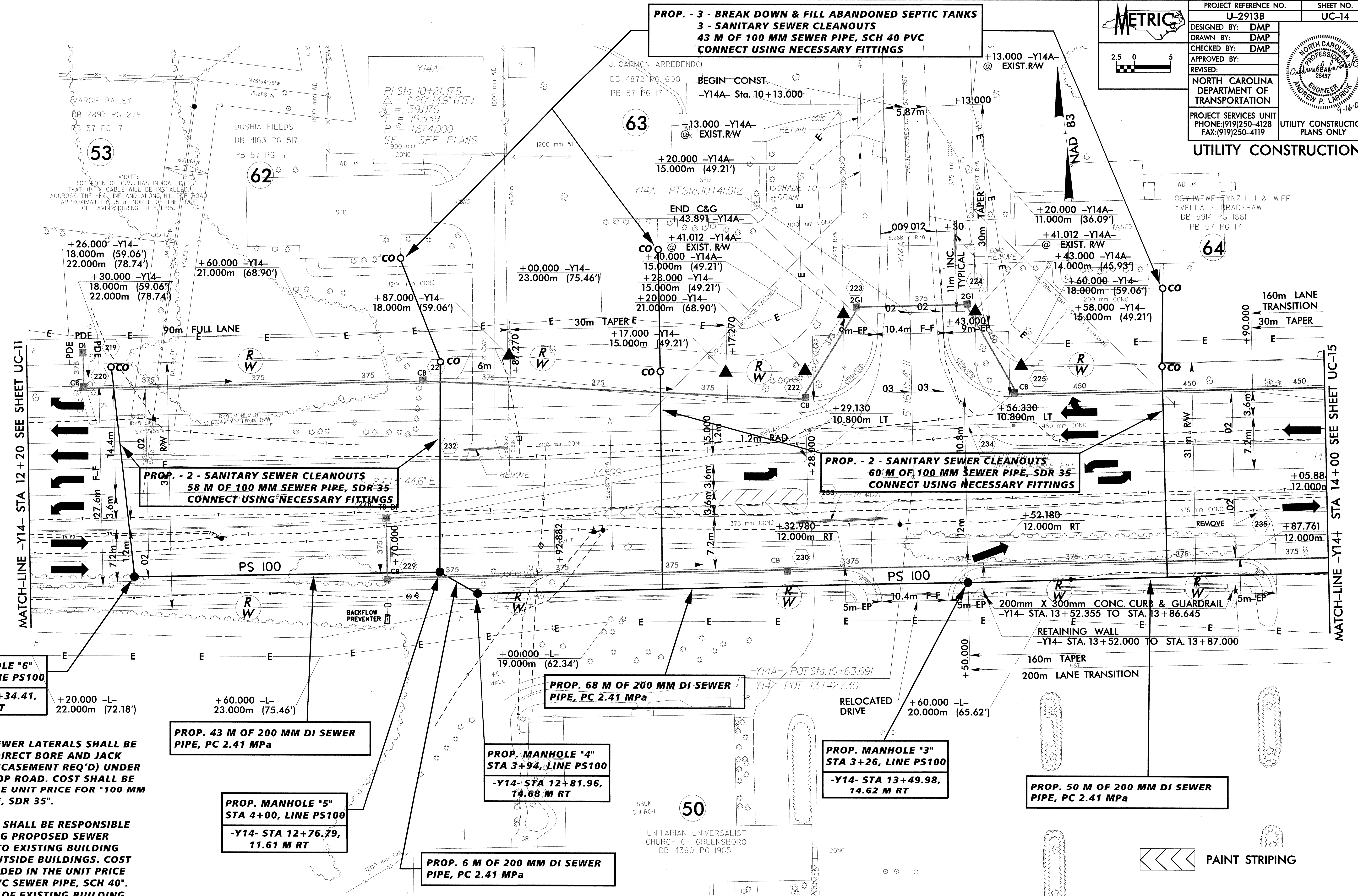

MATCH-LINE -Y14- STA 12+20 SEE SHEET UC-11

MATCH-LINE -Y14+ STA 14+00 SEE SHEET UC-15

**PROP. - 2 - SANITARY SEWER CLEANOUTS
58 M OF 100 MM SEWER PIPE, SDR 35
CONNECT USING NECESSARY FITTINGS**

**PROP. - 2 - SANITARY SEWER CLEANOUTS
60 M OF 100 MM SEWER PIPE, SDR 35
CONNECT USING NECESSARY FITTINGS**

**PROP. MANHOLE "6"
STA 4+43, LINE PS100
-Y14- STA 12+34.41,
11.37 M RT**

**PROP. 43 M OF 200 MM DI SEWER
PIPE, PC 2.41 MPa**

**PROP. 68 M OF 200 MM DI SEWER
PIPE, PC 2.41 MPa**

**PROP. MANHOLE "4"
STA 3+94, LINE PS100
-Y14- STA 12+81.96,
14.68 M RT**

**PROP. MANHOLE "3"
STA 3+26, LINE PS100
-Y14- STA 13+49.98,
14.62 M RT**

**PROP. MANHOLE "5"
STA 4+00, LINE PS100
-Y14- STA 12+76.79,
11.61 M RT**

**PROP. 6 M OF 200 MM DI SEWER
PIPE, PC 2.41 MPa**

**PROP. 50 M OF 200 MM DI SEWER
PIPE, PC 2.41 MPa**

- NOTES:**
- 1) PROPOSED SEWER LATERALS SHALL BE INSTALLED BY DIRECT BORE AND JACK METHOD (NO ENCASMENT REQ'D) UNDER EXISTING HILLTOP ROAD. COST SHALL BE INCLUDED IN THE UNIT PRICE FOR "100 MM PVC SEWER PIPE, SDR 35".
 - 2) CONTRACTOR SHALL BE RESPONSIBLE FOR CONNECTING PROPOSED SEWER SERVICE LINES TO EXISTING BUILDING SEWER LINES OUTSIDE BUILDINGS. COST SHALL BE INCLUDED IN THE UNIT PRICE FOR "100 MM PVC SEWER PIPE, SCH 40". THE LOCATIONS OF EXISTING BUILDING SEWER LINES SHOWN ON THESE PLANS ARE APPROXIMATE AND SHALL BE VERIFIED BY THE CONTRACTOR.

