

NOTE:
 ALL PROPOSED UTILITY WORK
 SHOWN ON THIS SHEET WILL
 BE DONE BY OTHERS

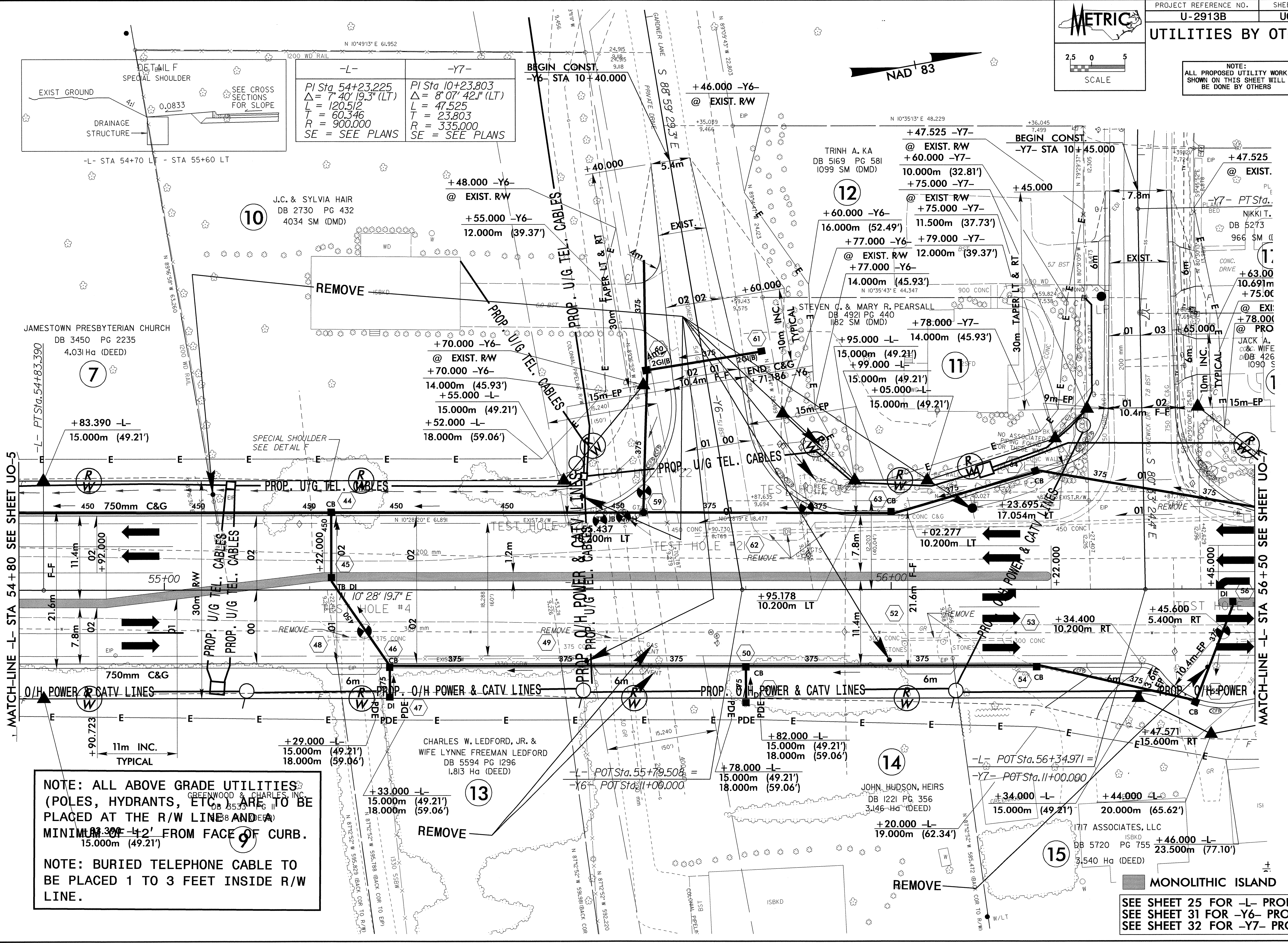

-L-	-Y7-
PI Sta. 54+23.225	PI Sta. 10+23.803
$\Delta = 7^{\circ} 40' 19.3''$ (LT)	$\Delta = 8^{\circ} 07' 42.1''$ (LT)
L = 120.512	L = 47.525
T = 60.346	T = 23.803
R = 900.000	R = 335.000
SE = SEE PLANS	SE = SEE PLANS

NOTE: ALL ABOVE GRADE UTILITIES (POLES, HYDRANTS, ETC.) ARE TO BE PLACED AT THE R/W LINE AND A MINIMUM OF 4' FROM FACE OF CURB.

NOTE: BURIED TELEPHONE CABLE TO BE PLACED 1 TO 3 FEET INSIDE R/W LINE.

SEE SHEET 25 FOR -L- PROFILE
 SEE SHEET 31 FOR -Y6- PROFILE
 SEE SHEET 32 FOR -Y7- PROFILE

07-OCT-2004 13:53 N:\u2913bs\U06.psh