

SURVEY CONTROL SHEET B-3205

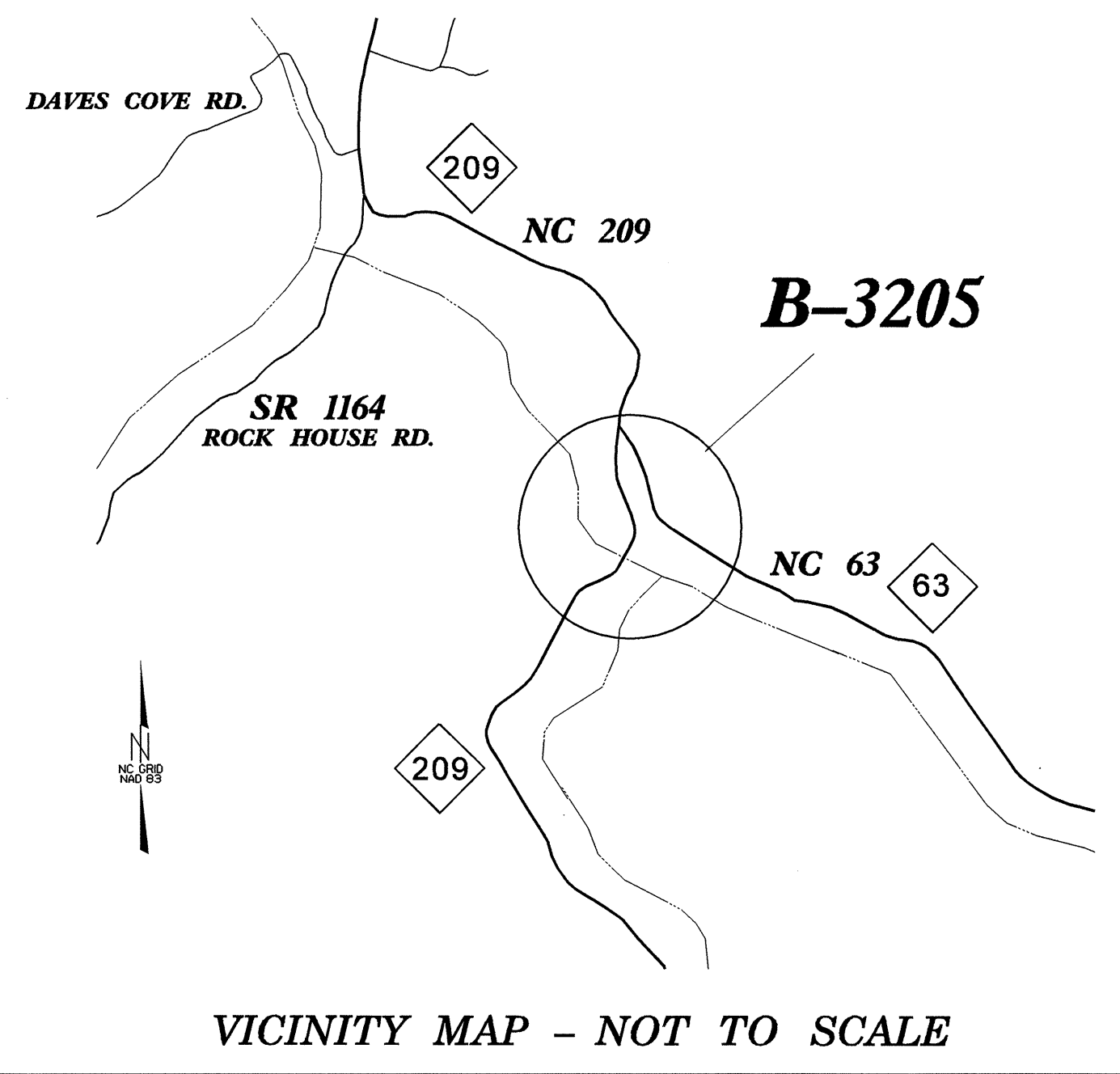

DATUM DESCRIPTION

THE LOCALIZED COORDINATE SYSTEM DEVELOPED FOR THIS PROJECT IS BASED ON THE STATE PLANE COORDINATES ESTABLISHED BY NCDOT FOR MONUMENT "B3205-3"

WITH NAD 83 STATE PLANE GRID COORDINATES OF
 NORTHING: 751093.8587(ft) EASTING: 852042.1082(ft)

THE AVERAGE COMBINED GRID FACTOR USED ON THIS PROJECT
 (GROUND TO GRID) IS: 0.999818129

THE N.C. LAMBERT GRID BEARING AND
 LOCALIZED HORIZONTAL GROUND DISTANCE FROM
 "B3205-3" TO -L- STATION 10+00.00 IS
 S 9°55'30.8" E 339.03'

ALL LINEAR DIMENSIONS ARE LOCALIZED HORIZONTAL DISTANCES
 VERTICAL DATUM USED IS NGVD 29

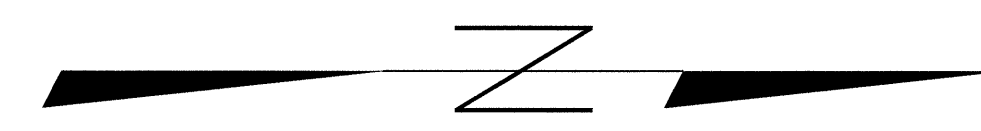

-L- STA. 10+00.00 BEGIN STATE PROJECT B-3205
LOCALIZED PROJECT COORDINATES
 N = 750759.9050
 E = 852100.5440

NCDOT GPS STATION "B3205-3"
LOCALIZED PROJECT COORDINATES
 N = 751093.8588
 E = 852042.1083

-L- STA. 20+10.41 END STATE PROJECT B-3205
LOCALIZED PROJECT COORDINATES
 N = 751724.4157
 E = 852186.2907

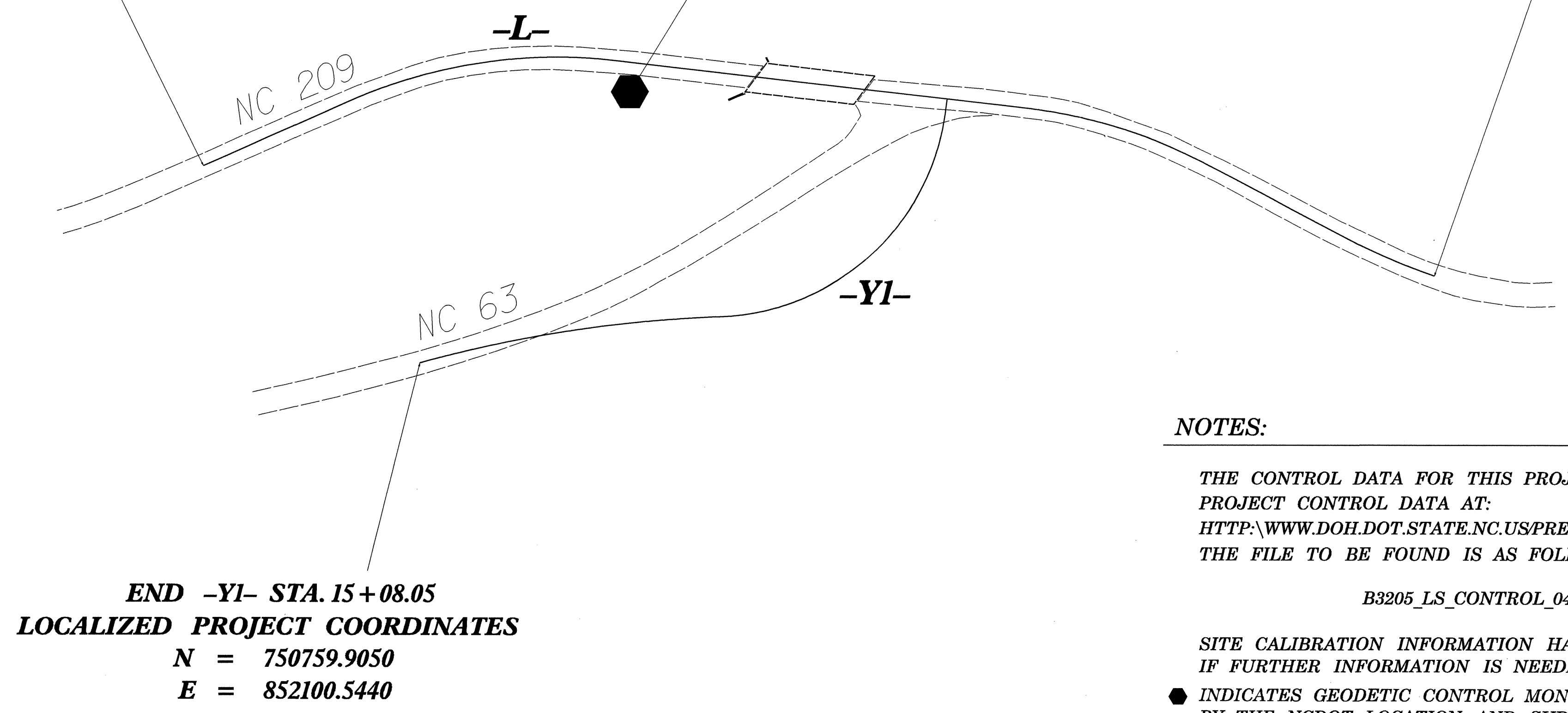

NOTES:

THE CONTROL DATA FOR THIS PROJECT CAN BE FOUND ELECTRONICALLY BY SELECTING PROJECT CONTROL DATA AT:
[HTTP://WWW.DOH.DOT.STATE.NC.US/PRECONSTRUCT/HIGHWAY/LOCATION/PROJECT](http://www.doh.dot.state.nc.us/preconstruct/highway/location/project)
 THE FILE TO BE FOUND IS AS FOLLOWS:
 B3205_LS_CONTROL_040428.TXT

SITE CALIBRATION INFORMATION HAS NOT BEEN PROVIDED FOR THIS PROJECT.
 IF FURTHER INFORMATION IS NEEDED, PLEASE CONTACT THE LOCATION AND SURVEYS UNIT.

● INDICATES GEODETIC CONTROL MONUMENTS USED OR SET FOR HORIZONTAL PROJECT CONTROL BY THE NCDOT LOCATION AND SURVEYS UNIT.
 PROJECT CONTROL ESTABLISHED USING GLOBAL POSITIONING SYSTEM.

NOTE: DRAWING NOT TO SCALE