

CONTRACT: C201255 TIP PROJECT: B-3805

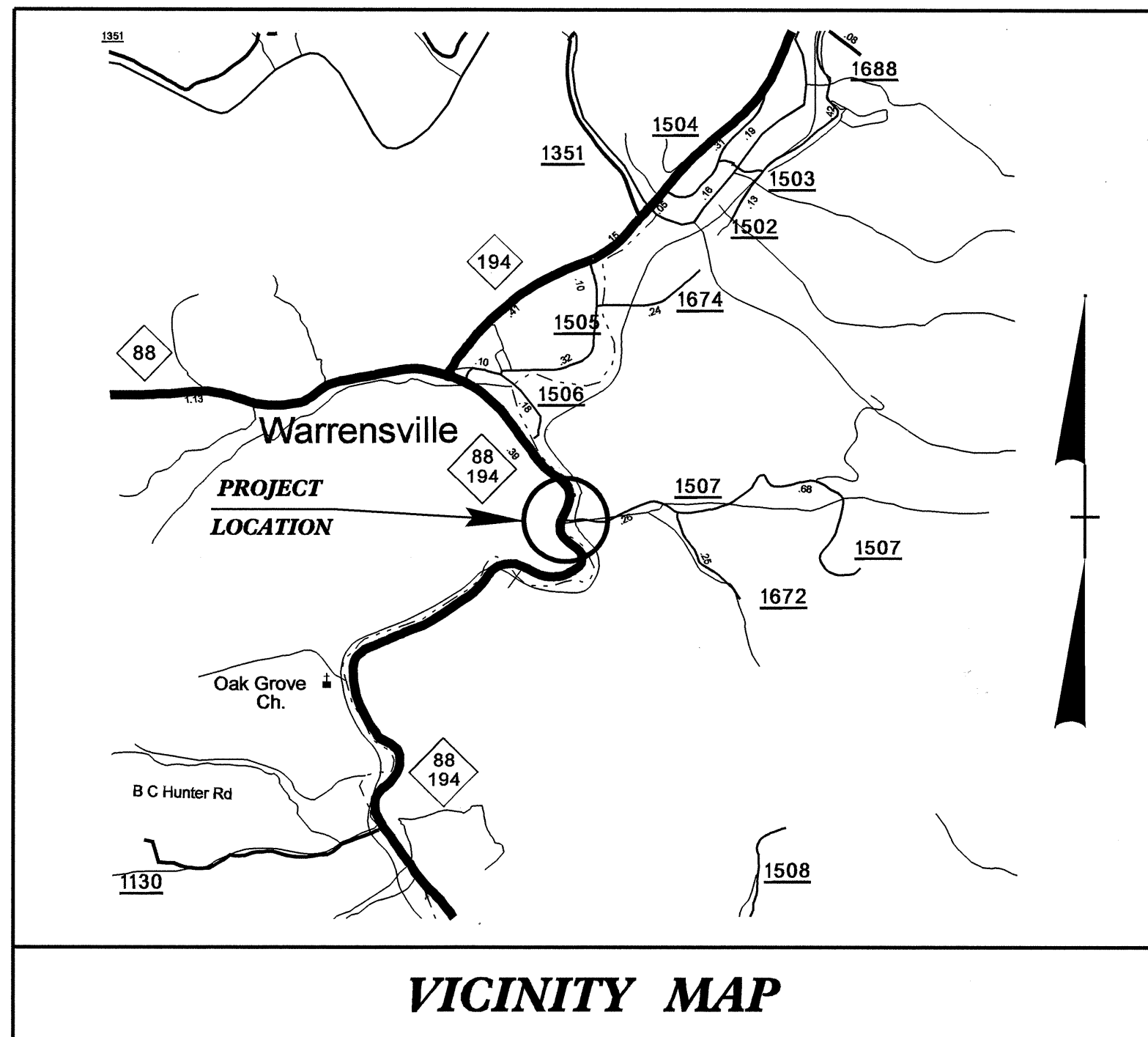

NEAREST SHIPPING POINT: WILKSBORO ON SOUTHERN RR
42 MILES FROM PROJECT

STRUCTURE

STATE OF NORTH CAROLINA DIVISION OF HIGHWAYS

ASHE COUNTY

LOCATION: BRIDGE NO. 310 OVER BUFFALO CREEK ON SR 1507

TYPE OF WORK: GRADING, DRAINAGE, PAVING AND STRUCTURE

STATE	STATE PROJECT REFERENCE NO.	SHEET NO.	TOTAL SHEETS
N.C.	B-3805		
STATE PROJ. NO.	F.A. PROJ. NO.	DESCRIPTION	
33261.1.1	BRZ-1507(2)	PE	
33261.2.2	BRZ-1507(2)	RW, UTIL.	
33261.3.1	BRZ-1507(2)	CONST.	

STA 10+12.11 -L- BEGIN TIP PROJECT B-3805

BEGIN BRIDGE
-L- STA 10+25.00

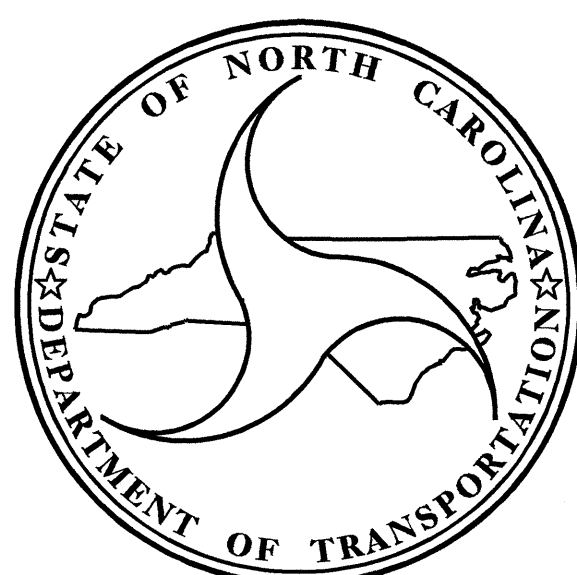
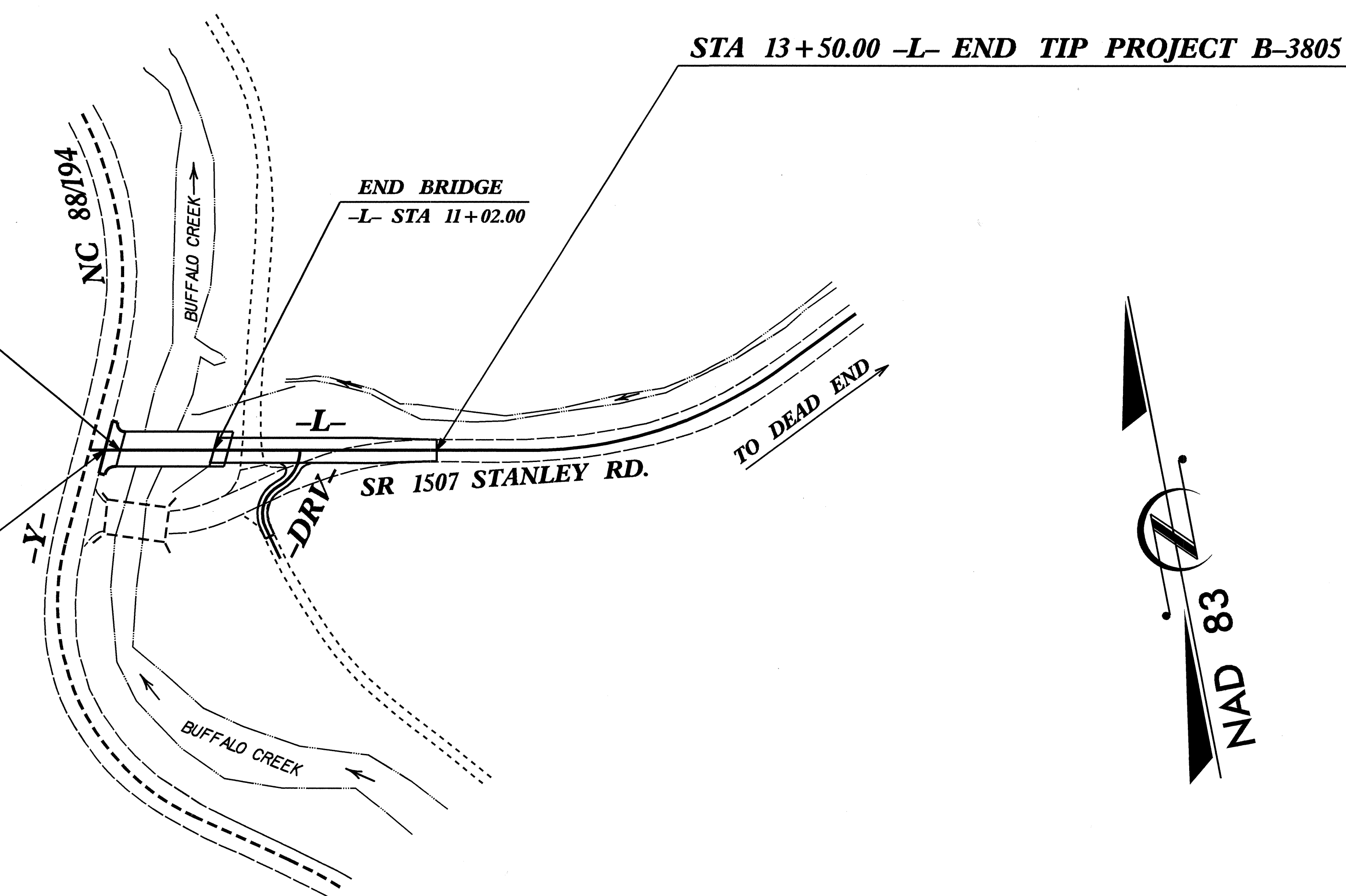

DESIGN DATA

ADT 2005 = 217
 ADT 2025 = 300
 DHV = 15 %
 D = 60 %
 T = 6 % *
 ** V = 60 MPH
 FUNC. CLASS = RURAL LOCAL
 * TTST 1% + DUAL 5%

PROJECT LENGTH

LENGTH ROADWAY TIP PROJECT B-3805 = 0.049 MI
 LENGTH STRUCTURE TIP PROJECT B-3805 = 0.015 MI
 TOTAL LENGTH OF TIP PROJECT B-3805 = 0.064 MI

Prepared In the Office of:
DIVISION OF HIGHWAYS
 1000 BIRCH RIDGE DR. RALEIGH, NC 27610

2002 STANDARD SPECIFICATIONS

LETTING DATE:
 DECEMBER 20, 2005

N. N. BULLOCK, PE
 PROJECT ENGINEER

D. R. CALHOUN, PE
 PROJECT DESIGN ENGINEER

STRUCTURE DESIGN UNIT

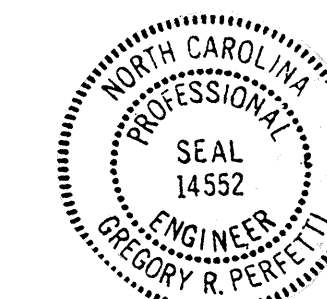

Gregory R. Perfecti
 11.7.05

DIVISION OF HIGHWAYS
 STATE OF NORTH CAROLINA

PE
 STATE DESIGN ENGINEER
 DEPARTMENT OF TRANSPORTATION
 FEDERAL HIGHWAY ADMINISTRATION

APPROVED
 DIVISION ADMINISTRATOR DATE