

**HORIZONTAL CURVE DATA -L-**

P.I. = 24+39.90  
 DELTA = 47°-47'-42.9" (LT)  
 D = 3°-40'-22.1"  
 T = 691.220'  
 L = 1301.330'  
 R = 1560.000'  
 SLOPE = 0.060 ft./ft.

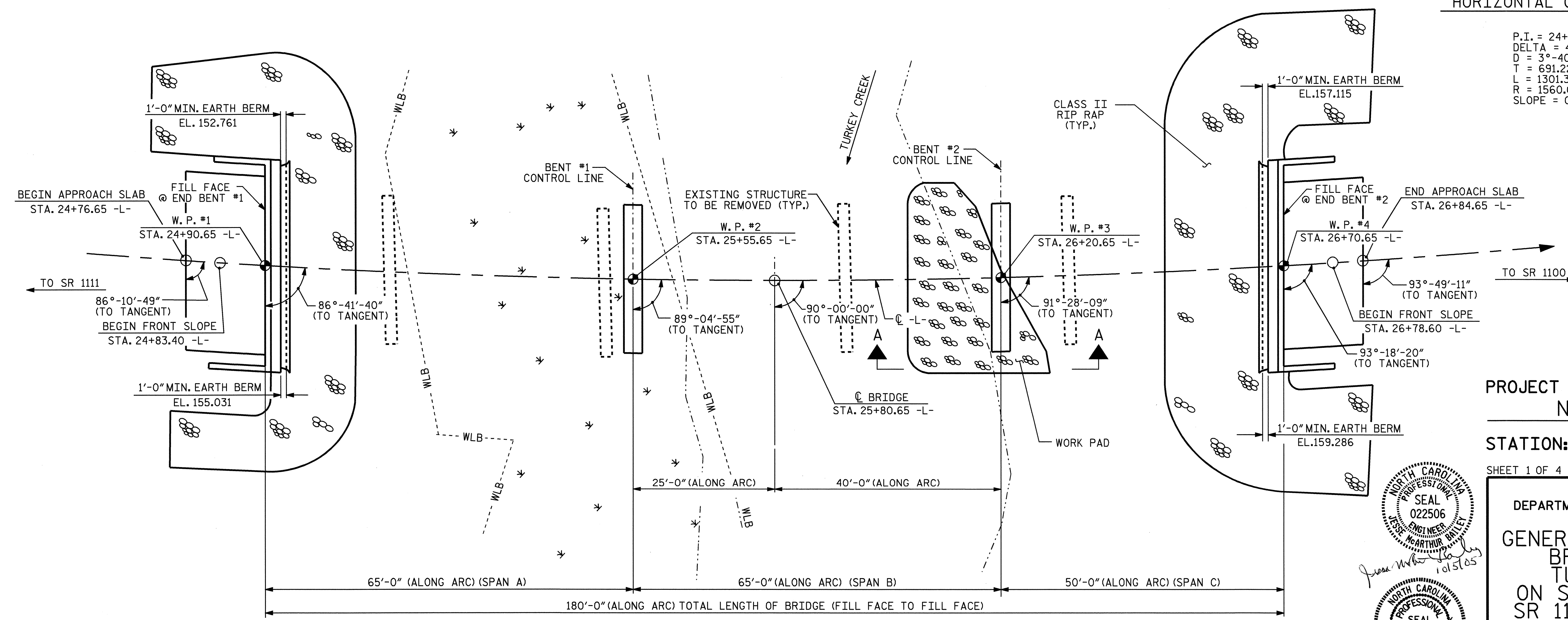

PROJECT NO. B-3877  
 NASH COUNTY  
 STATION: 25+80.65 -L-

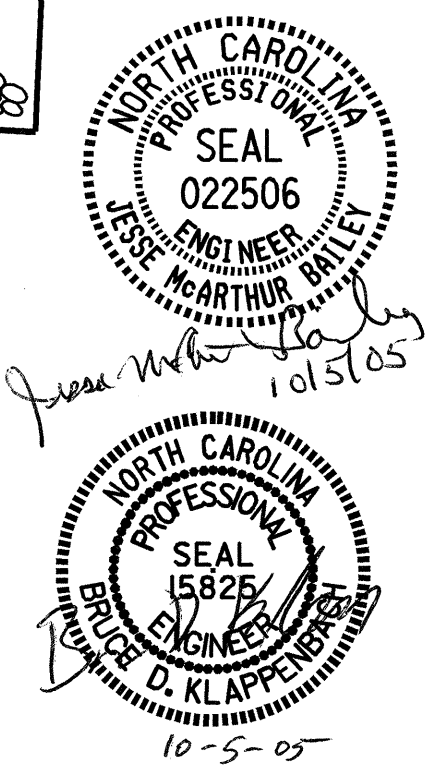

SHEET 1 OF 4 REPLACES BRIDGE NO. 52

STATE OF NORTH CAROLINA  
 DEPARTMENT OF TRANSPORTATION  
 RALEIGH

GENERAL DRAWING FOR  
 BRIDGE OVER  
 TURKEY CREEK  
 ON SR 1101 BETWEEN  
 SR 1100 AND SR 1111

REVISIONS						SHEET NO.
NO.	BY:	DATE:	NO.	BY:	DATE:	S-1
1			3			TOTAL SHEETS
2			4			33

DRAWN BY: M. G. SHAIKH DATE: 08/18/04  
 CHECKED BY: B. D. KLAPPENBACH DATE: 07/18/05