

SURVEY CONTROL SHEET B-4222

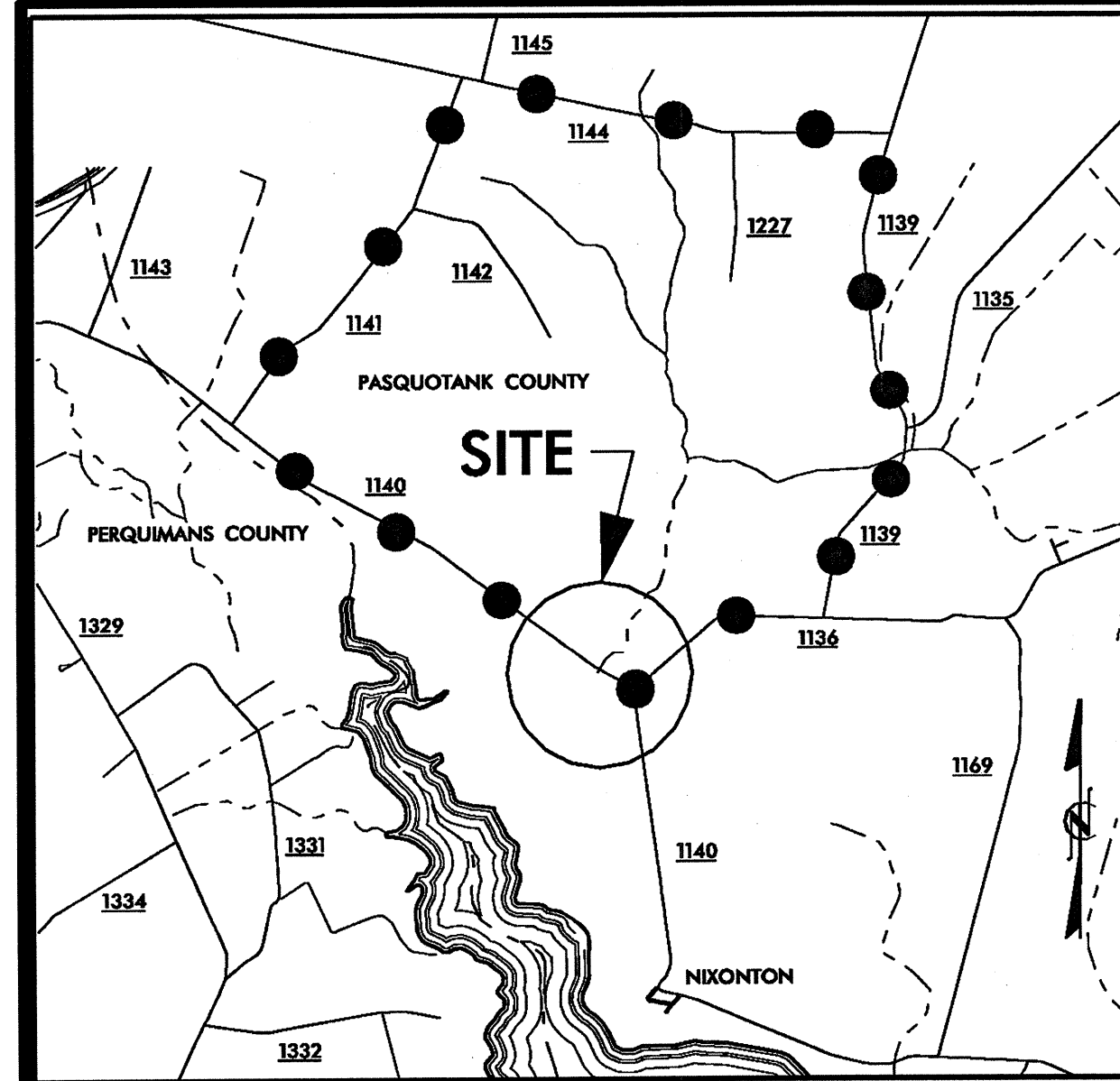

VICINITY MAP

BLN POINT	DESC.	NORTH	EAST	ELEVATION	L STATION	OFFSET
1	(GPS B4222-1)	911313.3630	2801684.9590	5.27	OUTSIDE PROJECT LIMITS	
2	(GPS B4222-2)	910586.3680	2802663.6730	3.26	OUTSIDE PROJECT LIMITS	
3	(BL-3)	910175.0510	2803170.6040	3.22	OUTSIDE PROJECT LIMITS	
4	(BL-4)	909970.4470	2803485.9220	2.80	11+70.46	15.85 RT
5	(BL-5)	909855.5930	2803708.1650	3.18	OUTSIDE PROJECT LIMITS	

.....
 BM10 ELEVATION = 3.65
 N 909891 E 2803586
 L STATION 12+96 37 RIGHT
 R/R SPIKE IN BASE OF POWER POLE

.....
 BM11 ELEVATION = 3.34
 N 910221 E 2803175
 OUTSIDE PROJECT LIMITS
 R/R SPIKE IN BASE OF 18' MAPLE

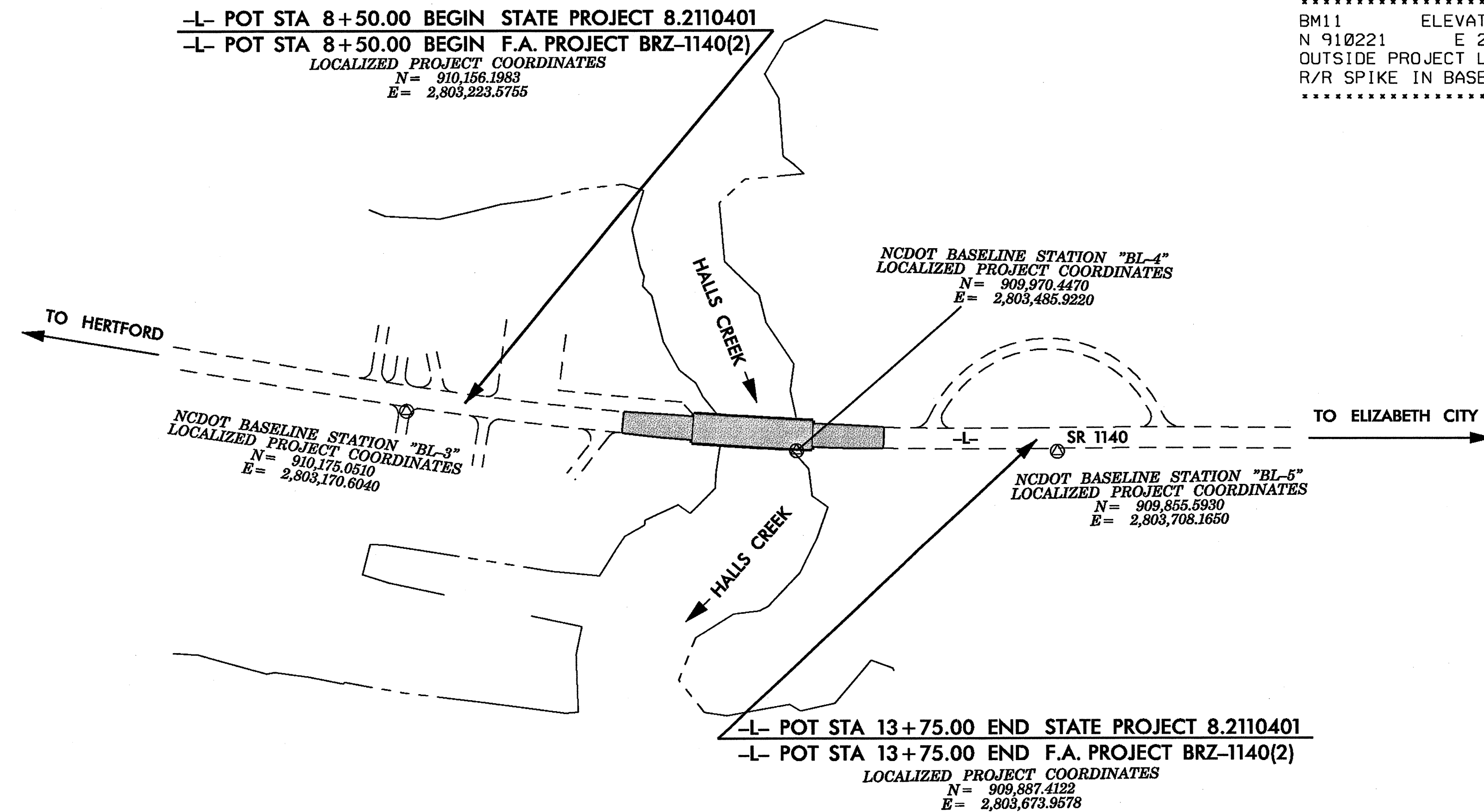
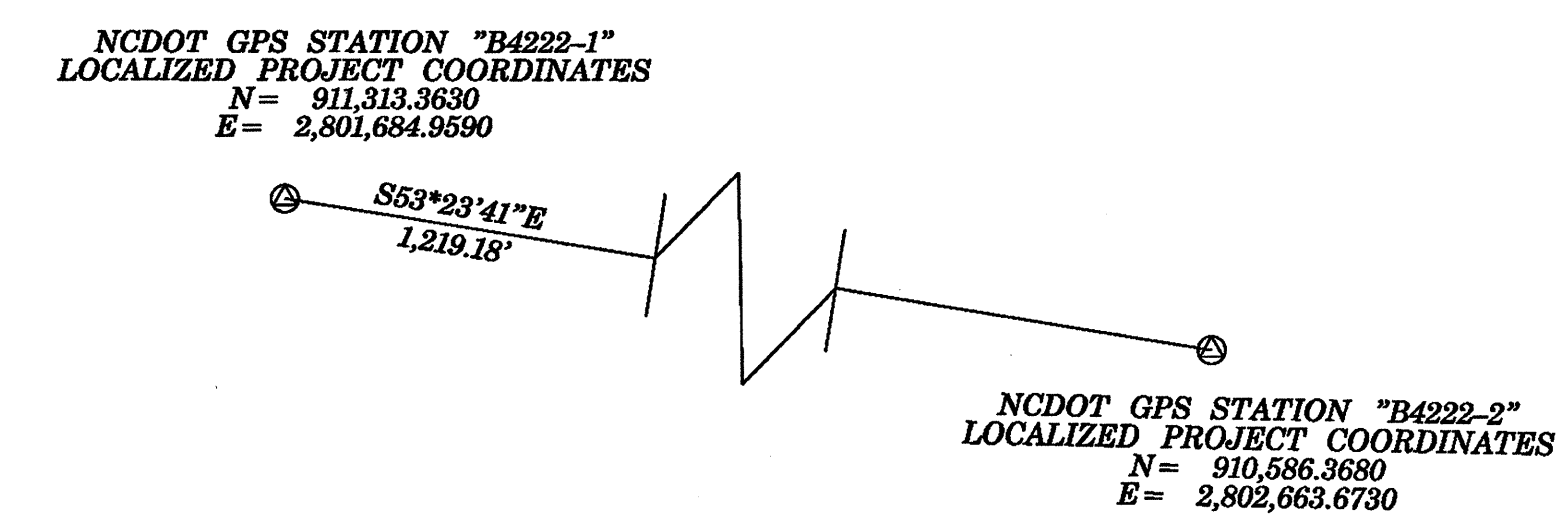

DATUM DESCRIPTION

THE LOCALIZED COORDINATE SYSTEM DEVELOPED FOR THIS PROJECT IS BASED ON THE STATE PLANE COORDINATES ESTABLISHED BY NCDOT FOR MONUMENT "B4222-2"

WITH NAD 1983/95 STATE PLANE GRID COORDINATES OF
 NORTHING: 910586.368(ft) EASTING: 2802663.673(ft)

THE AVERAGE COMBINED GRID FACTOR USED ON THIS PROJECT (GROUND TO GRID) IS: 1.00002093

THE N.C. LAMBERT GRID BEARING AND LOCALIZED HORIZONTAL GROUND DISTANCE FROM "B4222-2" TO -L- STATION 8+50.00 IS
 S 52°27'55" E 706.071

ALL LINEAR DIMENSIONS ARE LOCALIZED HORIZONTAL DISTANCES
 VERTICAL DATUM USED IS NAVD 88

NOTES:

- THE CONTROL DATA FOR THIS PROJECT CAN BE FOUND ELECTRONICALLY BY SELECTING
[HTTP://WWW.DOH.DOT.STATE.NC.US/PRECONSTRUCT/HIGHWAY/LOCATION/PROJECT](http://www.doh.dot.state.nc.us/preconstruct/highway/location/project)
- FILE: b4222_ls_control_050105.txt
- SITE CALIBRATION PARAMETERS HAVE NOT BEEN DETERMINED FOR THIS PROJECT.
 IF FURTHER INFORMATION IS NEEDED, PLEASE CONTACT THE LOCATION AND SURVEYS UNIT.
- ⊙ INDICATES GEODETIC CONTROL MONUMENTS USED OR SET FOR HORIZONTAL PROJECT CONTROL BY THE NCDOT LOCATION AND SURVEYS UNIT.
- PROJECT CONTROL ESTABLISHED UTILIZING GLOBAL POSITIONING SYSTEM.
- NETWORK FOR GPS "B4222-2" ESTABLISHED FROM NGS ONLINE POSITIONING USER SERVICE (OPUS)

NOTE: DRAWING NOT TO SCALE