

CONTRACT: C201140 TIP: B-3522

T.I.P. NO.	SHEET NO.
B-3522	UC-1

STATE OF NORTH CAROLINA
DIVISION OF HIGHWAYS

**UTILITY CONSTRUCTION PLANS
WAKE COUNTY**

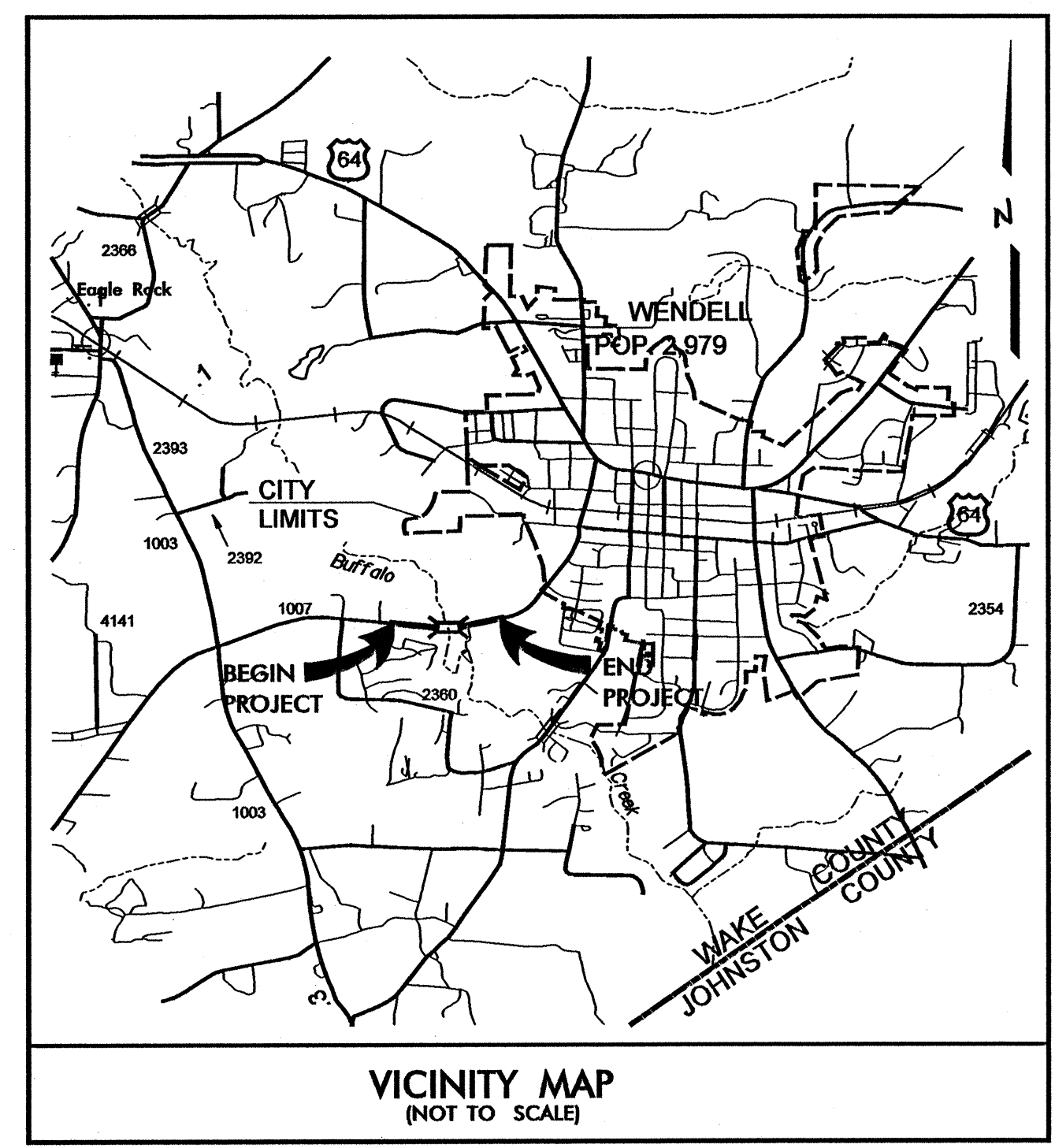

VICINITY MAP
(NOT TO SCALE)

LOCATION: BRIDGE NO. 215 OVER BUFFALO CREEK AND APPROACHES
ON SR 1007 (POOLE ROAD) SOUTH OF WENDELL
TYPE OF WORK: SEWER LINE CONSTRUCTION

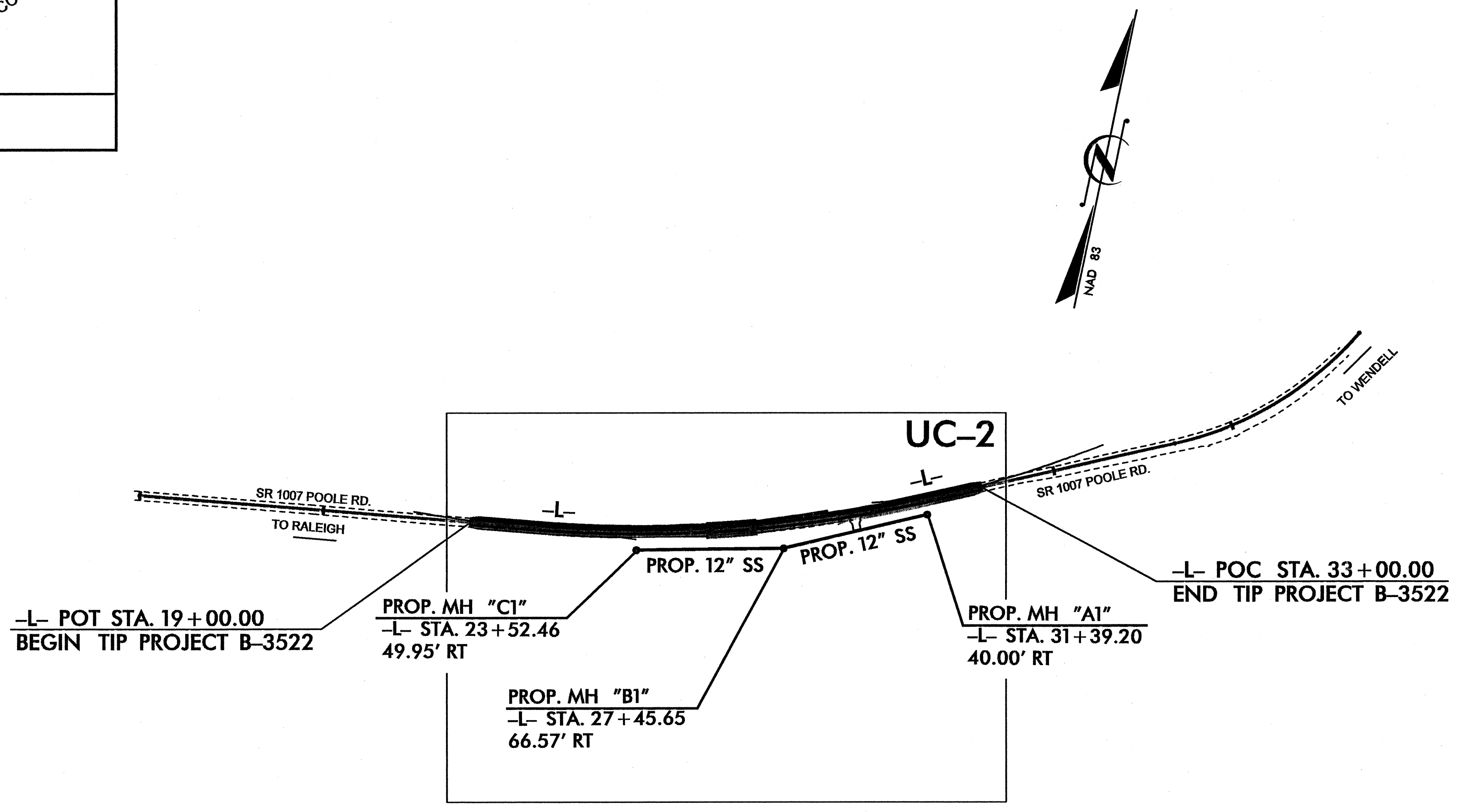

INDEX OF SHEETS	
SHEET NO.	DESCRIPTION
UC-1	TITLE SHEET
UC-2	UTILITY CONSTRUCTION PLAN AND PROFILE SHEET
UC-3	DETAIL SHEET

SEWER OWNERS ON PROJECT

(1) SANITARY SEWER-THE TOWN OF WENDELL

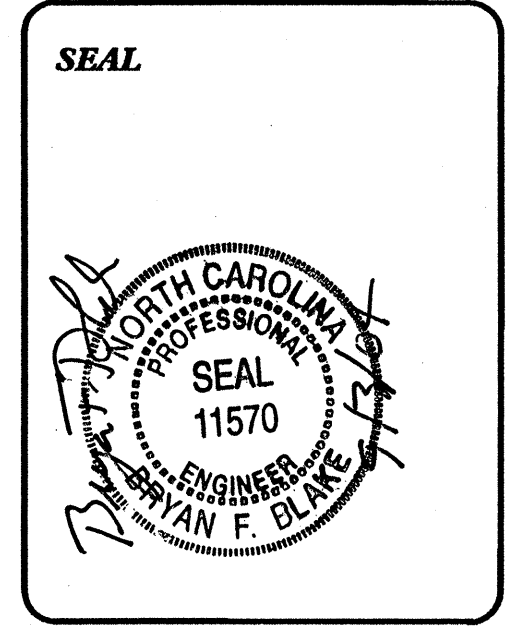

PREPARED IN THE OFFICE OF:
MCKIM & CREED, PA
FOR THE
NORTH CAROLINA DEPARTMENT
OF TRANSPORTATION
200 MACKENAN COURT, SUITE 200
CARY, NC 27520
PHONE: (919) 233-8091
FAX: (919) 233-8031

MCKIM & CREED

Bryan F. Blake, P.E. MCKIM & CREED, PA PROJECT MANAGER
Chris L. Windley, E.I. MCKIM & CREED, PA PROJECT DESIGN ENGINEER
R. B. Wilkins, P.E. NCDOT CONTACT