

**OFF-SITE DETOUR ROUTE** ● — ● — ● — ●

SEE RSD 1101.03, SHEET 1 OF 9, FOR ALL OTHER REQUIRED SIGNS AND SIGN PLACEMENT.  
SEE SHEET TCP-7 FOR DETOUR SIGN DESIGN.

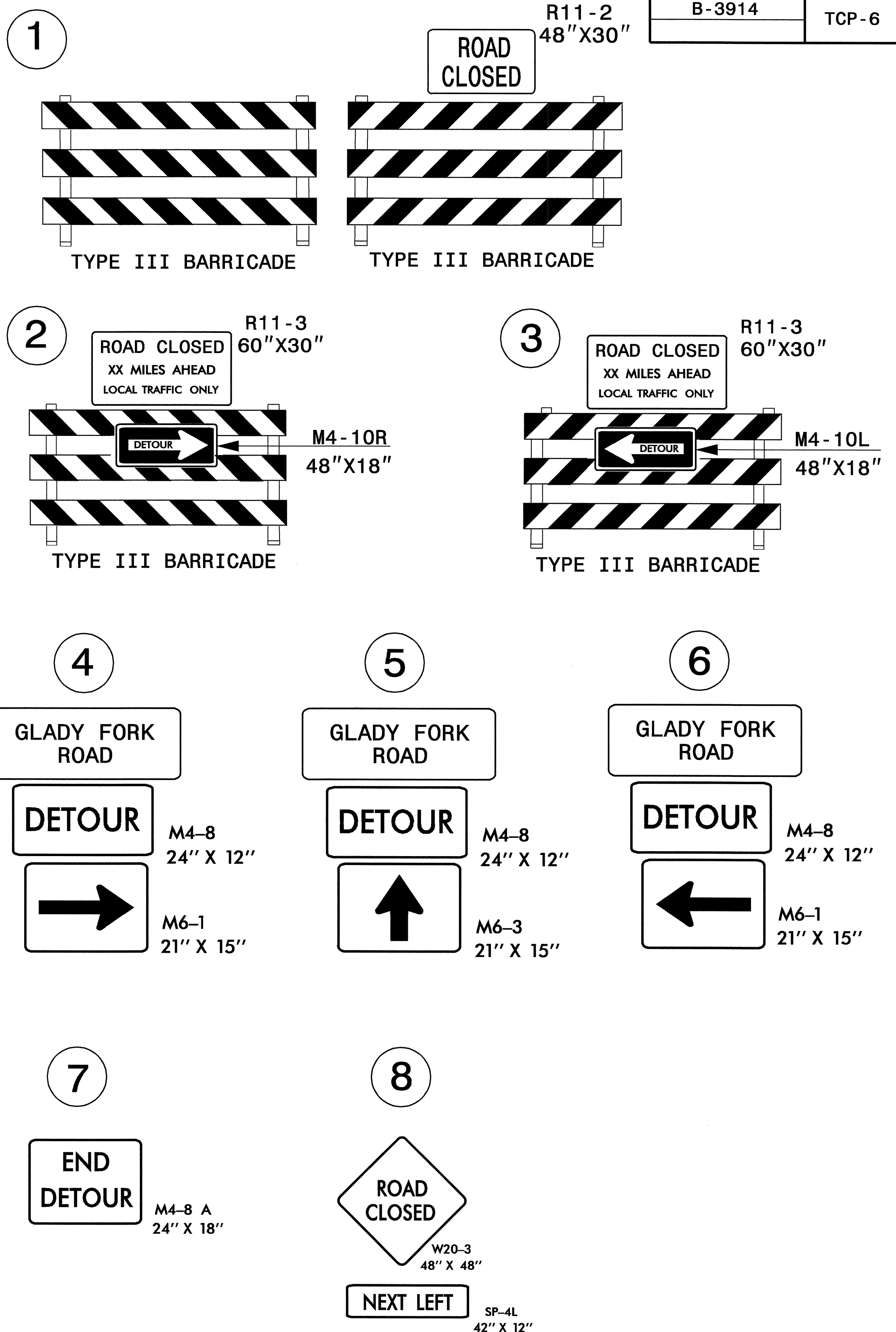

APPROVED: <i>[Signature]</i> DATE: 10/19/04	<b>DETOUR ROUTE AND DETOUR SIGNING</b>	
	SCALE: NONE	
	DATE: 10/13/04	
	DWG. BY: CLL	
	DESIGN BY: CLL	
REVIEWED BY: JI	REVISIONS	

15-OCT-2004 08:00  
\\gis-cct1s01\B3914\TCP\B3914\_TCP.dgn  
qlanford AT 10:09:47