

-L- STA. 14+25 LT & RT.
-L- STA. 15+05 RT.

CHAMPION CATTLE & TREE FARMS,
A NORTH CAROLINA LIMITED PARTNERSHIP
D.B. 395 PG. 264

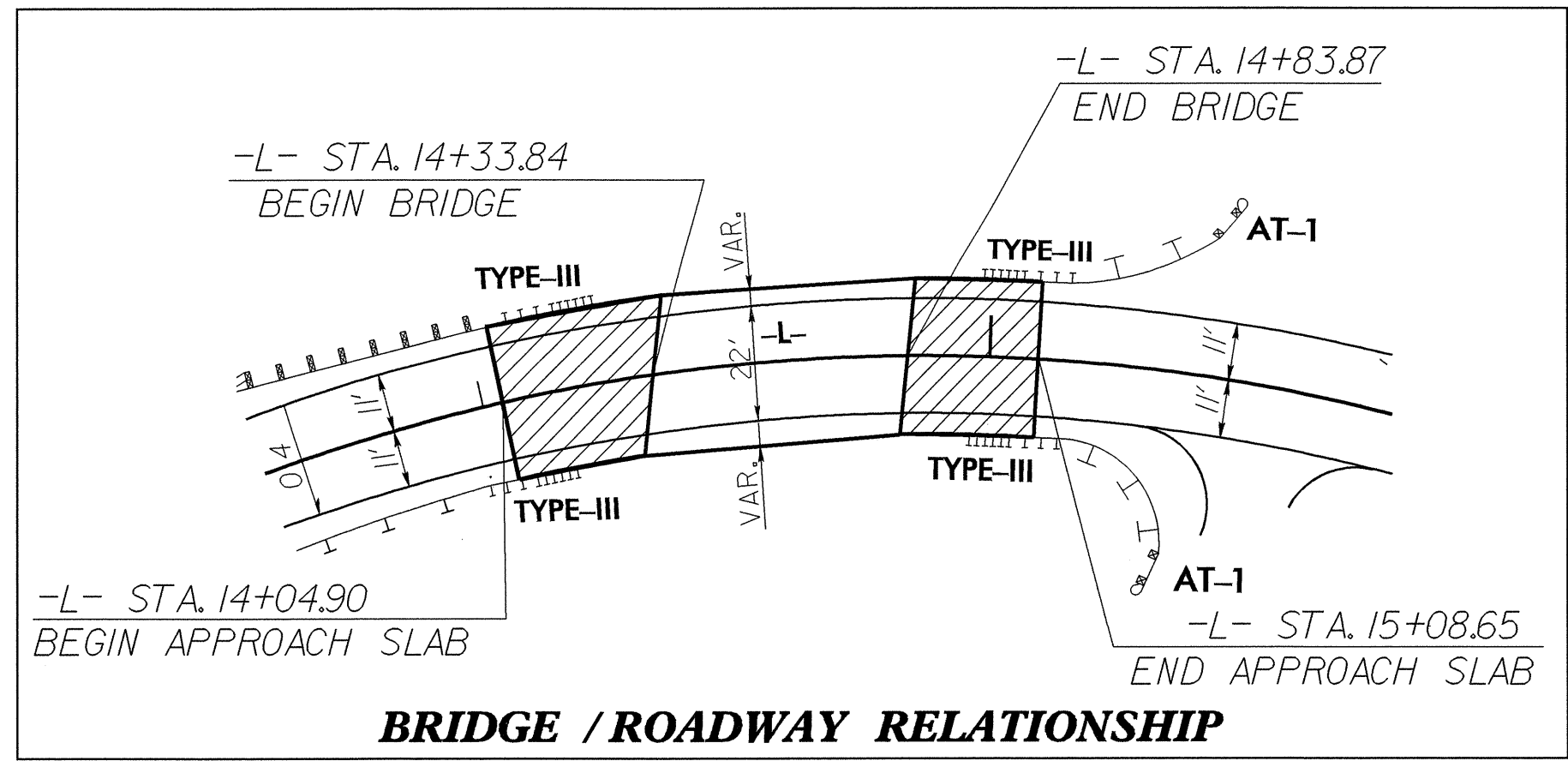
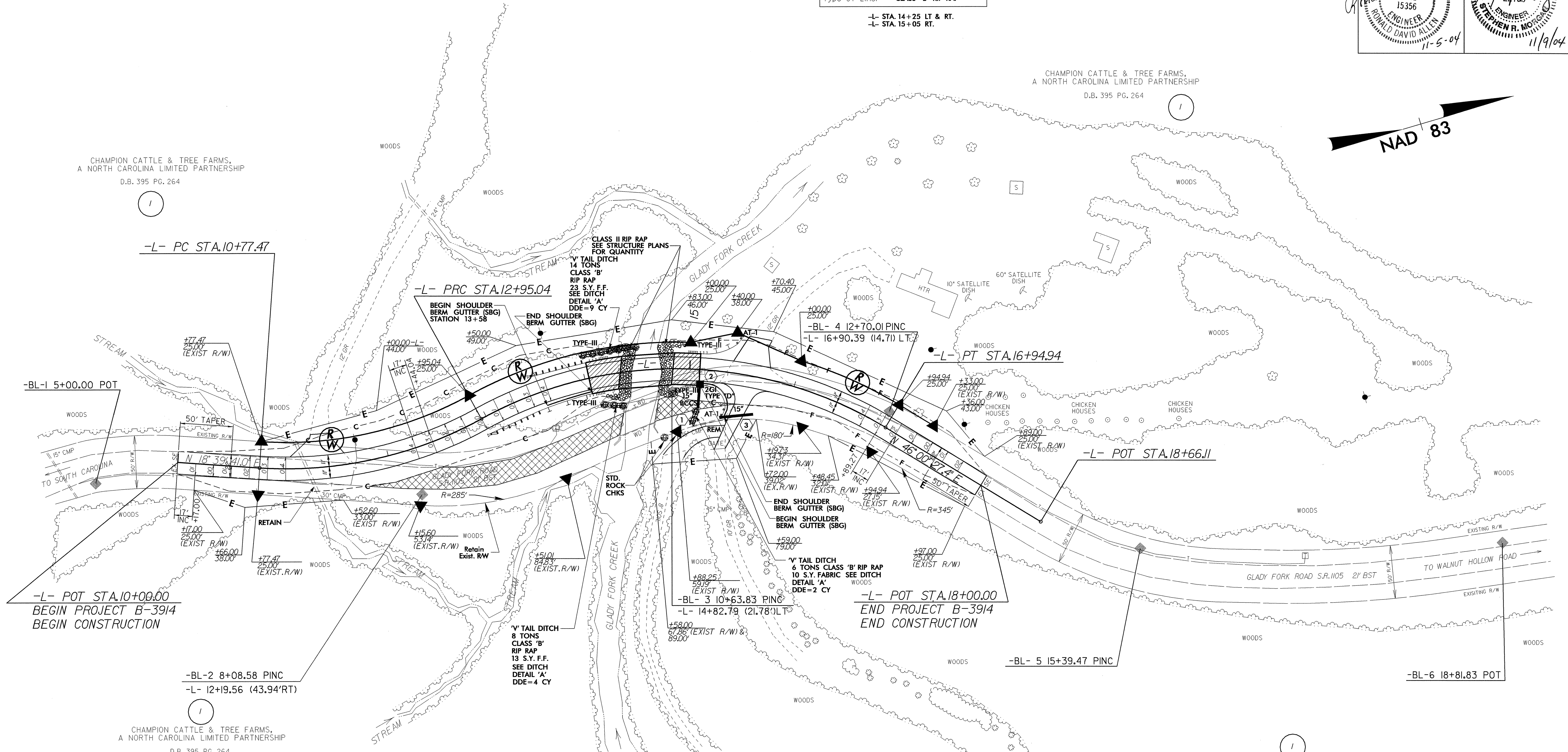
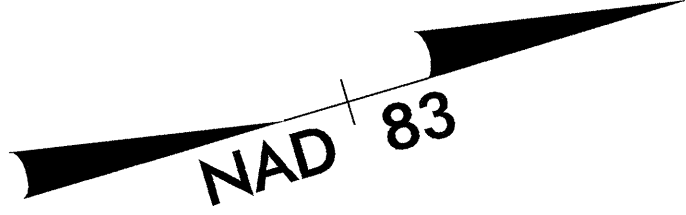

-L-	
PI Sta 11+89.30	PI Sta 15+15.50
$\Delta = 32' 38'' 00.8'' (LT)$	$\Delta = 59' 58'' 47.2'' (RT)$
$D = 14' 59'' 56.0''$	$D = 14' 59'' 56.0''$
$L = 217.57'$	$L = 399.89'$
$T = 111.83'$	$T = 220.46'$
$R = 382.00'$	$R = 382.00'$
$SE = .04$	$SE = .04$
$RO = 68'$	$RO = 68'$
$*V_{DES} = 30 MPH$	$*V_{DES} = 30 MPH$

* DESIGN SPEED EXCEPTION REQUIRED

NOTE: - REMOVE EXISTING BRIDGE ABUTMENTS AND MATCH TO NATURAL GROUND.
- DRIVEWAYS TO BE RECONNECTED PER THE RESIDENT ENGINEER
- SEE SHEET 5 FOR -L- PROFILE
- SEE SHEET S-1 THRU S-18 FOR STRUCTURE PLANS

8/17/99

REVISIONS

25-OCT-2004 11:23 B-3914s4.psh
F:\Roadway\RD188609\RD188609