

**STATE OF NORTH CAROLINA
DEPARTMENT OF TRANSPORTATION**

**SIGNING PLANS
JOHNSTON COUNTY**

**LOCATION: BRIDGE NO. 448 OVER BERNAL BRANCH
AND APPROACHES ON SR 1229**

T.I.P.: B-3670

CONTRACT NO.: C200831

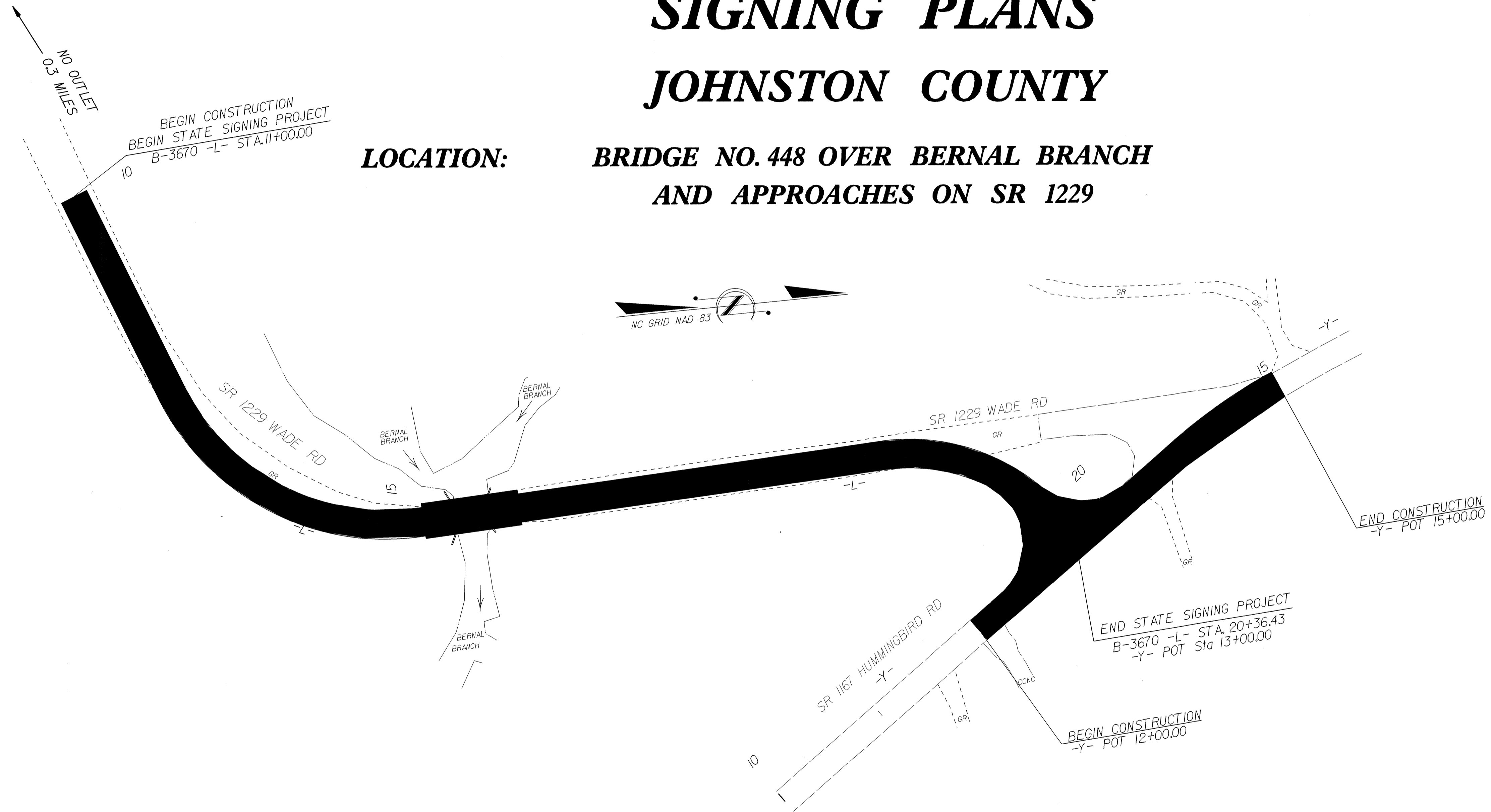

SUMMARY OF QUANTITIES

ITEM NO.		ITEM DESCRIPTION	QUANTITY	UNIT
DESC. NO.	SECT. NO.			
4025000000	901	CONTRACTOR FURNISHED, TYPE E SIGN.....	15.5	S.F.
4072000000	903	SUPPORTS, 3-LB STEEL U-CHANNEL.....	40	L.F.
4102000000	904	SIGN ERECTION, TYPE E.....	3	EA.
4155000000	907	DISPOSAL OF SIGN SYSTEM, U-CHANNEL.....	8	EA.

**ROADWAY STANDARD DRAWINGS
APPLICABLE TO THESE SIGNING PLANS
904.10
904.50**

INDEX

SHEET NO.	DESCRIPTION
1	TITLE SHEET
2	EXISTING/PROPOSED ROADWAY

PLAN PREPARED BY: N.C.D.O.T. SIGNING SECTION

RON KING, P.E. SIGNING ENGINEER

A. I. ALQUDWAH, P.E. SIGNING PROJECT ENGINEER

D. M. EATON SIGNING PROJECT DESIGN ENGINEER

K. S. FOWLER SIGNING DESIGNER

