

See Sheet 1-A For Index of Sheets  
See Sheet 1-B For Conventional Symbols

T.I.P. NO.	SHEET NO.
B-3651	UO-1

STATE OF NORTH CAROLINA  
DIVISION OF HIGHWAYS

**UTILITIES BY OTHERS PLANS  
GUILFORD COUNTY**

**LOCATION: BRIDGE NO. 359 ON SR 3143 (MILLSTREAM ROAD) OVER PRONG ALAMANCE CREEK**

**TYPE OF WORK: UTILITIES**

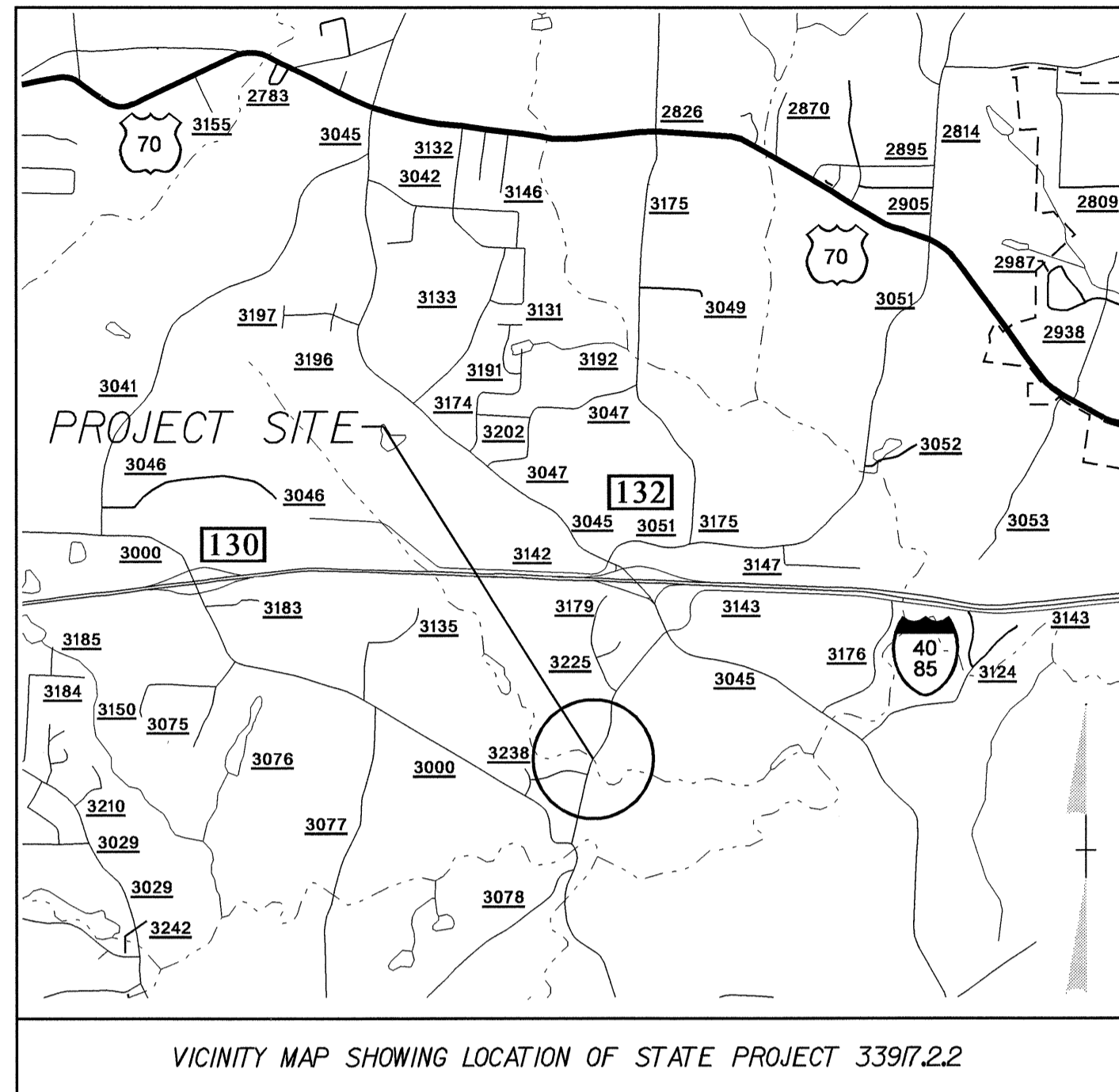

VICINITY MAP SHOWING LOCATION OF STATE PROJECT 3397.2.2

TIP: B-3651

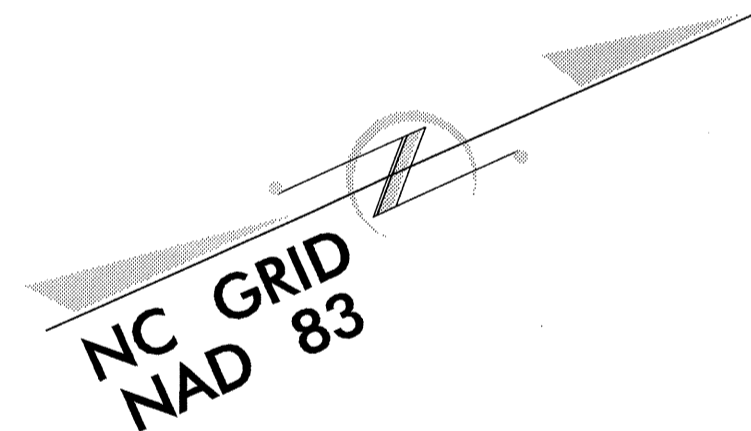
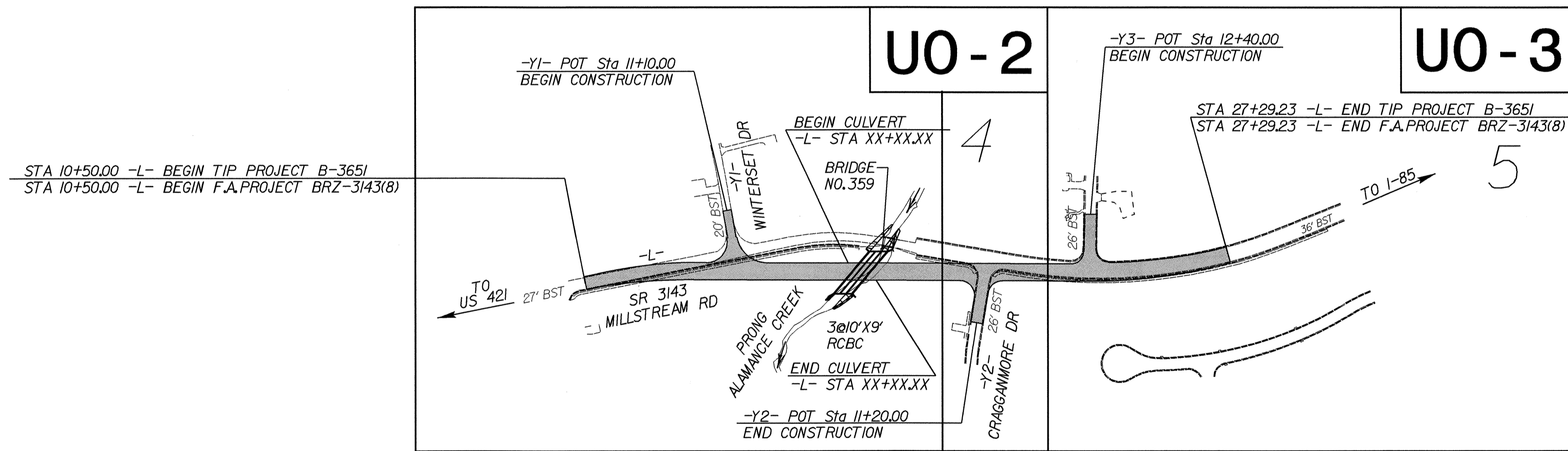

INDEX OF SHEETS	
SHEET NO.	DESCRIPTION
UO-1	TITLE SHEET
UO-2 THRU UO-3	UTILITIES BY OTHERS PLAN SHEETS

UTILITY OWNERS ON PROJECT
(1) DUKE ENERGY
(2) BELLSOUTH
(3) TIME WARNER
(4) MCI
(5) PIEDMONT NATURAL GAS COMPANY

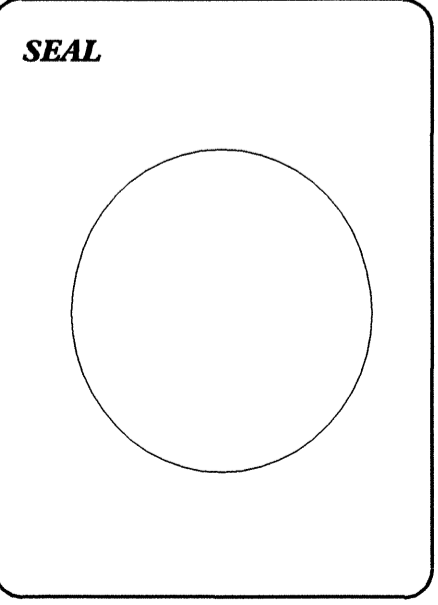

PREPARED IN THE OFFICE OF:  
**DIVISION OF HIGHWAYS  
DESIGN SERVICES  
UTILITY SECTION**

1591 MAIL SERVICES CENTER  
RALEIGH NC 27699-1591  
PHONE (919) 250-4128  
FAX (919) 250-4119

**Roger Worthington, P.E.** UTILITIES SECTION ENGINEER  
**Steve Mckee, P.E.** UTILITIES SQUAD LEADER PROJECT ENGINEER  
**Alonza Yancey** UTILITIES PROJECT DESIGNER

\$ FILE \$  
\$ DATE \$