

TIP PROJECT: B-3651

CONTRACT: C201351

SEE SHEET 1-A FOR INDEX OF SHEETS
SEE SHEET 1-B FOR CONVENTIONAL SYMBOLS

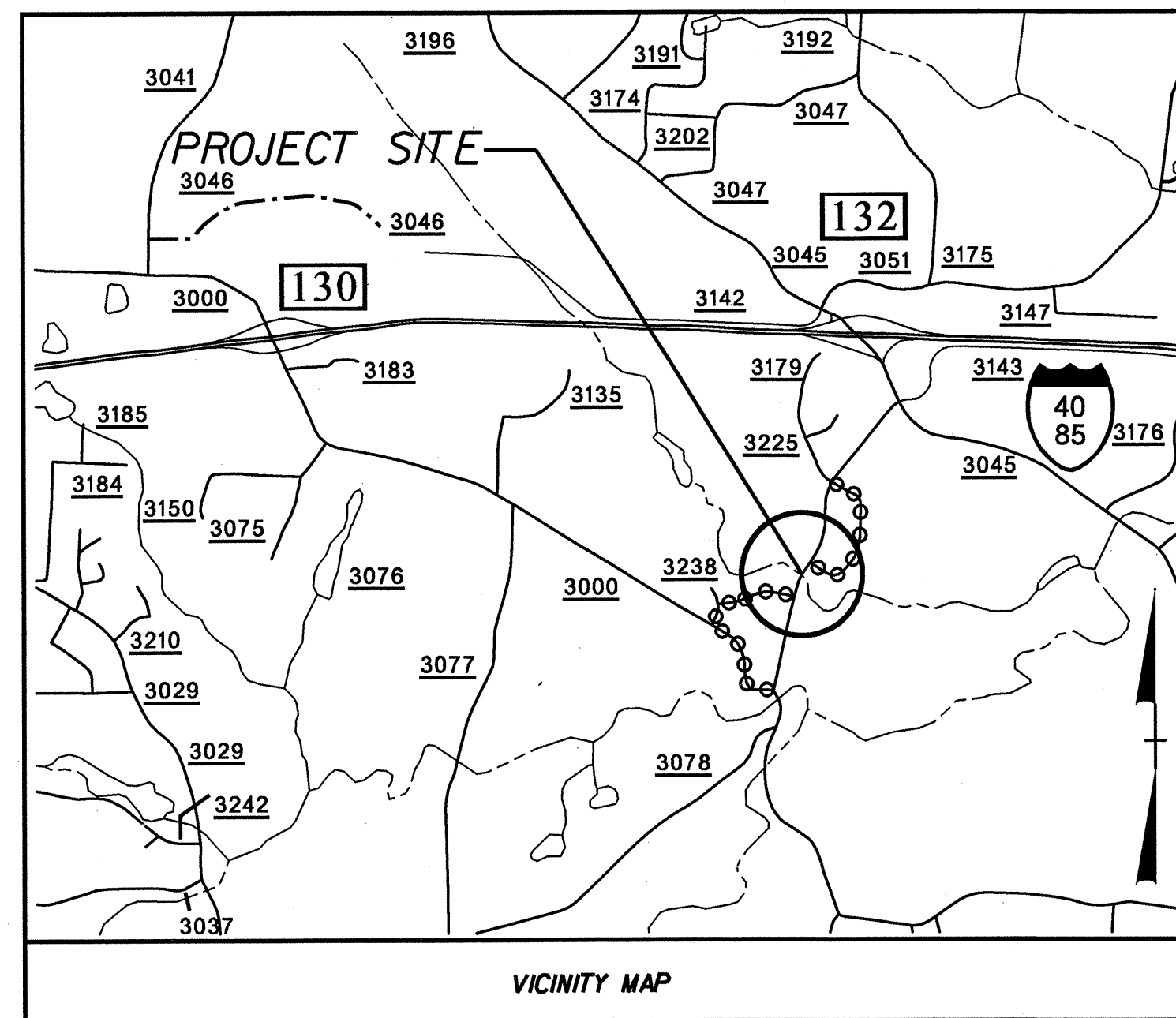

○-○-○ OFF-SITE DETOUR ROUTE FOR -Y1- & -Y2-

STATE OF NORTH CAROLINA

DIVISION OF HIGHWAYS

GUILFORD COUNTY

**LOCATION: BRIDGE NO. 359 OVER PRONG ALAMANCE CREEK
ON SR 3143 (MILLSTREAM RD)**

TYPE OF WORK: GRADING, PAVING, DRAINAGE, AND CULVERT

STATE	STATE PROJECT REFERENCE NO.	SHEET NO.	TOTAL SHEETS
N.C.	B-3651	1	
STATE PROJ. NO.	F.A. PROJ. NO.	DESCRIPTION	
33197.1.1	BRZ-3143(7)	P.E.	
33197.2.2	BRZ-3143(8)	RIGHT-OF-WAY	
33197.2.2	BRZ-3143(8)	UTILITY	
33197.3.1	BRZ-3143(9)	CONSTRUCTION	

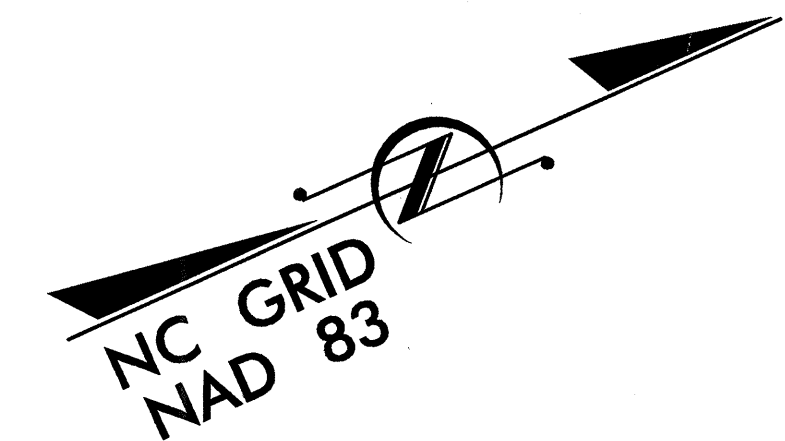
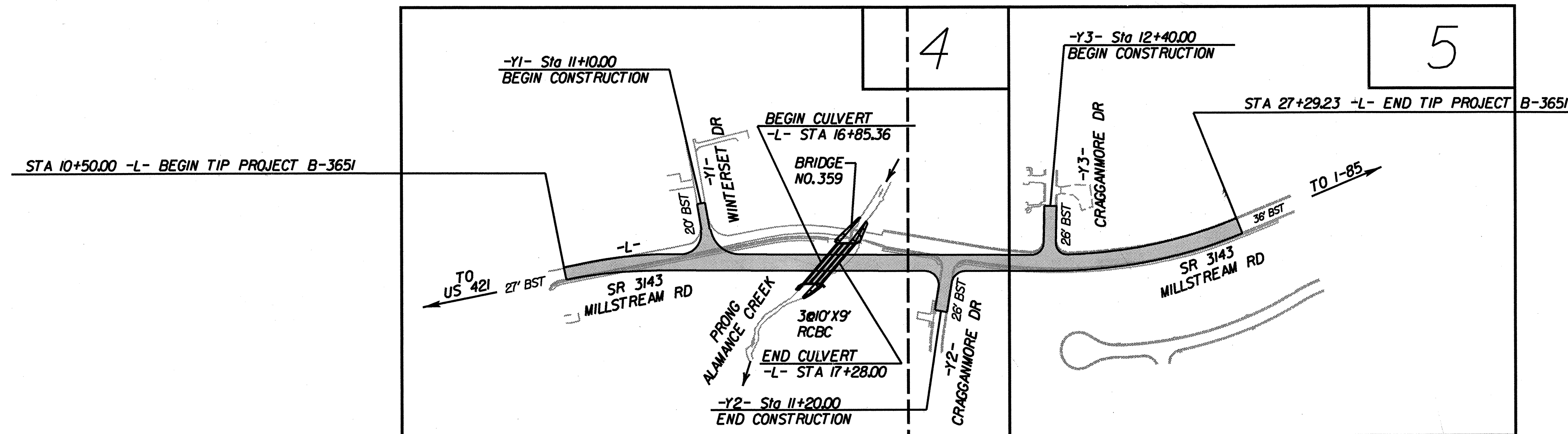

NCDOT CONTACT: TERESA BRUTON, PE
DESIGN SERVICES UNIT

This document, together with the concepts and designs presented herein, as an without written authorization and adoption by Kimley-Horn and Associates, Inc. shall be without liability to Kimley-Horn and Associates, Inc. for which it was prepared. Reuse of and improper reliance on this document instrument of service is intended only for the specific purpose and client.

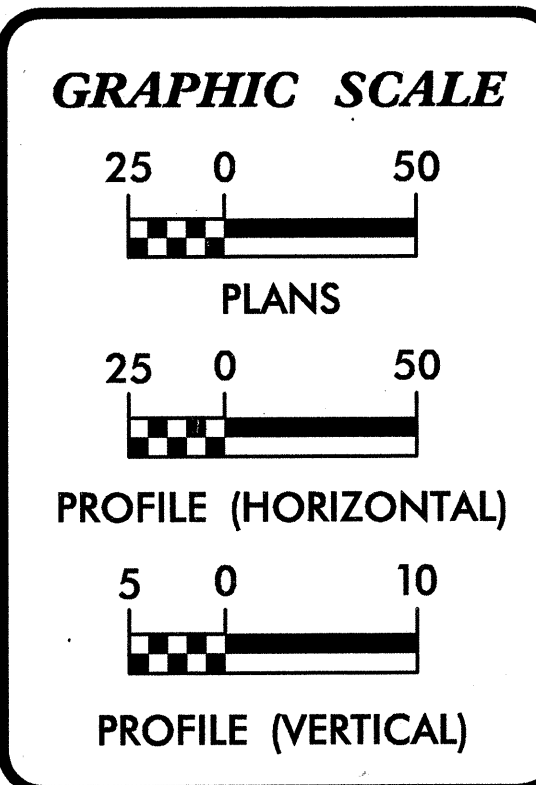

DESIGN DATA

ADT 2005 =	2,100 VPD
ADT 2025 =	3,800 VPD
DHV =	11%
D =	65%
T =	4% *
V =	50 mph

VERTICAL CURVE AND MAXIMUM GRADE DESIGN EXCEPTIONS

* (TTST 1% + DUAL 3%)

PROJECT LENGTH

LENGTH OF ROADWAY TIP PROJECT B-3651 =	0.310 MILES
LENGTH OF STRUCTURE TIP PROJECT B-3651 =	0.008 MILES
TOTAL LENGTH OF TIP PROJECT B-3651 =	0.318 MILES

PLANS PREPARED FOR NCDOT BY:

Kimley-Horn and Associates, Inc.

Post Office Box 33068
Raleigh, North Carolina 27636

2002 STANDARD SPECIFICATIONS

<p>RIGHT-OF-WAY DATE: JUNE 23, 2003</p> <p>LETTING DATE: JANUARY 18, 2005</p>	<p>JEFFREY W. MOORE, PE PROJECT ENGINEER</p>
---	---

<p>HYDRAULICS ENGINEER</p> <p>JEFFREY W. MOORE, PE</p> <p>ROADWAY DESIGN</p> <p>JEFFREY W. MOORE, PE</p>	<p>DIVISION OF HIGHWAYS STATE OF NORTH CAROLINA</p> <p style="text-align: center;"><i>cut miller</i></p> <p>STATE DESIGN ENGINEER DEPARTMENT OF TRANSPORTATION FEDERAL HIGHWAY ADMINISTRATION</p> <p>APPROVED DIVISION ADMINISTRATOR</p>
--	---