

SURVEY CONTROL SHEET B-3651

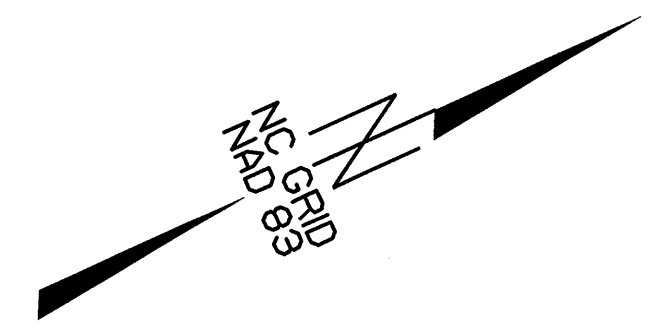

STA 10+50.00 -L- BEGIN TIP PROJECT B-3651
STA 10+50.00 -L- BEGIN F.A. PROJECT BRZ-3143(8)

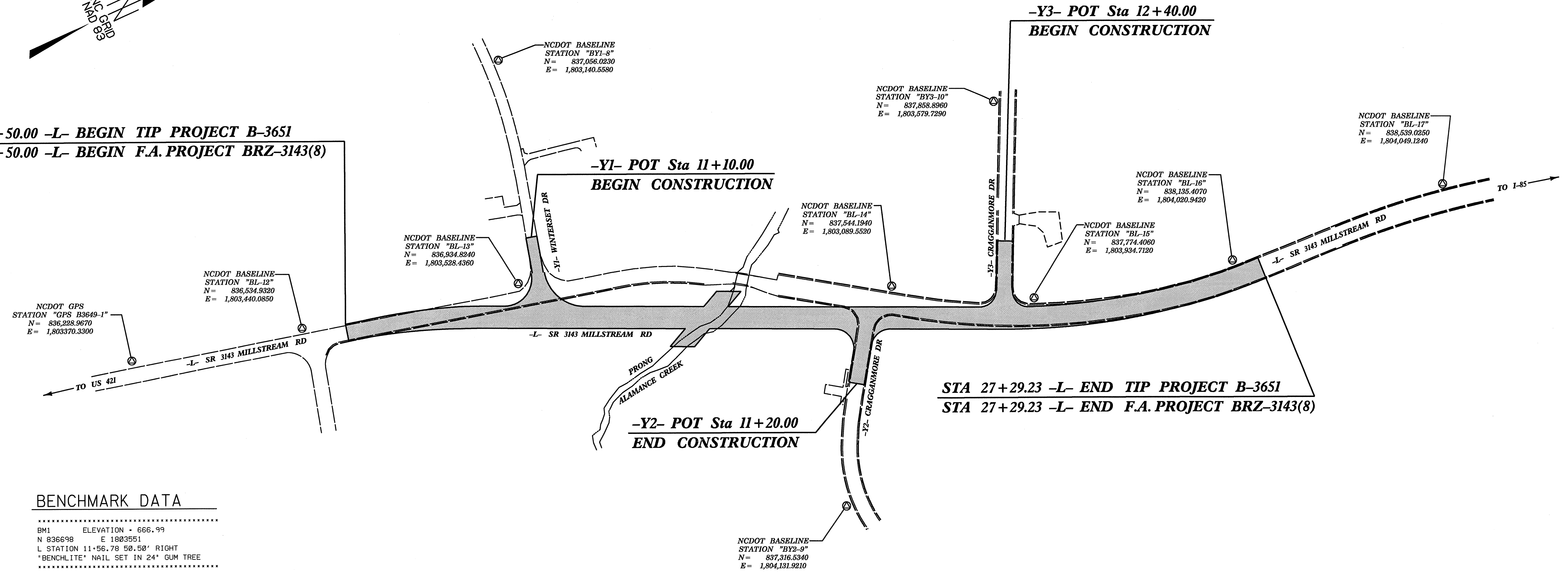

BENCHMARK DATA

BM1	ELEVATION - 666.99
N 836698	E 1803551
L STATION 11+56.78 50.50' RIGHT	
"BENCHLITE" NAIL SET IN 24" GUM TREE	
BM2	ELEVATION - 628.82
N 837277	E 1803808
L STATION 17+97.53 57.15' RIGHT	
"BENCHLITE" NAIL SET IN 12" OAK TREE	
BM3	ELEVATION - 676.48
N 838254	E 1804097
L STATION 28+07.26 46.87' RIGHT	
"BENCHLITE" NAIL SET IN 24" OAK TREE	

CONTROL DATA

BL POINT	DESC.	NORTH	EAST	ELEVATION	L STATION	OFFSET
1	GPS B3649-1	836228.9670	1803370.3300	662.88	OUTSIDE PROJECT LIMITS	
12	BL-12	836534.9320	1803440.0850	671.87	OUTSIDE PROJECT LIMITS	
13	BL-13	836934.8240	1803528.4360	644.06	13+70.47	57.24 LT
14	BL-14	837544.1940	1803809.5520	637.59	20+41.53	50.51 LT
15	BL-15	837774.4060	1803934.7120	652.59	23+04.07	29.63 LT
16	BL-16	838135.4070	1804020.9420	668.44	26+85.37	25.45 LT
17	BL-17	838539.0250	1804049.1240	681.65	OUTSIDE PROJECT LIMITS	
BY1						
POINT	DESC.	NORTH	EAST	ELEVATION	Y1 STATION	OFFSET
8	BY1-8	837056.0230	1803140.5580	659.01	OUTSIDE PROJECT LIMITS	
21	BY1-21	836934.8240	1803528.4360	644.05	11+93.01	32.30 RT
BY2						
POINT	DESC.	NORTH	EAST	ELEVATION	Y2 STATION	OFFSET
22	BY2-22	837544.1940	1803809.5520	637.61	OUTSIDE PROJECT LIMITS	
9	BY2-9	837316.5340	1804131.9210	640.84	OUTSIDE PROJECT LIMITS	
BY3						
POINT	DESC.	NORTH	EAST	ELEVATION	Y3 STATION	OFFSET
18	BY3-18	837858.8960	1803579.7290	651.02	OUTSIDE PROJECT LIMITS	
23	BY3-23	837774.4060	1803934.7120	652.61	13+47.98	54.33 LT

DATUM DESCRIPTION
 THE LOCALIZED COORDINATE SYSTEM DEVELOPED FOR THIS PROJECT IS BASED ON THE STATE PLANE COORDINATES ESTABLISHED BY NCDOT FOR MONUMENT "B3649-1" WITH NAD 1983/95 STATE PLANE GRID COORDINATES OF NORTHING: 836228.967(3ft) EASTING: 1803370.330(3ft) THE AVERAGE COMBINED GRID FACTOR USED ON THIS PROJECT (GROUND TO GRID) IS: 0.999941580 THE N.C. LAMBERT GRID BEARING AND LOCALIZED HORIZONTAL GROUND DISTANCE FROM "B3649-1" TO -L- STATION 10+00.00 IS N 15° 59' 08.0" E 344.81 FT ALL LINEAR DIMENSIONS ARE LOCALIZED HORIZONTAL DISTANCES VERTICAL DATUM USED IS NAVD 88

NOTES

1. THE CONTROL DATA FOR THIS PROJECT CAN BE FOUND ELECTRONICALLY BY SELECTING PROJECT CONTROL DATA AT:
[HTTP://WWW.DOH.DOT.STATE.NC.US/PRECONSTRUCT/HIGHWAY/LOCATION/PROJECT/](http://www.doh.dot.state.nc.us/preconstruct/highway/location/project/)
 FILE: b3651.ls_control_030804.txt
 SITE CALIBRATION INFORMATION HAS NOT BEEN PROVIDED FOR THIS PROJECT. IF FURTHER INFORMATION IS NEEDED, PLEASE CONTACT THE LOCATION AND SURVEYS UNIT.

⊙ INDICATES GEODETIC CONTROL MONUMENTS USED OR SET FOR HORIZONTAL PROJECT CONTROL BY THE NCDOT LOCATION AND SURVEYS UNIT. ALL COORDINATES SHOWN ARE LOCALIZED PROJECT COORDINATES.
 PROJECT CONTROL ESTABLISHED USING GLOBAL POSITIONING SYSTEM.

NOTE: DRAWING NOT TO SCALE

5/14/99
 r:\pro\bet\01036055\plan\B3651.dwg
 01/22/2004