



STATE OF NORTH CAROLINA
DIVISION OF HIGHWAYS

CUMBERLAND COUNTY

**LOCATION: OWEN DRIVE EXTENSION FROM EAST OF
I-95 BUSINESS/US 301 TO NC 87 AT EAST
MOUNTAIN DRIVE**

TYPE OF WORK: TRAFFIC SIGNALS AND COMMUNICATIONS CABLE

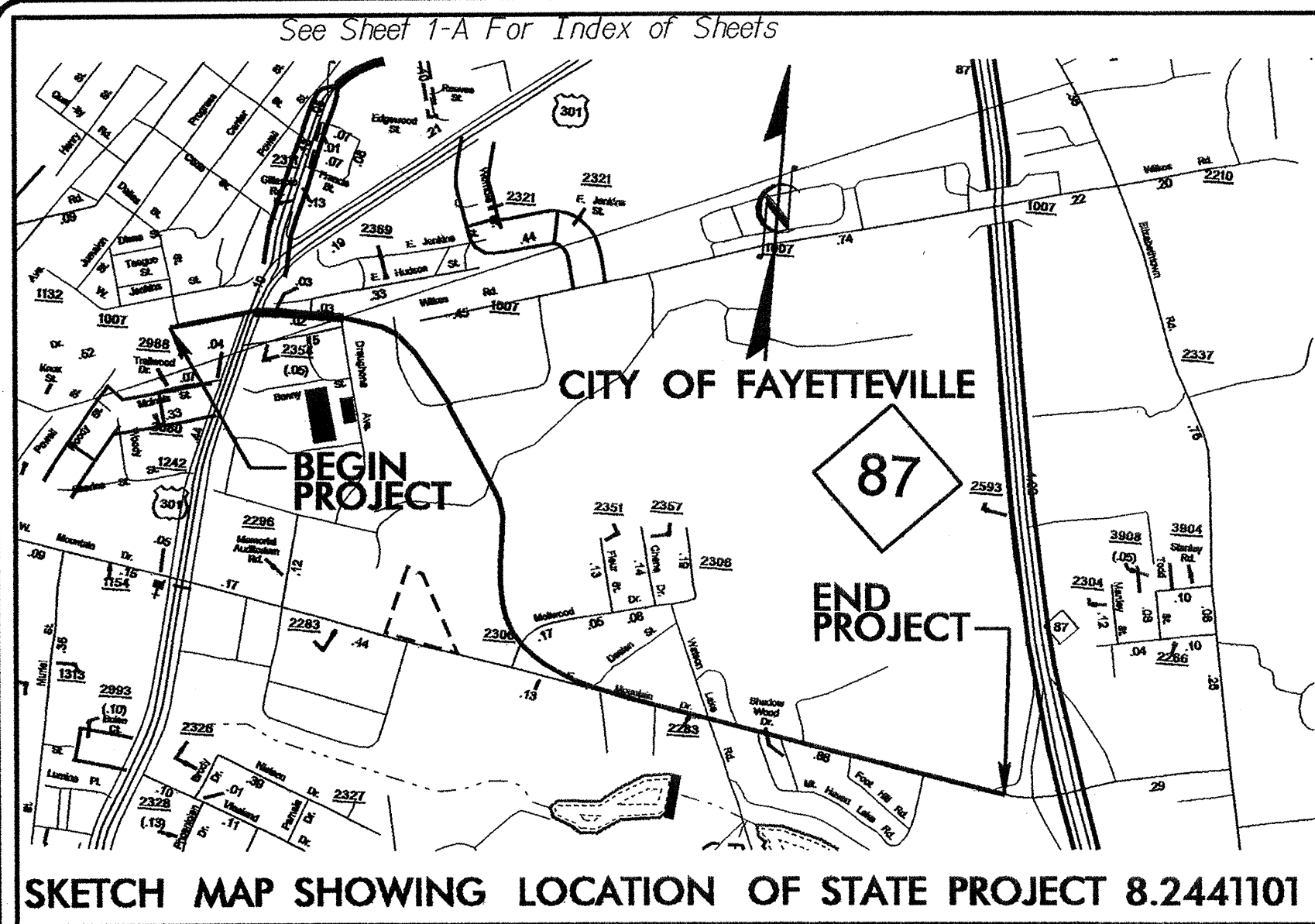

SKETCH MAP SHOWING LOCATION OF STATE PROJECT 8.2441101

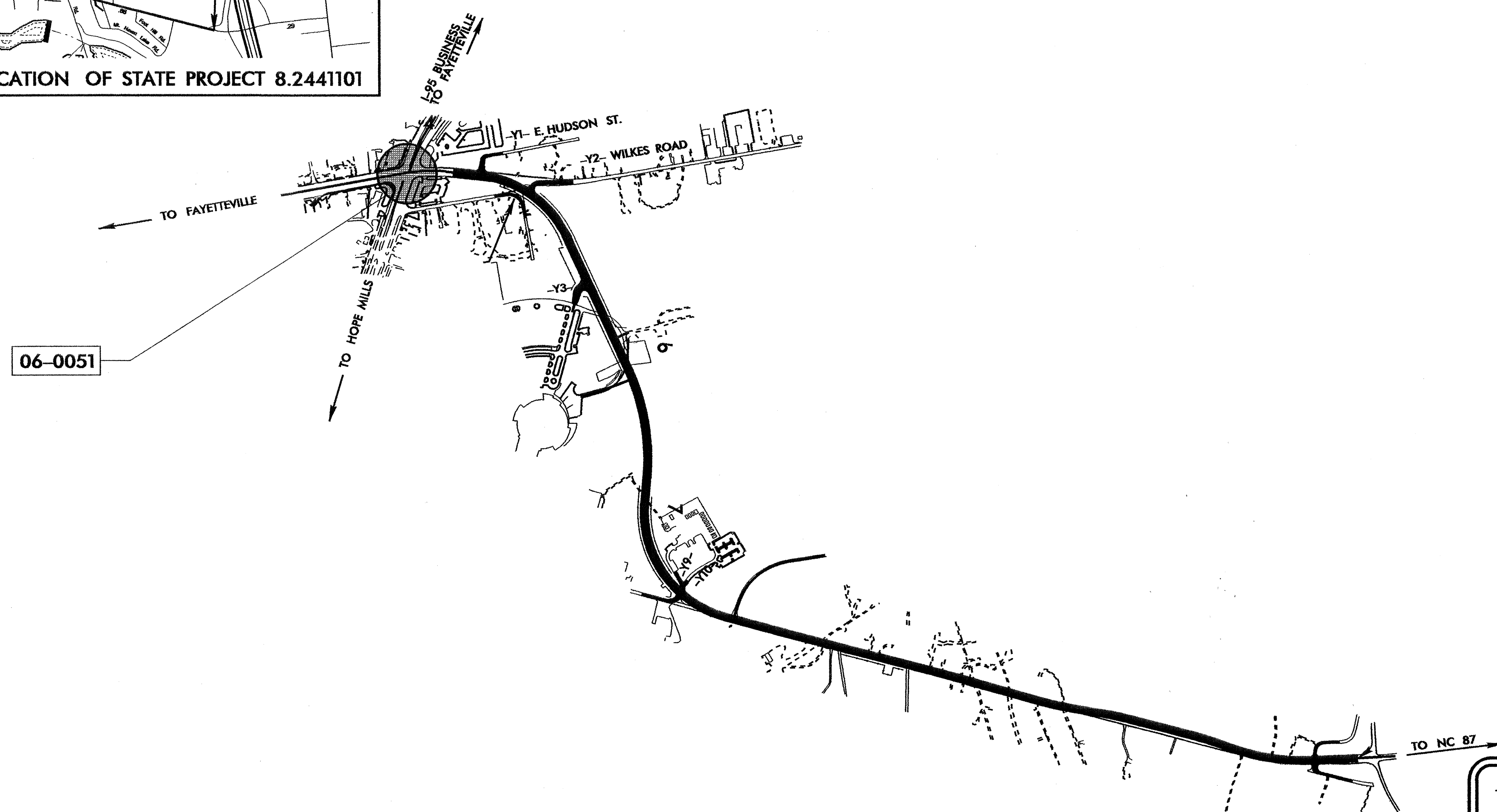

PROJECT: U-2912

Refer to "Roadway Standard Drawings
NCDOT" dated January 2002 and
"Standard Specifications for Roads
and Structures" dated January 2002.

Sheet #	Reference #	Index of Plans	Location/Description
Sig. 1		Title Sheet	
Sig. 2-3	06-0051	US 301/I-95 Business (Gillespie Street) At SR 1007 (Owen Drive)	
Sig. 4-8	N/A	Metal Pole Details	
Sig. 9-13	N/A	Communications Cable Routing Plans	

TRAFFIC MANAGEMENT AND SIGNAL SYSTEMS UNIT
Contacts:

- D. Y. Ishak - Signals and Geometrics Contracts Engineer
- G. C. Brown, PE - Signal Equipment Design Engineer
- G. G. Murr, Jr., PE - Traffic Management Systems Engineer

Prepared in the Office of:
DIVISION OF HIGHWAYS
TRAFFIC ENGINEERING AND SAFETY SYSTEMS
BRANCH

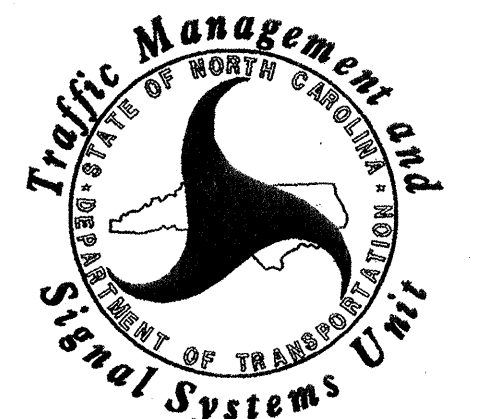

122 N. McDowell St., Raleigh, NC 27603

9/09/99
07-JUL-2004 13:58
W:\pfiles-unit\workgroups\TIP Projects\U-2912\proj\U2912_Sig_1.tsh.dgn