

09/08/99

See Sheet 1-A For Index of Sheets  
 See Sheet 1-B For Conventional Symbols  
 See Sheet 1-C & 1-D For Survey Control Plans

STATE OF NORTH CAROLINA  
 DIVISION OF HIGHWAYS  
**RANDOLPH COUNTY**

|                 |                             |             |              |
|-----------------|-----------------------------|-------------|--------------|
| STATE           | STATE PROJECT REFERENCE NO. | SHEET NO.   | TOTAL SHEETS |
| N.C.            | <b>B-3506</b>               | 1           |              |
| STATE PROJ. NO. | F.A. PROJ. NO.              | DESCRIPTION |              |
| 33120.1.1       | BRZ-2832(2)                 | PE          |              |
| 33120.2.2       | BRZ-2832(2)                 | R/W, UTIL.  |              |
| 33120.3.1       | BRZ-2832(5)                 | CONST.      |              |

**TIP PROJECT: B-3506**

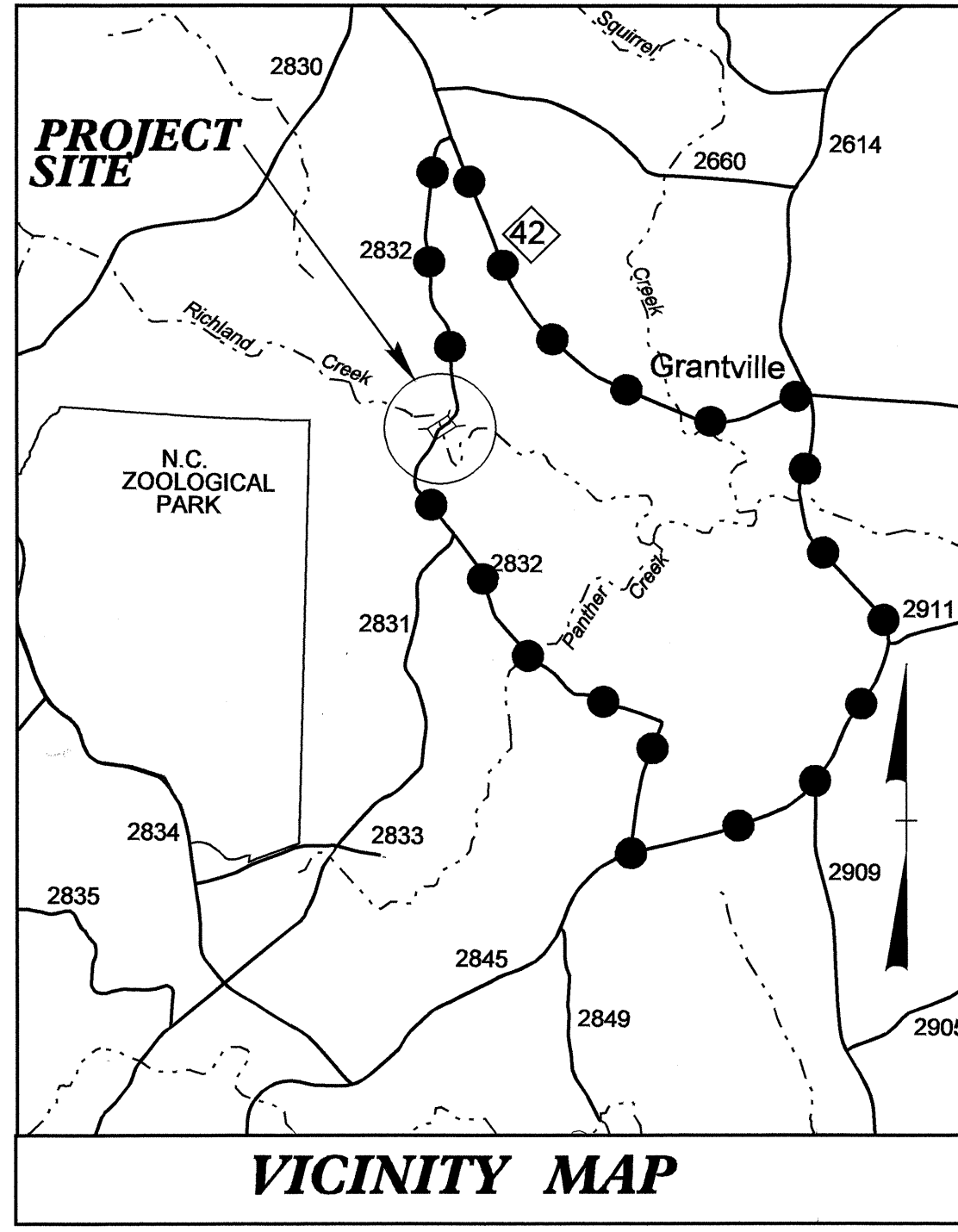

**LOCATION: BRIDGE NO. 226 OVER RICHLAND CREEK  
 ON SR 2832**

**TYPE OF WORK: GRADING, DRAINAGE, PAVING AND STRUCTURE**

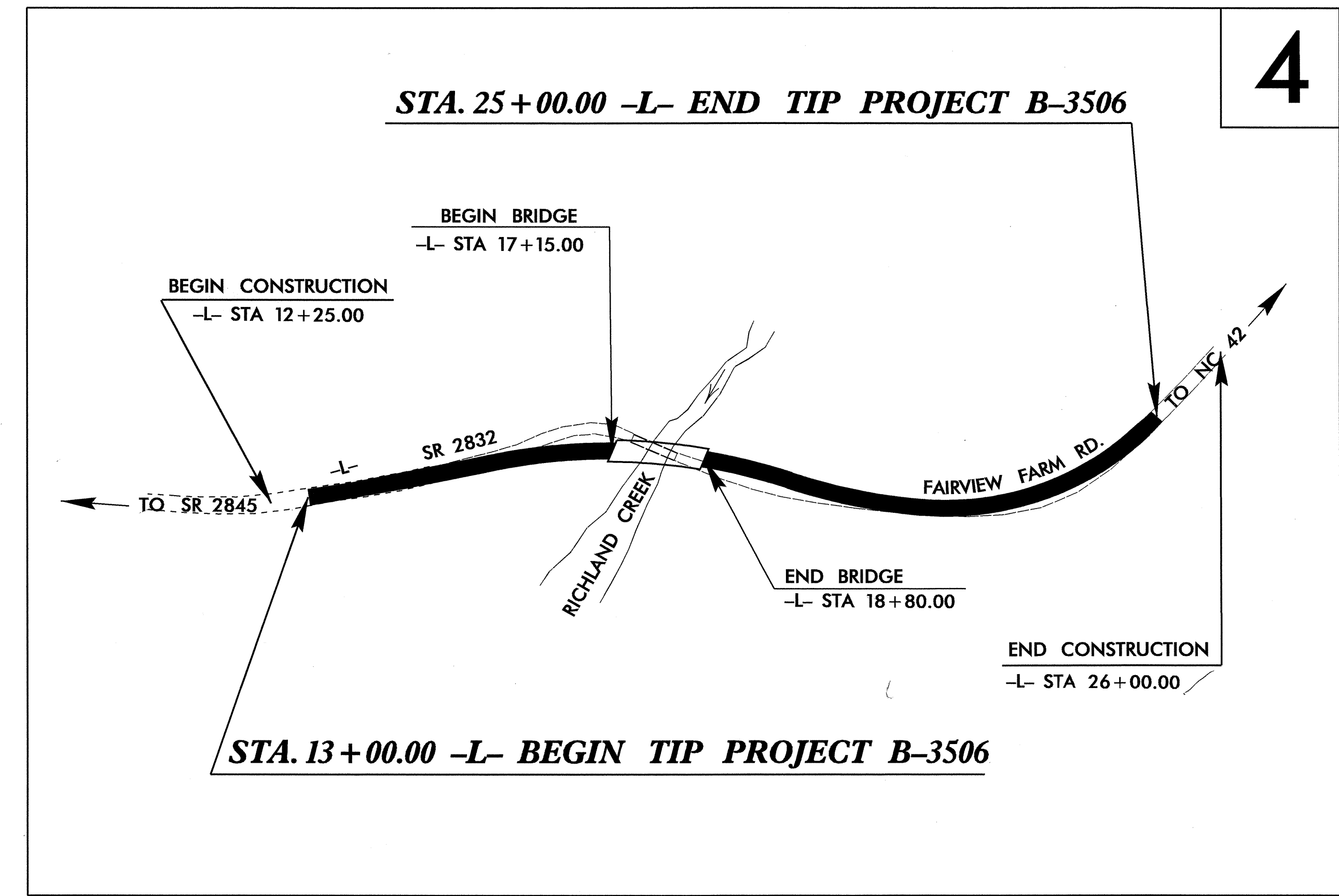
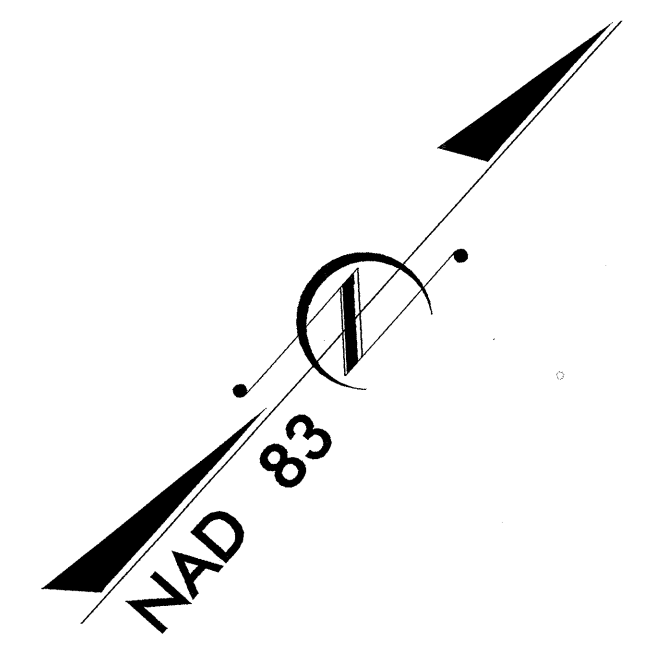

**CONTRACT: C201394**

\*\* DESIGN EXCEPTION REQUIRED FOR DESIGN SPEED

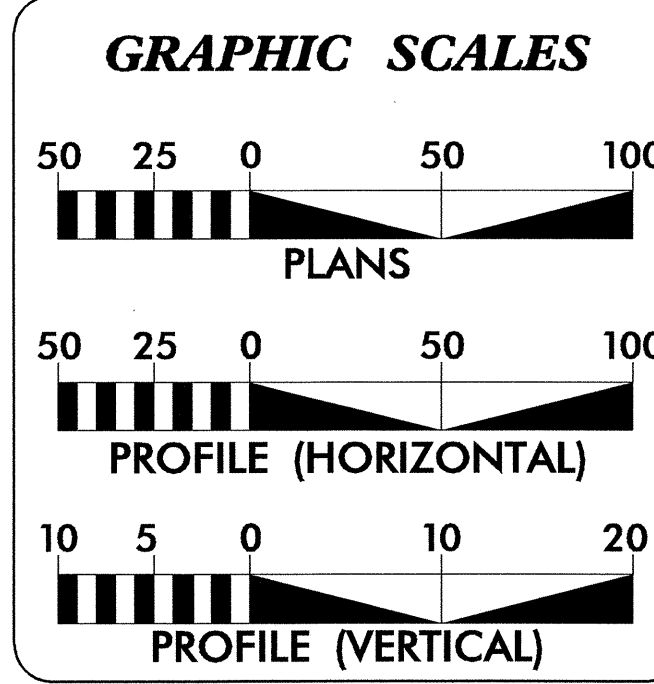

**DESIGN DATA**

ADT 2004 = 244  
 ADT 2024 = 393  
 DHV = 10 %  
 D = 60 %  
 \* T = 3 %  
 \*\* V = 25 MPH  
 \* TTST 1 % + DUAL 2 %  
 POSTED = 55 MPH (STAT.)

**PROJECT LENGTH**

LENGTH ROADWAY TIP PROJECT B-3506 = 0.196 MI  
 LENGTH STRUCTURE TIP PROJECT B-3506 = 0.031 MI  
 TOTAL LENGTH OF TIP PROJECT B-3506 = 0.227 MI

Prepared in the Office of:  
**DIVISION OF HIGHWAYS**  
 1000 Birch Ridge Dr., Raleigh NC, 27610

2002 STANDARD SPECIFICATIONS

**RIGHT OF WAY DATE:**  
 SEPTEMBER 19, 2003

**LETTING DATE:**  
 JANUARY 18, 2005

**BRENDA MOORE, PE**  
 PROJECT ENGINEER

**REKHA PATEL, PE**  
 PROJECT DESIGN ENGINEER

**HYDRAULICS ENGINEER**

**PROFESSIONAL ENGINEER**  
 SEAL 20329  
 NAD 83

**ROADWAY DESIGN**  
**PROFESSIONAL ENGINEER**  
 SEAL 19795  
 BRENDA L. MOORE

SIGNATURE: *B.R. Moore*

**DIVISION OF HIGHWAYS**  
 STATE OF NORTH CAROLINA

*Ant McMillan*  
 P.E.  
 STATE DESIGN ENGINEER

**DEPARTMENT OF TRANSPORTATION**  
 FEDERAL HIGHWAY ADMINISTRATION

APPROVED  
 DIVISION ADMINISTRATOR

DATE

15-JUN-2004 13:54  
 R:\Roadway\Proj\B3506.tsh  
 RPatel AT