

8/17/99

PROJECT REFERENCE NO. U-4010	SHEET NO. 5
RW SHEET NO.	
ROADWAY DESIGN ENGINEER NORTH CAROLINA PROFESSIONAL SEAL 24912 KEVIN E. MOORE 5/12/04	HYDRAULICS ENGINEER NORTH CAROLINA PROFESSIONAL SEAL 023993 MAX S. PRICKS 5/17/04

-L-
PI Sta 23+57.40
 $\Delta = 0^\circ 33' 10.4" (LT)$
 $D = 0' 22' 55.1"$
 $L = 144.75'$
 $T = 72.37'$
 $R = 15,000.00'$
 $SE = 0.02$

-Y2-
PI Sta 11+84.71
 $\Delta = 10^\circ 23' 11.3" (RT)$
 $D = 6' 59' 14.2"$
 $L = 148.65'$
 $T = 74.53'$
 $R = 820.00'$
 $SE = 0.05$

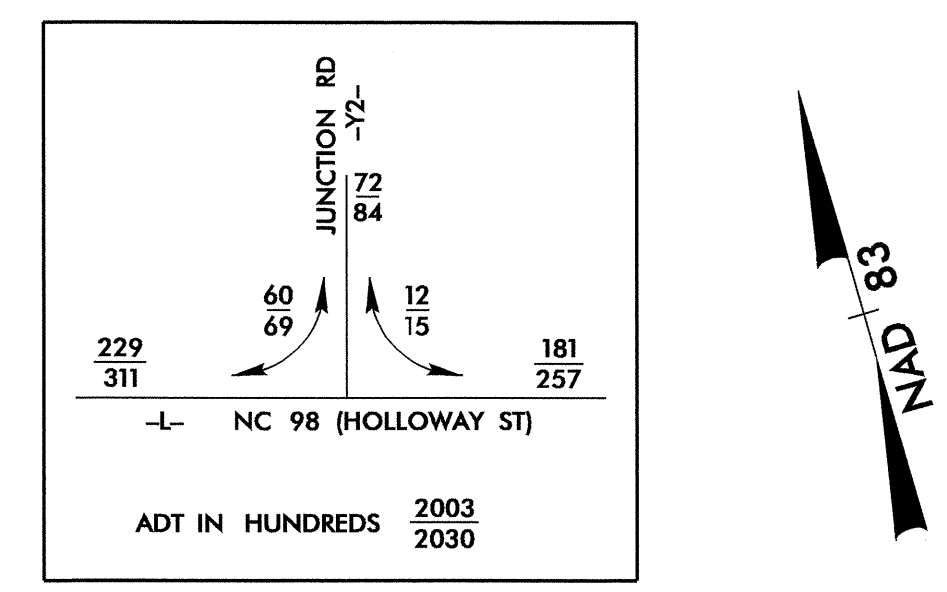

MATCHLINE SHEET 4
-L- STA. 22+50.000

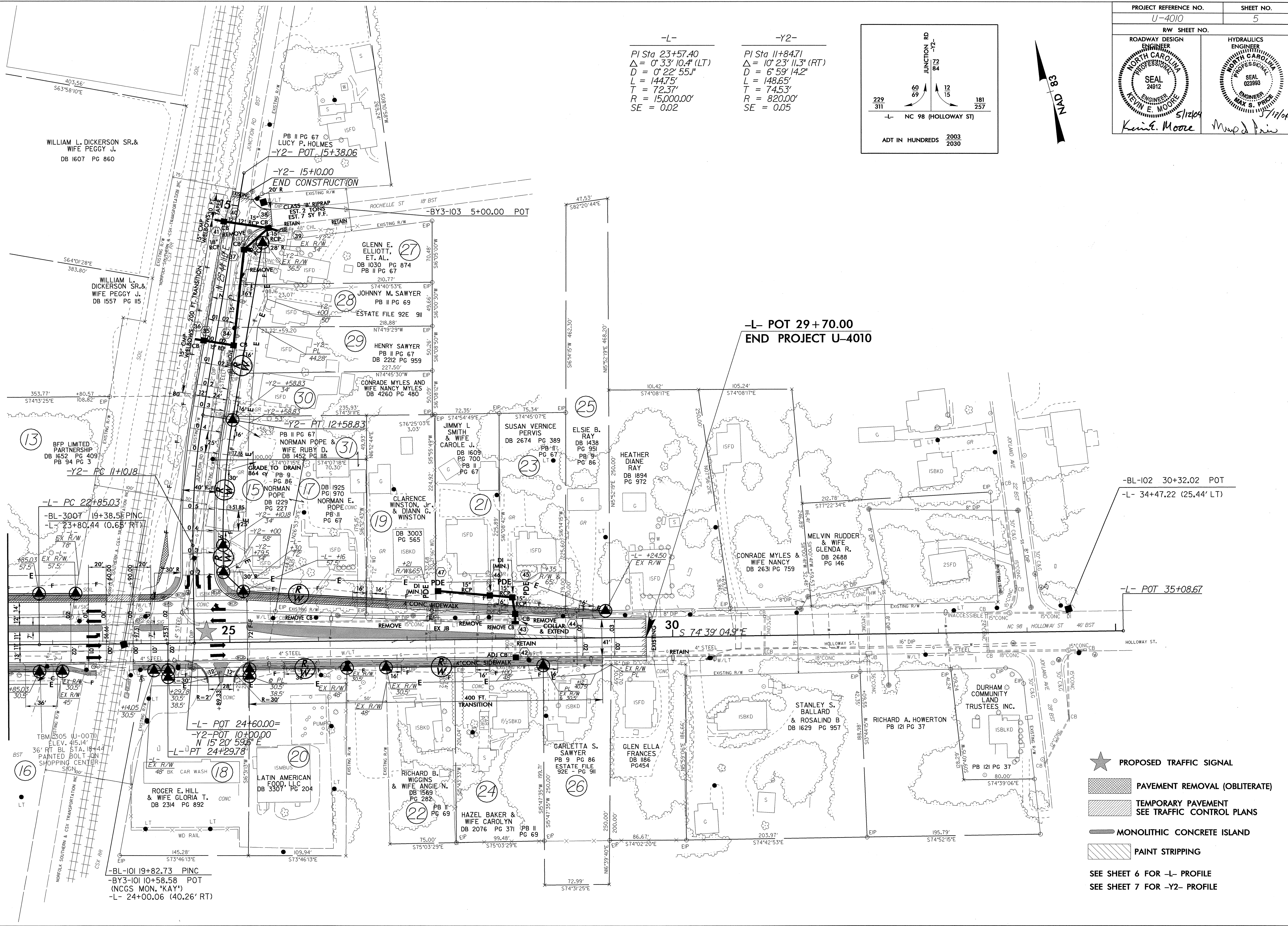

- ★ PROPOSED TRAFFIC SIGNAL
- ▨ PAVEMENT REMOVAL (OBLITERATE)
- ▨ TEMPORARY PAVEMENT
SEE TRAFFIC CONTROL PLANS
- ▬ MONOLITHIC CONCRETE ISLAND
- ▨ PAINT STRIPPING

SEE SHEET 6 FOR -L- PROFILE
SEE SHEET 7 FOR -Y2- PROFILE

12 MAY 2004 13:57
K:\NF-PJ\U4010\1302160
KMOORE