

PROJECT REFERENCE NO.	SHEET NO.
U-4010	EC-4/CONST.5
R/W SHEET NO.	
ROADWAY DESIGN ENGINEER	HYDRAULICS ENGINEER

CLEARING AND GRUBBING
EROSION CONTROL FOR
CONSTRUCTION SHEET 5

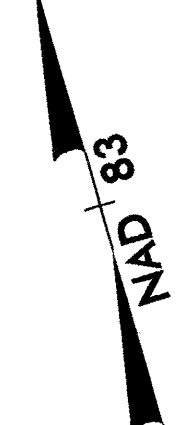
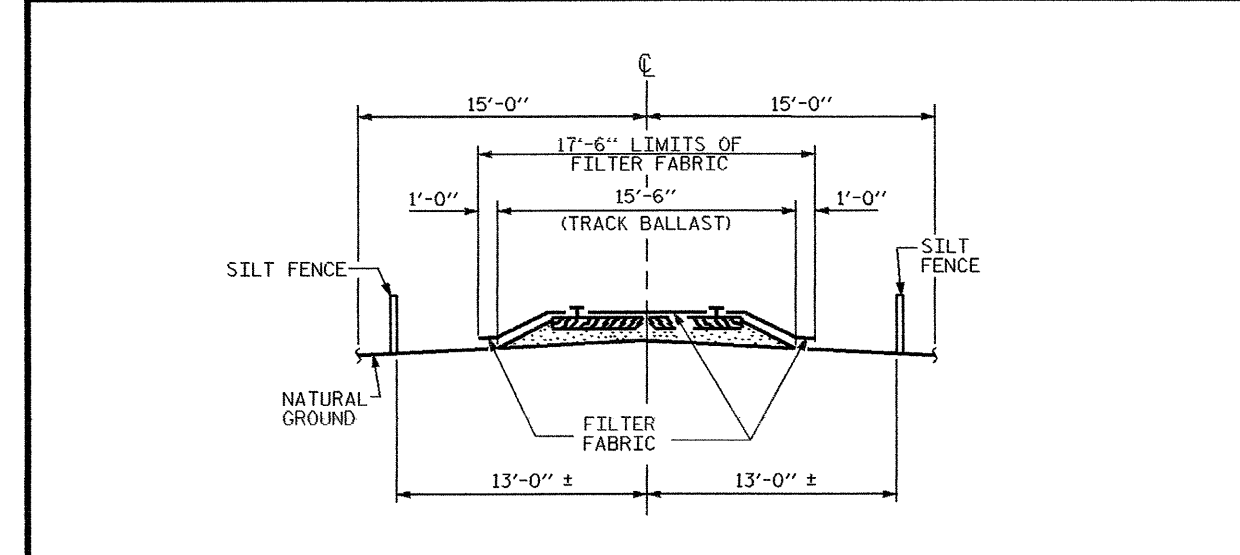

NOTES
RAILROAD EROSION CONTROL MEASURES SHALL BE INSTALLED PRIOR TO PERFORMING ANY WORK IN THE RAILROAD RIGHT-OF-WAY.
ADDITIONAL EROSION CONTROL MEASURES FOR PROTECTION OF RAILROAD DITCHES MAY BE REQUIRED AS DIRECTED BY THE ENGINEER.
NO SEPARATE PAYMENT WILL BE MADE FOR RAILROAD EROSION CONTROL MEASURES.
LIMITS OF SILT FENCE AND FILTER FABRIC PARALLEL TO RAILROAD SHALL EXTEND A MINIMUM OF 10'-0" OUTSIDE EDGE OF SUPERSTRUCTURE OR 10% OF SLOPE ON CONSTRUCTION. A GREATER LENGTH OF SILT FENCE OR FILTER FABRIC MAY BE REQUIRED IF SO DIRECTED BY THE ENGINEER.
FILTER FABRIC TO BE NAILED TO TIMBER RAIL TIES WITH PRIME SOURCE "GRIP CAP" OR EQUIVALENT. FILTER FABRIC ON SHOULDER TO BE SECURED AS DIRECTED BY THE ENGINEER AND RAILROAD.

NOTE:
PLACE TEMPORARY ROCK SEDIMENT DAMS TYPE-B
AND TEMPORARY ROCK SILT CHECKS TYPE-A AT
DRAINAGE OUTLETS.

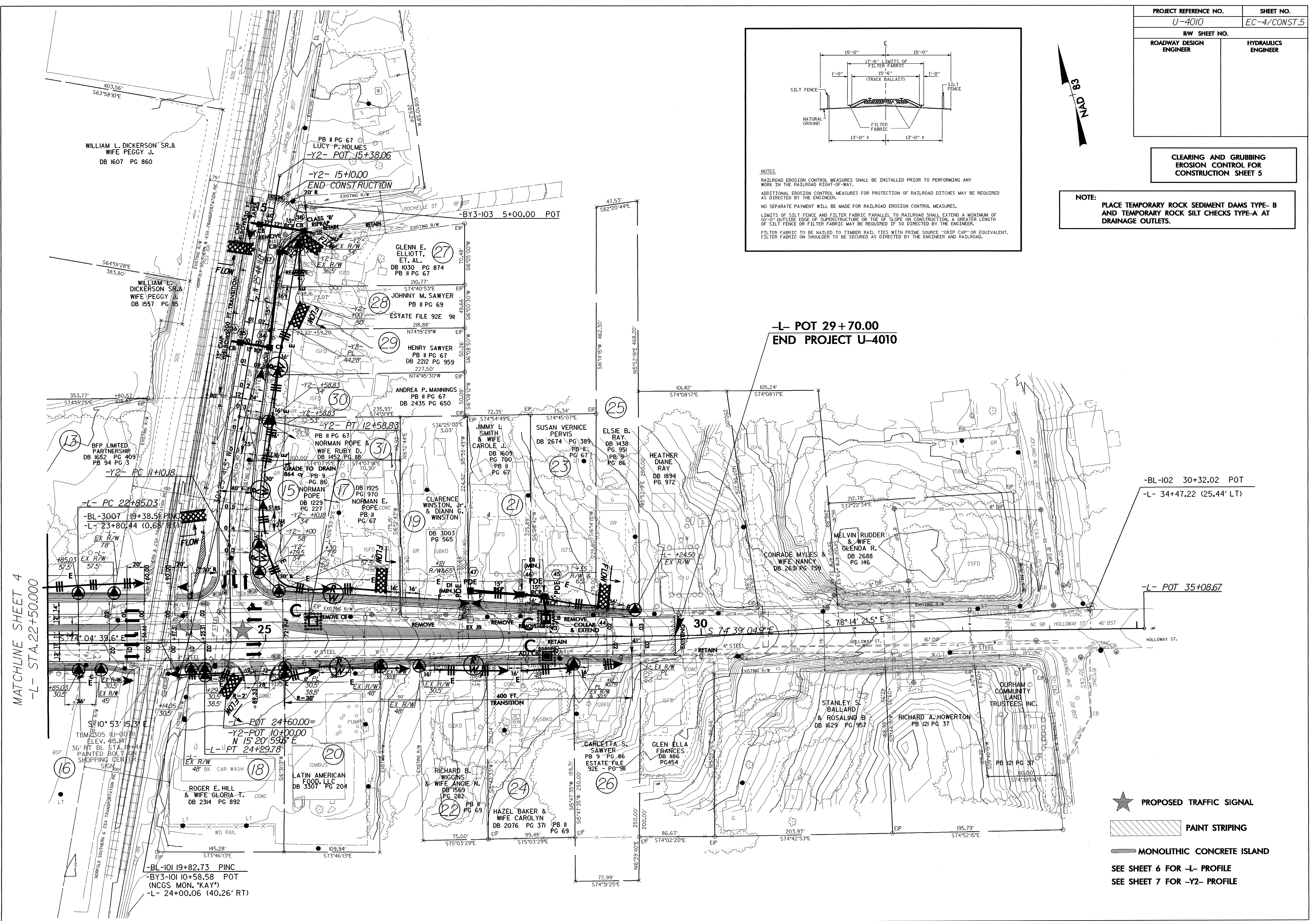

MATCHLINE SHEET 4
-L- STA. 22+50.00

-L- POT 29+70.00
END PROJECT U-4010

-BL-102 30+32.02 POT
-L- 34+47.22 (25.44' LT)

-L- POT 35+08.67

- PROPOSED TRAFFIC SIGNAL
- PAINT STRIPING
- MONOLITHIC CONCRETE ISLAND

SEE SHEET 6 FOR -L- PROFILE
SEE SHEET 7 FOR -Y2- PROFILE