

7/01/99

See Sheet 1-A For Index of Sheets
See Sheet 1-B For Conventional Symbols

STATE OF NORTH CAROLINA
DIVISION OF HIGHWAYS

CUMBERLAND COUNTY

**LOCATION: HOPE MILLS BYPASS
FROM SR 1141 (BINGHAM DRIVE)
TO SR 1363 (ELK ROAD)**
**TYPE OF WORK: GRADING, PAVING, DRAINAGE,
STRUCTURES, CULVERT, AND SIGNALS**

STATE	STATE PROJECT REFERENCE NO.	SHEET NO.	TOTAL SHEETS
N.C.	U-0620	1	
STATE PROJ. NO.	F.A. PROJ. NO.	DESCRIPTION	
34720.3.2	STP-0622(2)(5)	PE	
34720.3.2	ACSTP-0622(4)	ROW, UTL	
34720.3.2	STP-0622(5)	CONST	

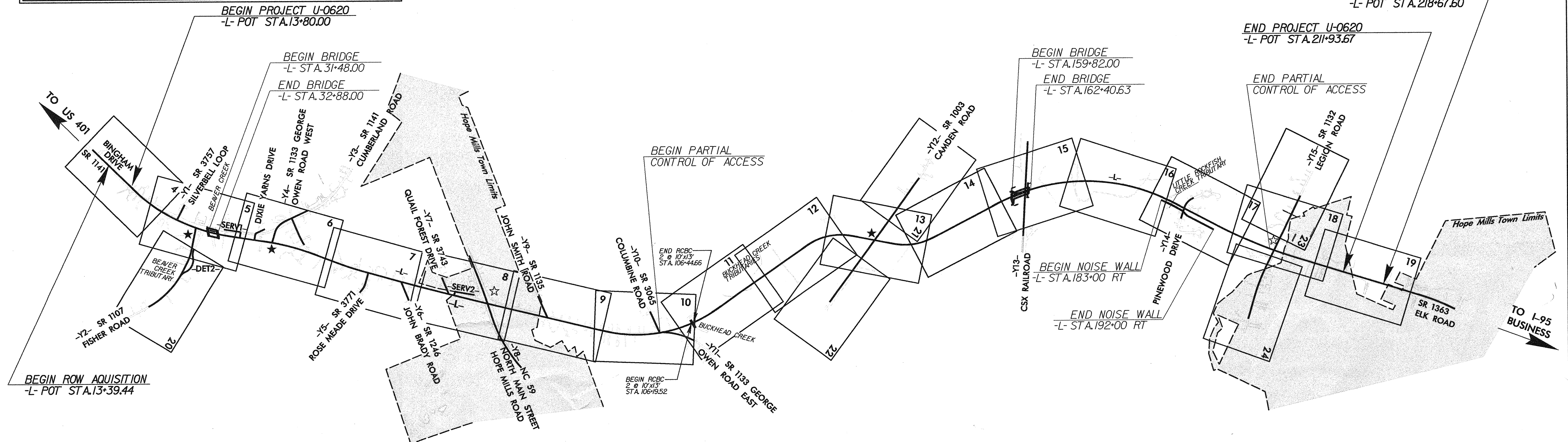
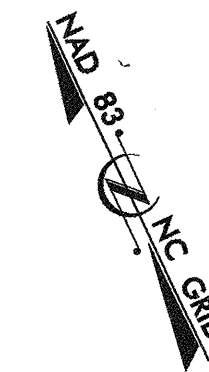
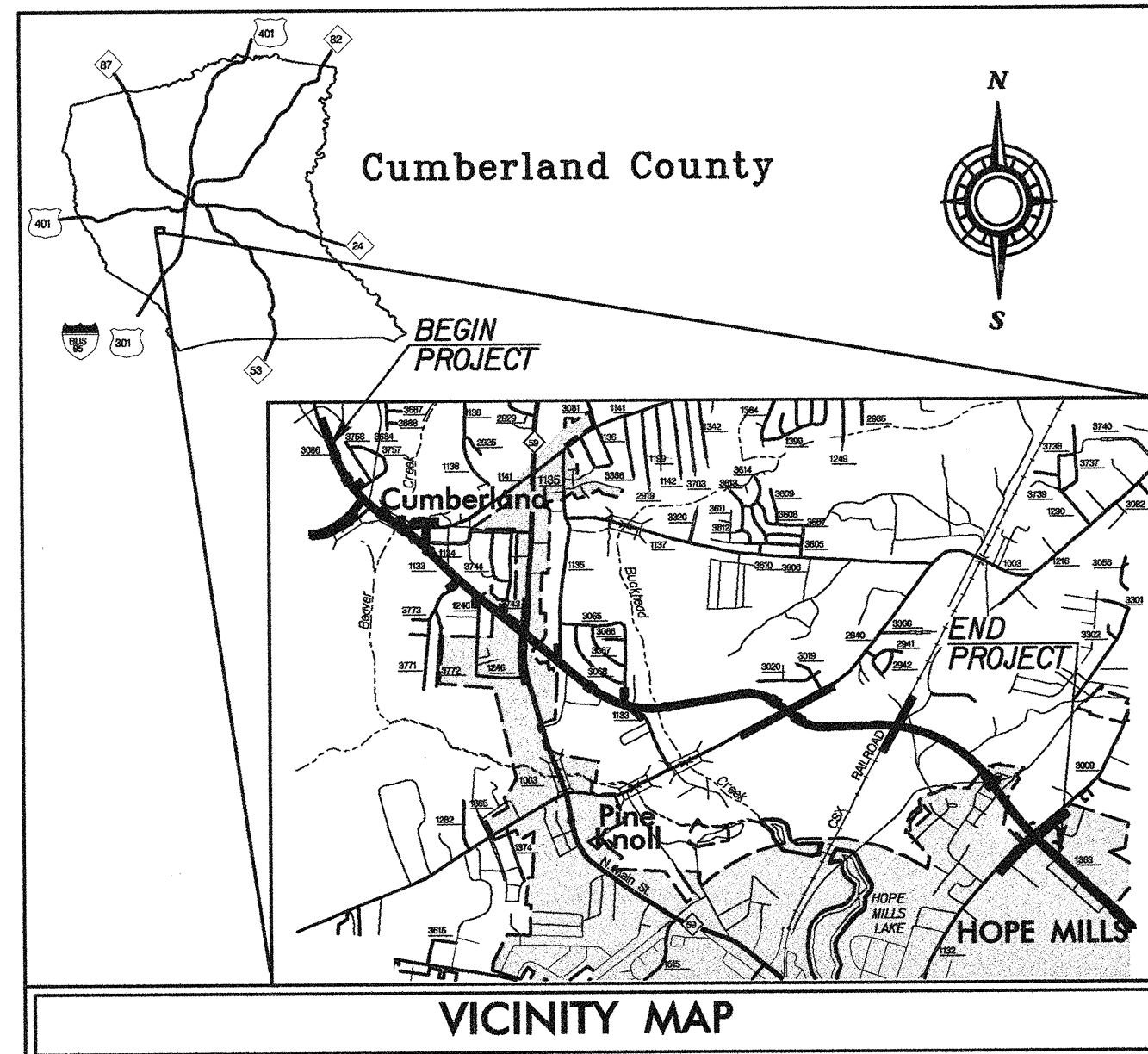

☆ UPGRADE SIGNAL
★ PROPOSED SIGNAL

NOTES: THIS IS A PARTIAL CONTROLLED-ACCESS PROJECT WITH ACCESS BEING LIMITED TO POINTS AS SHOWN ON THE PLANS BEGINNING AT -L- STA. 101+28.00 AND ENDING AT -L- STA. 200+82.89.

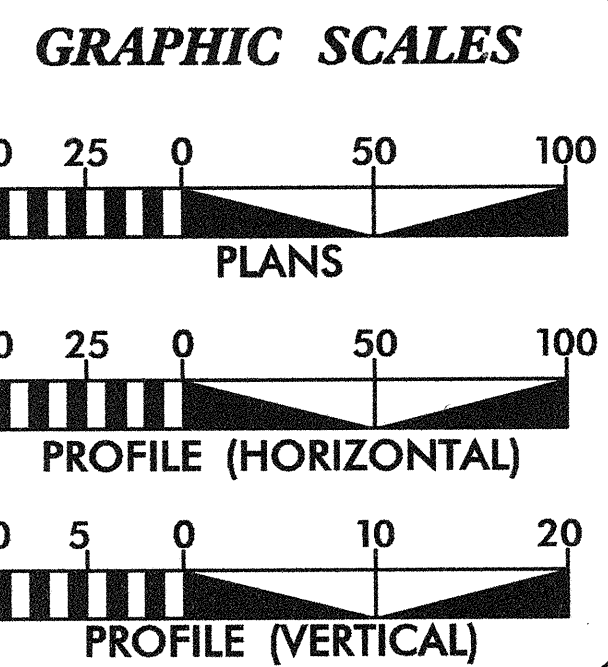

DESIGN DATA

ADT 2003 =	21300 VPD
ADT 2023 =	36600 VPD
DHV =	10 %
D =	60 %
T =	5 % *
V =	50 MPH
* DUAL 3 %	TTST 2 %

PROJECT LENGTH

LENGTH ROADWAY TIP PROJECT U-0620 =	3.673 Miles
LENGTH STRUCTURE TIP PROJECT U-0620 =	0.080 Miles
TOTAL LENGTH OF TIP PROJECT U-0620 =	3.753 Miles

PLANS PREPARED FOR NCDOT BY:

2002 STANDARD SPECIFICATIONS

RIGHT OF WAY DATE: FEBRUARY 15, 2002
LETTING DATE: SEPTEMBER 21, 2004

NCDOT CONTACT: CATHY S. HOUSER, PE
DESIGN SERVICES PROJECT ENGINEER

Carter-Burgess
Consultants in Planning, Engineering, Architecture, Construction Management and Related Services
5811 Glenwood Avenue, Suite 300
Raleigh, North Carolina 27612

R. DONALD HURLBUT, PE
ROADWAY GROUP MANAGER

A. DEAN SARVIS, PE
PROJECT DESIGN ENGINEER

CATHY S. HOUSER, PE
DESIGN SERVICES PROJECT ENGINEER

HYDRAULICS ENGINEER

ROADWAY DESIGN ENGINEER

DIVISION OF HIGHWAYS STATE OF NORTH CAROLINA

DEPARTMENT OF TRANSPORTATION FEDERAL HIGHWAY ADMINISTRATION

APPROVED DIVISION ADMINISTRATOR

03:02:00 PM C:\Users\RDY\OneDrive\Projects\U0620\RDY_TSH.DGN 8/16/2004

PROJECT: U-0620 C200823