

SEE SHEET 29 FOR -L- PROFILE
ALL DRIVEWAYS ARE 20' WIDE
UNLESS OTHERWISE NOTED

PROJECT REFERENCE NO. U-0620		SHEET NO. 12	
RW SHEET NO.			
ROADWAY DESIGN ENGINEER DONALD HURD 7/26/04		HYDRAULICS ENGINEER SEAL 18442 7-28-04	
Carter-Burgess Consultants in Planning, Engineering, Architecture, Construction Management and Related Services 5811 Glenwood Avenue, Suite 300 Raleigh, North Carolina 27612 OFFICE 919-873-2401 FAX 919-873-2404			
TRANSITE CONSULTING ENGINEERS, INCORPORATED ENGINEERS + PLANNERS + CEI 1300 Paddock Drive, Suite G-10 Raleigh, N.C. 27609 OFFICE 919-873-2401 FAX 919-873-2404			

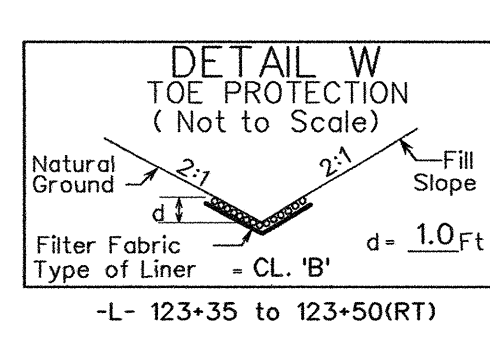
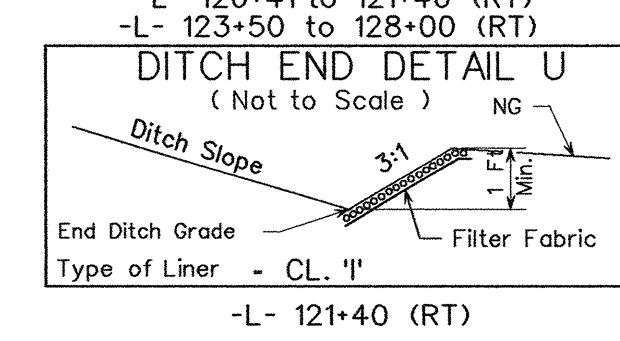
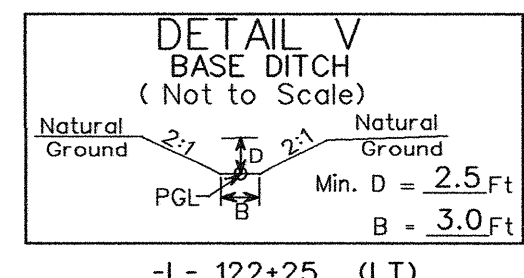
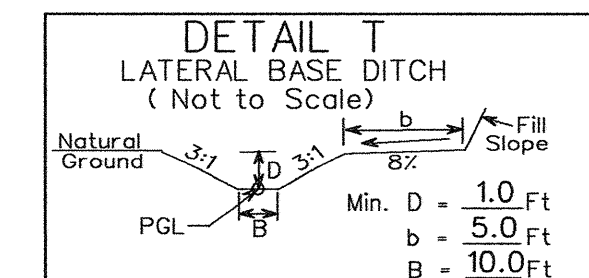
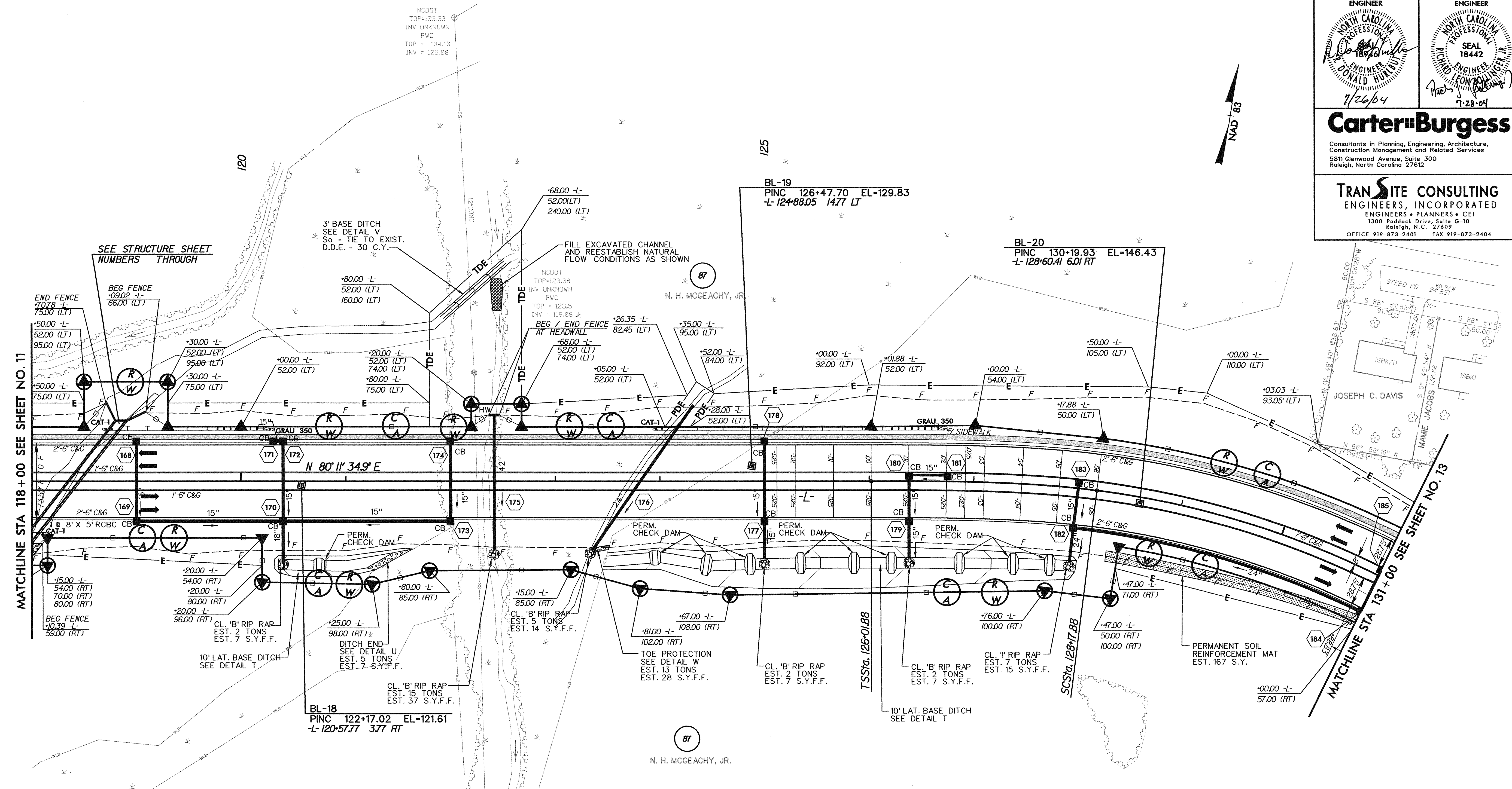

Sta	Δs	D	L	T	R	SE	INC
Pls Sta 127+46.00	7' 17" 240"	6' 45" 00"	467.13'	239.64'	848.83'	0.060	36
Pl Sta 130+57.52	3' 31' 53.1" (RT)	6' 45" 00"	467.13'	239.64'	848.83'	0.060	36
Pls Sta 133+57.12	7' 17" 240"	6' 45" 00"	467.13'	239.64'	848.83'	0.060	36

- 5' MONOLITHIC ISLAND (KEYED IN) & SIDEWALK
- PAINT STRIPED LANE CLOSURE
- PAVEMENT REMOVAL

7/2/99
12:55:38 PM P:\proj\0620_rdy_psh_12.dgn
07/23/2004