

PROJECT REFERENCE NO. U-0620		SHEET NO. 14	
RW SHEET NO.			
ROADWAY DESIGN ENGINEER <i>Donald H. Hulse</i> DONALD HULSE 7/26/04		HYDRAULICS ENGINEER <i>Leon R. Hulse</i> LEON R. HULSE 7-28-04	
 			
<b>Carter-Burgess</b> Consultants in Planning, Engineering, Architecture, Construction Management and Related Services 5811 Glenwood Avenue, Suite 300 Raleigh, North Carolina 27612			
<b>TRANSITE CONSULTING</b> ENGINEERS, INCORPORATED ENGINEERS • PLANNERS • CEI 1300 Piedmont Drive, Suite G-10 Raleigh, N.C. 27609 OFFICE 919-873-2401 FAX 919-873-2404			

-L-			-L-		
PIs Sta 140+87.35	PI Sta 143+40.32	PIs Sta 145+88.17	PIs Sta 157+68.32	PI Sta 172+07.60	PIs Sta 184+58.60
Os = 7' 17" 24.0"	Δ = 24' 05" 09.8" (LT)	Os = 7' 17" 24.0"	Os = 7' 45" 00.0"	Δ = 51' 28" 19.8" (RT)	Os = 7' 45" 00.0"
Ls = 216.00'	D = 6' 45" 00.0"	Ls = 216.00'	Ls = 175.00'	D = 2' 00" 00.0"	Ls = 175.00'
LT = 144.12'	L = 356.83'	LT = 144.12'	LT = 116.67'	L = 2573.61'	LT = 116.67'
ST = 72.11'	T = 181.09'	ST = 72.11'	ST = 58.34'	T = 1,380.95'	ST = 58.34'
	R = 848.83'			R = 2,864.79'	
	SE = 0.060			SE = 0.035	
	INC = 36			INC = 50	

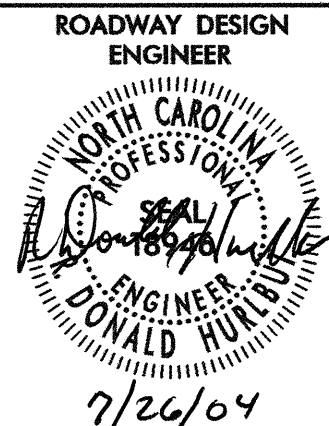
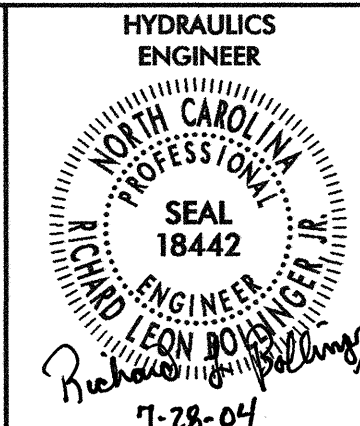
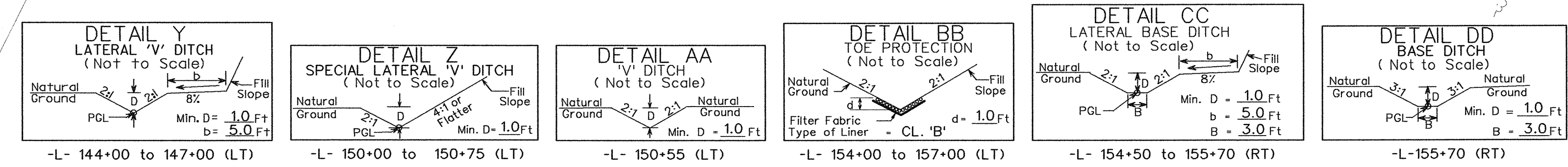
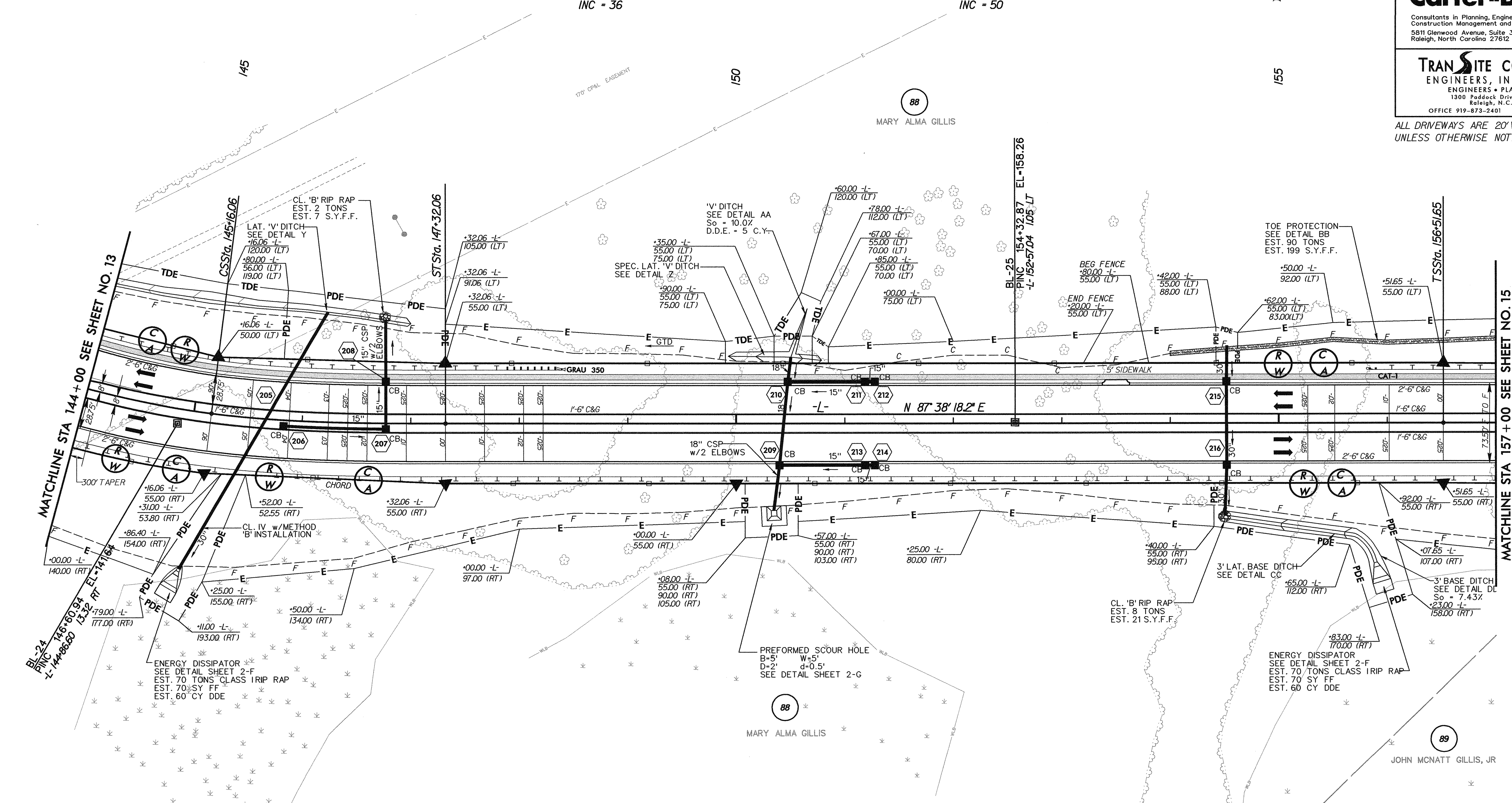

 5' MONOLITHIC ISLAND (KEYED IN) & SIDEWALK  
 PAINT STRIPED LANE CLOSURE  
 PAVEMENT REMOVAL

7/2/09  
 12:55:40 PM  
 C:\pwworking\proj\0620\_rdy-psh\_14.dgn  
 07/23/2004