

5/28/99

SEE SHEET 6 FOR -Y4- PLAN

SEE SHEET 7 FOR -Y5- PLAN

PROJECT REFERENCE NO. U-0620		SHEET NO. 34	
ROADWAY DESIGN ENGINEER		HYDRAULICS ENGINEER	
Carter-Burgess Consultants in Planning, Engineering, Architecture, Construction Management and Related Services 5811 Glenwood Avenue, Suite 300 Raleigh, North Carolina 27612			
TRANSITE CONSULTING ENGINEERS, INCORPORATED ENGINEERS • PLANNERS • CEI 1300 Paddock Drive, Suite G-10 Raleigh, N.C. 27609 OFFICE 919-873-2401 FAX 919-873-2404			

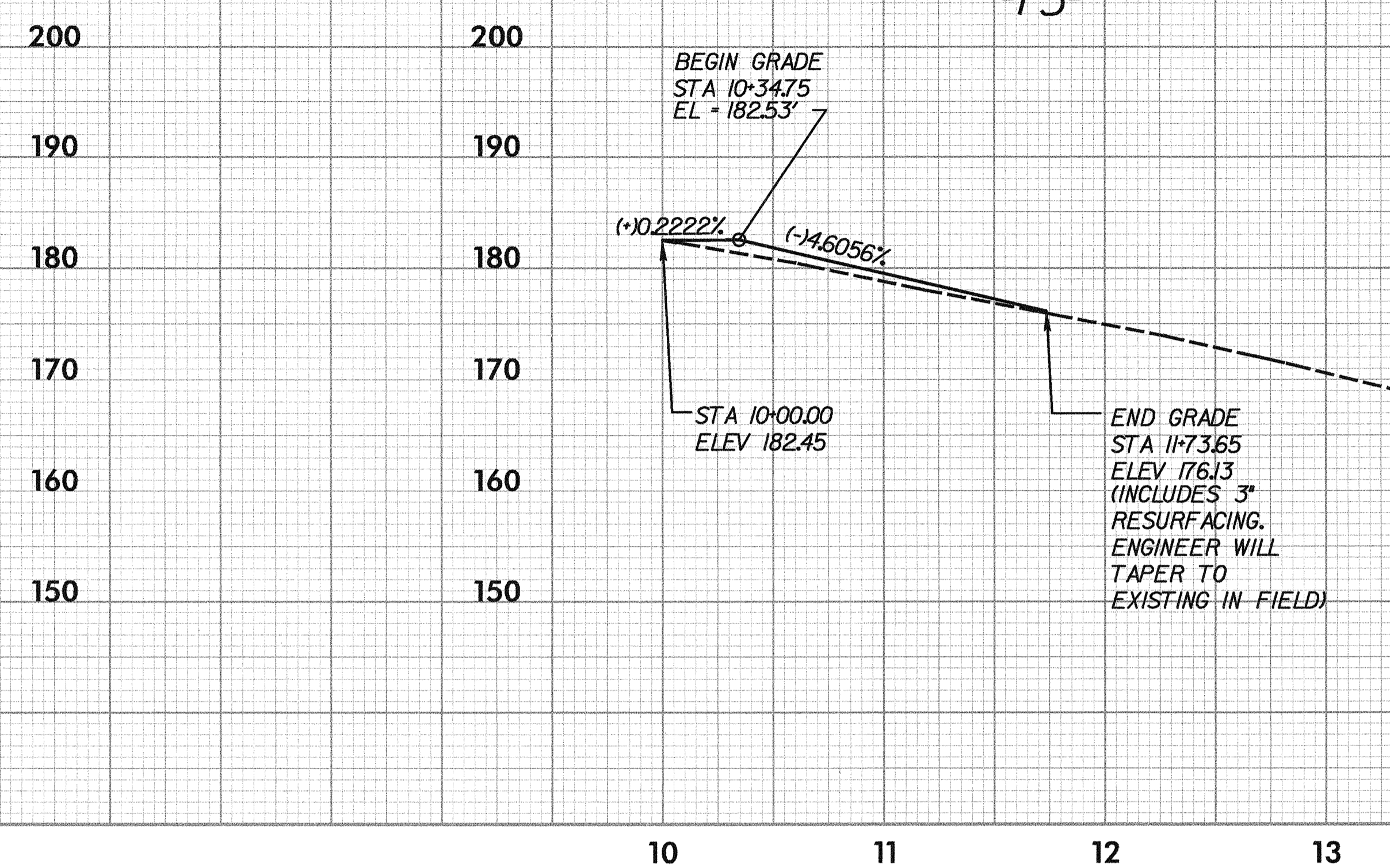
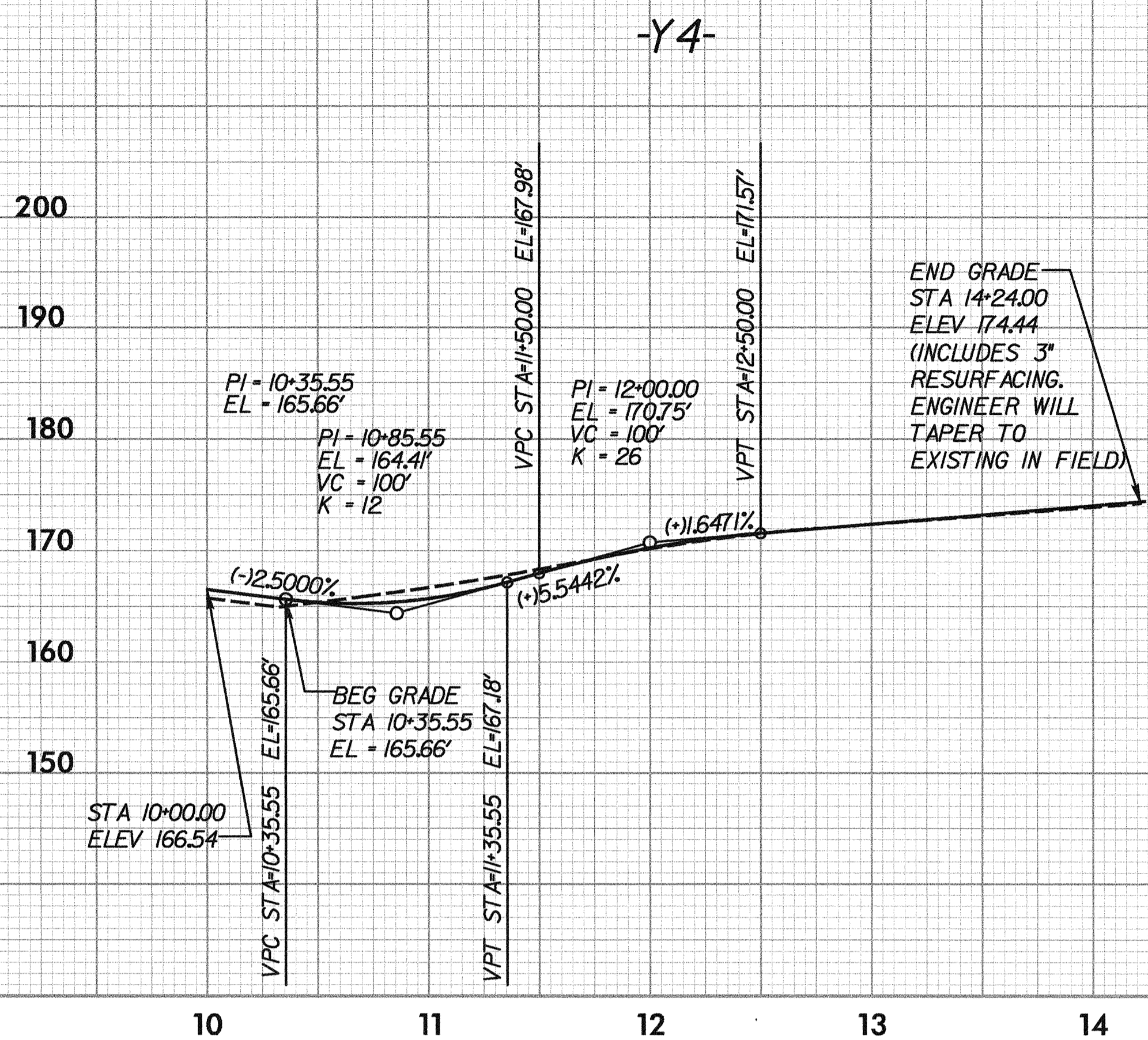

SEE SHEET 7 FOR -Y6- PLAN

SEE SHEET 8 FOR -Y7- PLAN

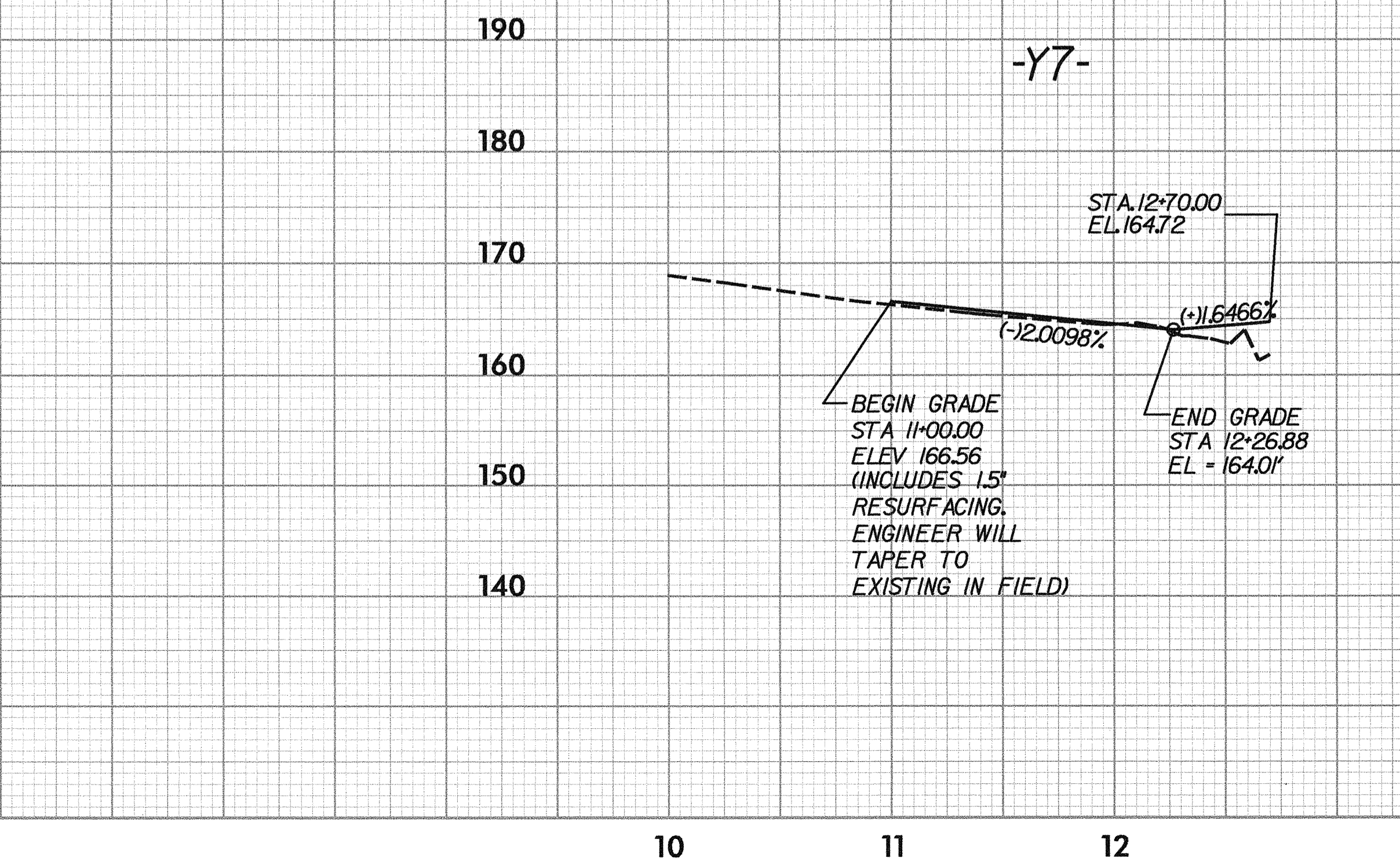
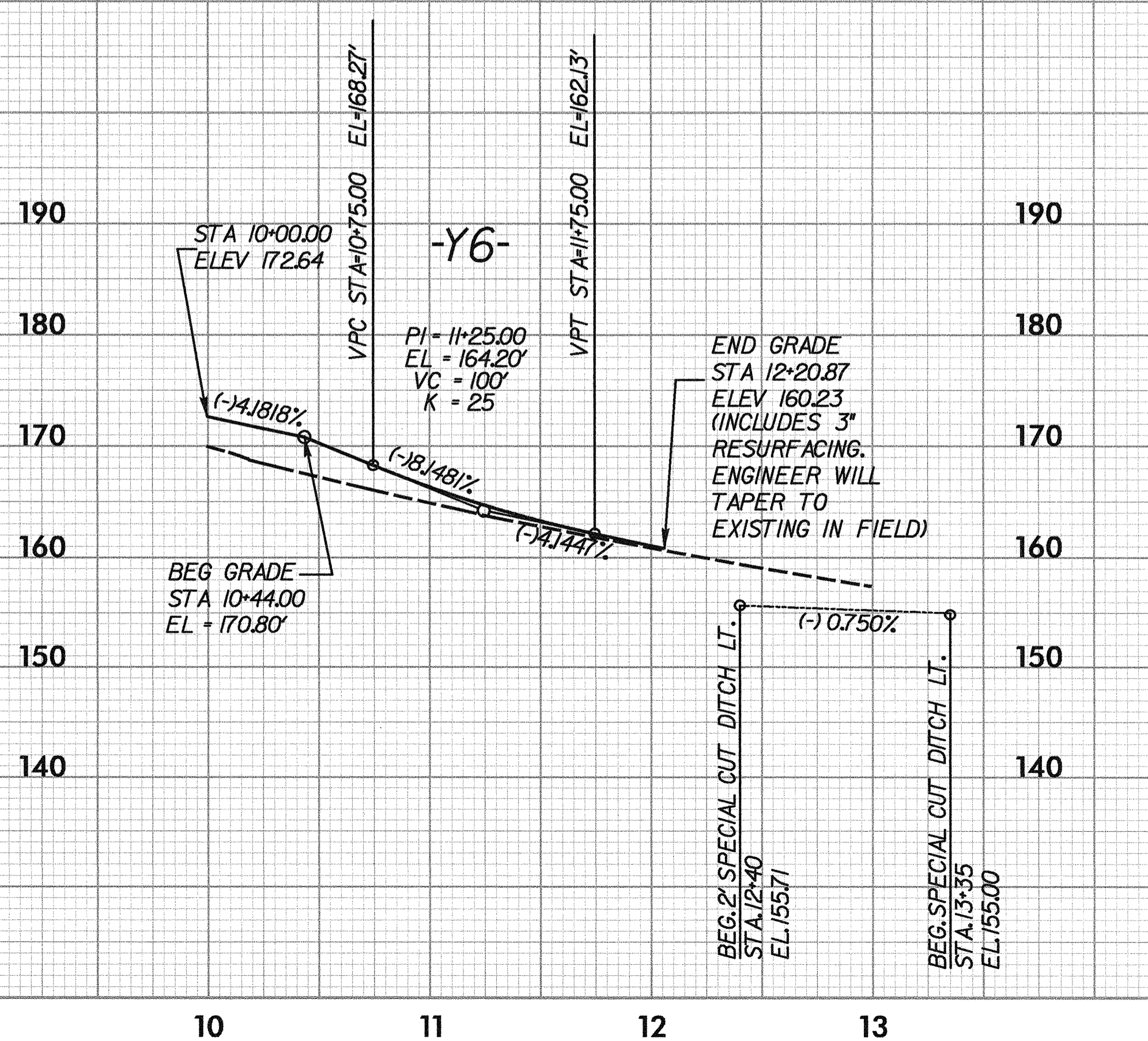

r:\v-road\p0620\p0620.dwg 01/08/97 PM 04:27:20