

REINFORCING STEEL BAR SCHEDULE (STAGE II)																	
BAR	NO.	SIZE	TYPE	LENGTH	WEIGHT	BAR	NO.	SIZE	TYPE	LENGTH	WEIGHT	BAR	NO.	SIZE	TYPE	LENGTH	WEIGHT
* A5	243	#5	STR	32'-10"	8322	* A518	2	#5	STR	27'-9"	58	* D2	80	#4	STR	0'-8"	36
A6	243	#5	STR	32'-10"	8322	* A519	2	#5	STR	25'-7"	53						
						* A520	2	#5	STR	23'-6"	49						
* A501	2	#5	STR	30'-9"	64	* A521	2	#5	STR	21'-6"	45	* E1	4	#7	1	3'-5"	28
* A502	2	#5	STR	28'-9"	60	* A522	2	#5	STR	19'-5"	41	* E2	4	#7	1	4'-0"	33
* A503	2	#5	STR	26'-9"	56	* A523	2	#5	STR	17'-4"	36	* E3	4	#7	1	4'-7"	37
* A504	2	#5	STR	24'-9"	52	* A524	2	#5	STR	15'-3"	32	* E4	4	#7	1	5'-1"	42
* A505	2	#5	STR	22'-9"	47	* A525	2	#5	STR	13'-2"	27						
* A506	2	#5	STR	20'-8"	43	* A526	2	#5	STR	11'-2"	23	* F1	2	#6	STR	2'-10"	9
* A507	2	#5	STR	18'-8"	39	* A527	2	#5	STR	9'-1"	19	* F2	4	#6	STR	3'-9"	23
* A508	2	#5	STR	16'-8"	35	* A528	2	#5	STR	7'-0"	15	* F3	2	#6	STR	4'-0"	12
* A509	2	#5	STR	14'-8"	31	* A529	2	#5	STR	4'-11"	10	* F4	2	#6	STR	2'-5"	7
* A510	2	#5	STR	12'-7"	26	* A530	2	#5	STR	2'-10"	6	* F5	4	#6	STR	3'-5"	21
* A511	2	#5	STR	10'-7"	22							* F6	2	#6	STR	3'-8"	11
* A512	2	#5	STR	8'-7"	18	A616	2	#5	STR	31'-9"	66						
* A513	2	#5	STR	6'-7"	14	A617	2	#5	STR	29'-9"	62	* G2	2	#5	STR	36'-0"	75
* A514	2	#5	STR	4'-7"	10	A618	2	#5	STR	27'-8"	58	* G3	139	#4	STR	6'-2"	573
* A515	2	#5	STR	2'-7"	5	A619	2	#5	STR	25'-7"	53						
						A620	2	#5	STR	23'-6"	49	* K1	8	#8	2	12'-7"	269
A601	2	#5	STR	30'-9"	64	A621	2	#5	STR	21'-6"	45	* K2	8	#8	3	20'-7"	440
A602	2	#5	STR	28'-9"	60	A622	2	#5	STR	19'-5"	41	* K3	18	#6	STR	8'-4"	225
A603	2	#5	STR	26'-9"	56	A623	2	#5	STR	17'-4"	36	K4	6	#5	STR	7'-10"	49
A604	2	#5	STR	24'-9"	52	A624	2	#5	STR	15'-3"	32	K5	6	#5	4	8'-4"	52
A605	2	#5	STR	22'-9"	47	A625	2	#5	STR	13'-2"	27	K6	16	#4	5	6'-8"	71
A606	2	#5	STR	20'-8"	43	A626	2	#5	STR	11'-2"	23	K7	16	#4	6	12'-4"	132
A607	2	#5	STR	18'-8"	39	A627	2	#5	STR	9'-1"	19	K8	12	#4	STR	8'-5"	67
A608	2	#5	STR	16'-8"	35	A628	2	#5	STR	7'-0"	15	K9	12	#4	STR	9'-3"	74
A609	2	#5	STR	14'-8"	31	A629	2	#5	STR	4'-11"	10	K10	12	#4	STR	9'-0"	72
A610	2	#5	STR	12'-7"	26	A630	2	#5	STR	2'-10"	6	K11	12	#4	STR	6'-7"	53
A611	2	#5	STR	10'-7"	22												
A612	2	#5	STR	8'-7"	18	* B1	46	#4	STR	25'-6"	784	* S1	48	#5	7	5'-0"	250
A613	2	#5	STR	6'-7"	14	B2	129	#6	STR	47'-8"	9236	* S2	48	#4	8	3'-4"	107
A614	2	#5	STR	4'-7"	10	* B3	30	#4	STR	29'-9"	596	S3	24	#4	9	6'-1"	98
A615	2	#5	STR	2'-7"	5	* B4	88	#6	STR	40'-6"	5353	* S4	12	#4	3	9'-6"	76
						* B5	86	#6	STR	15'-3"	1970	* S5	36	#4	3	11'-6"	277
* A516	2	#5	STR	31'-9"	66	* B6	23	#4	STR	25'-9"	396	S6	132	#4	10	2'-9"	242
* A517	2	#5	STR	29'-9"	62												
REINFORCING STEEL = 19532 LBS																	
* EPOXY COATED REINF. STEEL = 21036 LBS																	

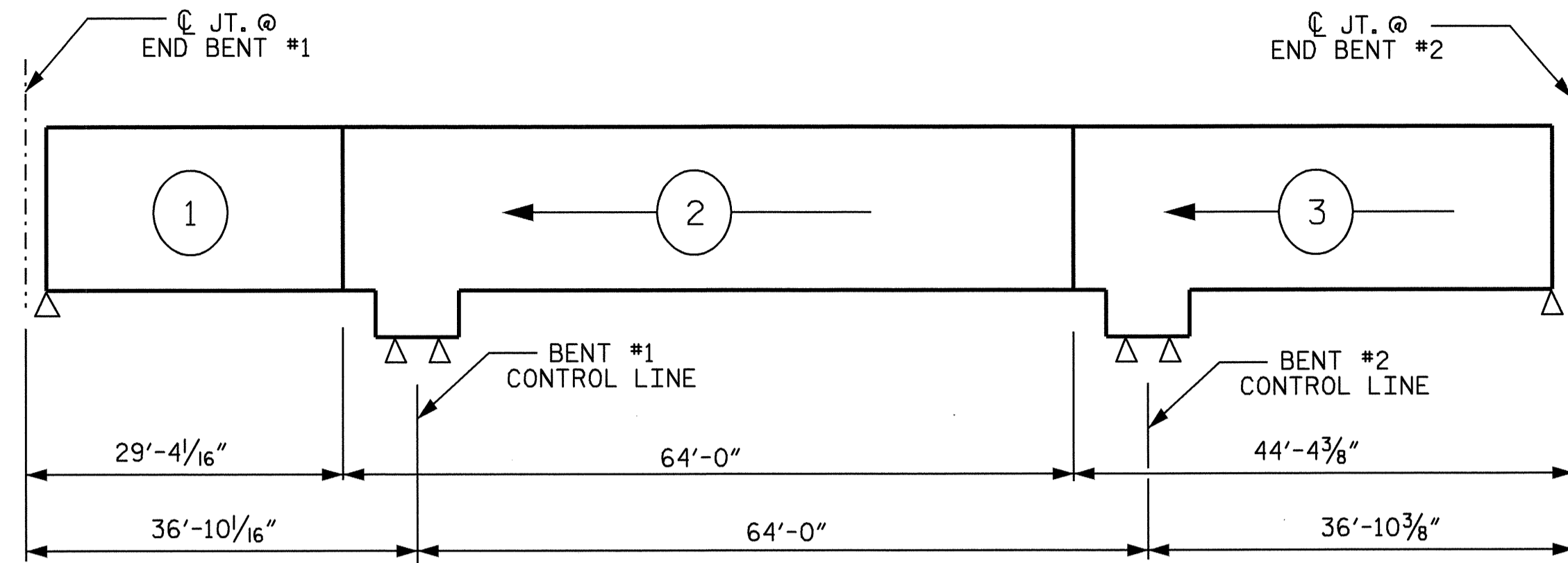

CONTINUOUS FOR LIVE LOAD
POURING SEQUENCE

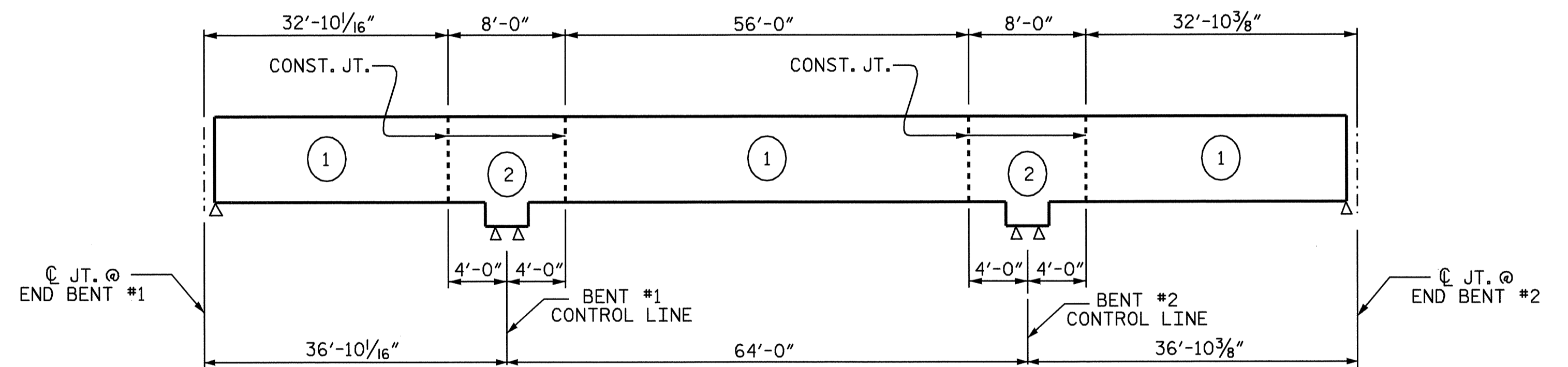

CONTINUOUS FOR LIVE LOAD
OPTIONAL POURING SEQUENCE

TOTAL SUPERSTRUCTURE BILL OF MATERIAL							
	CLASS AA CONCRETE (CU. YDS.)					REINFORCING STEEL (LBS.)	EPOXY COATED REINFORCING STEEL (LBS.)
	POUR #1	POUR #2	POUR #3	POUR #4 (SIDEWALK)	POUR #5 (CONCRETE ISLAND)		
STAGE I	76.7	186.6	139.8	17.5	8.2	428.8	46586
STAGE II	33.8	81.1	59.8	25.8	—	200.5	19532
TOTALS						629.3	66118

PROJECT NO. U-0620
CUMBERLAND COUNTY
 STATION: 32+18.00 -L-

SHEET 2 OF 2

STATE OF NORTH CAROLINA
 DEPARTMENT OF TRANSPORTATION
 RALEIGH

SUPERSTRUCTURE
 BILL OF MATERIAL

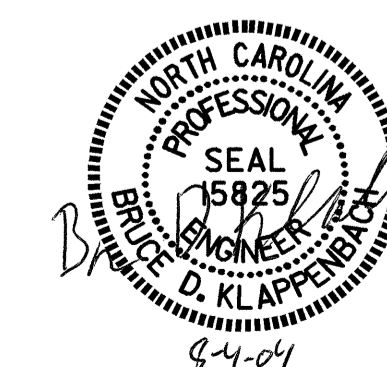

REVISIONS						SHEET NO.
NO.	BY:	DATE:	NO.	BY:	DATE:	S-29
1			3			TOTAL SHEETS
2			4			129

DRAWN BY: M. G. SHAIKH DATE: 5-28-03
 CHECKED BY: D. A. GLADDEN DATE: 07-03