

PLAN

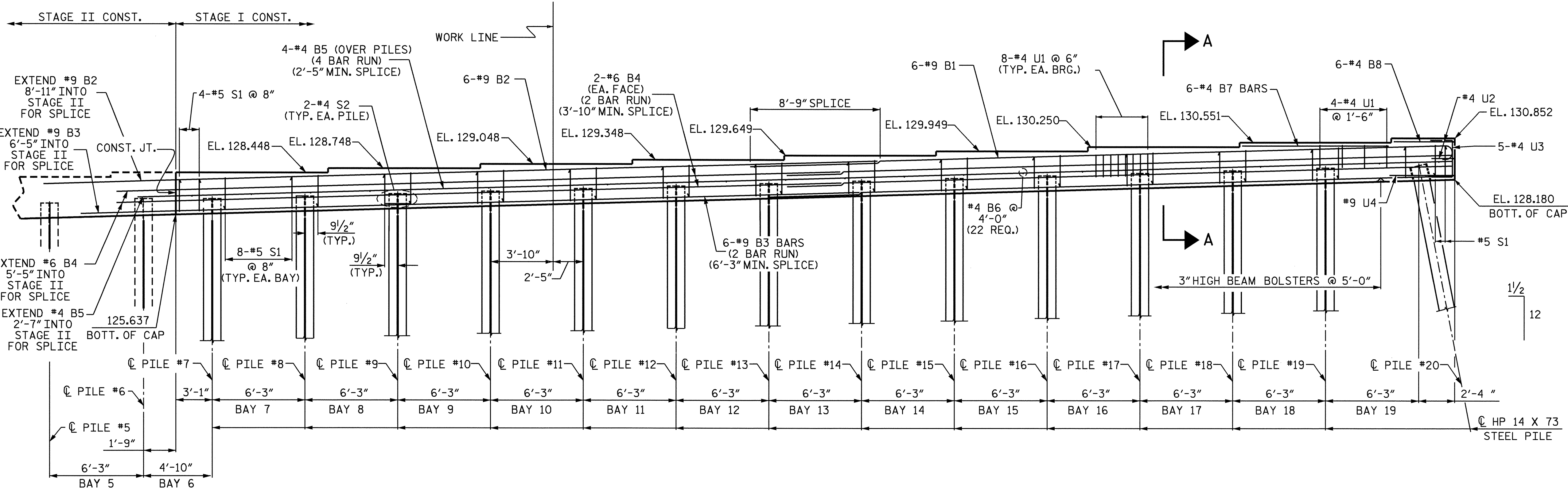

ELEVATION

*PILES 5 & 6 SHALL BE DRIVEN DURING STAGE I CONSTRUCTION
NOTE: INVERT ALTERNATE STIRRUPS

NOTES:
STIRRUPS IN CAP MAY BE SHIFTED AS NECESSARY TO CLEAR ANCHOR BOLTS.
"U" BARS IN THE END OF CAP MAY BE SHIFTED SLIGHTLY TO CLEAR "B" BARS.
THE CONTRACTOR'S ATTENTION IS CALLED TO THE FACT THAT THE CENTERLINE OF THE BENT IS OFFSET FROM THE BENT CONTROL LINE.

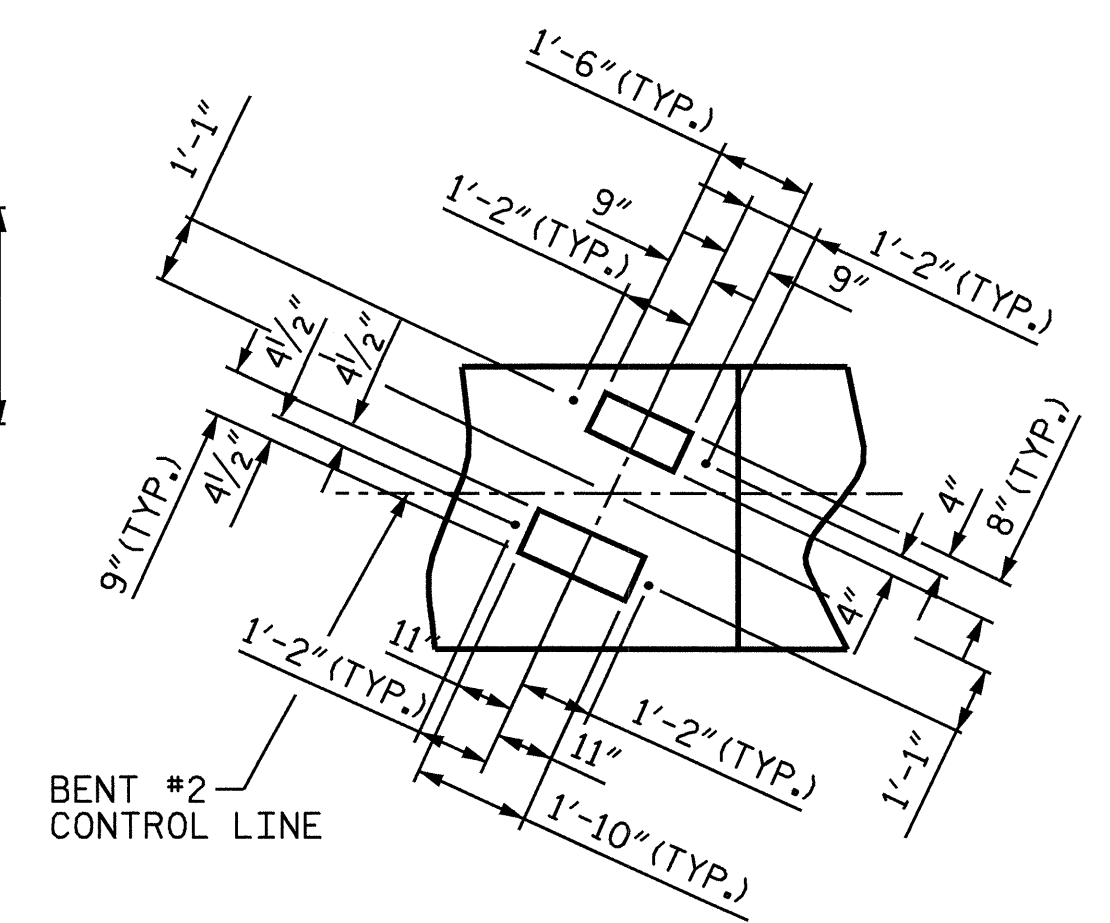

DETAIL "A"

TOP OF PILE ELEV.	
PILE No.	TOP OF PILE ELEV.
#7	126.727
#8	126.911
#9	127.094
#10	127.278
#11	127.461
#12	127.644
#13	127.828
#14	128.011
#15	128.195
#16	128.378
#17	128.561
#18	128.745
#19	128.928
#20	128.111

PROJECT NO. U-0620
CUMBERLAND COUNTY
STATION: 32+18.00 -L-

SHEET 1 OF 3
STATE OF NORTH CAROLINA
DEPARTMENT OF TRANSPORTATION
RALEIGH
SUBSTRUCTURE
BENT #2
(STAGE I)

REVISIONS					SHEET NO.
NO.	BY:	DATE:	NO.	BY:	DATE:
1			3		
2			4		

TOTAL SHEETS: 129

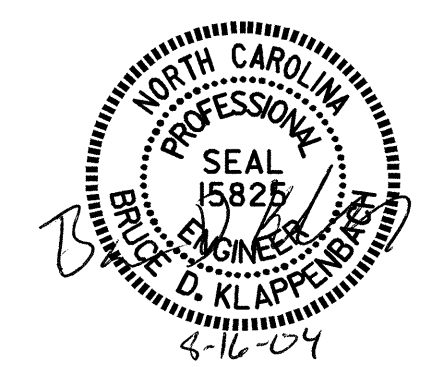

DRAWN BY: J.B. WILSON DATE: 1/04
CHECKED BY: M.G. SHAIKH DATE: 2/04