

HORIZONTAL CURVE DATA

PI. STA. 172+07.60
 $\Delta = 51^\circ-28'-19.8"$ (RT)
 $D = 2^\circ-00'-00"$
 $L = 2573.61'$
 $T = 1380.95'$
 $R = 2864.79'$
 $SE = 0.035$

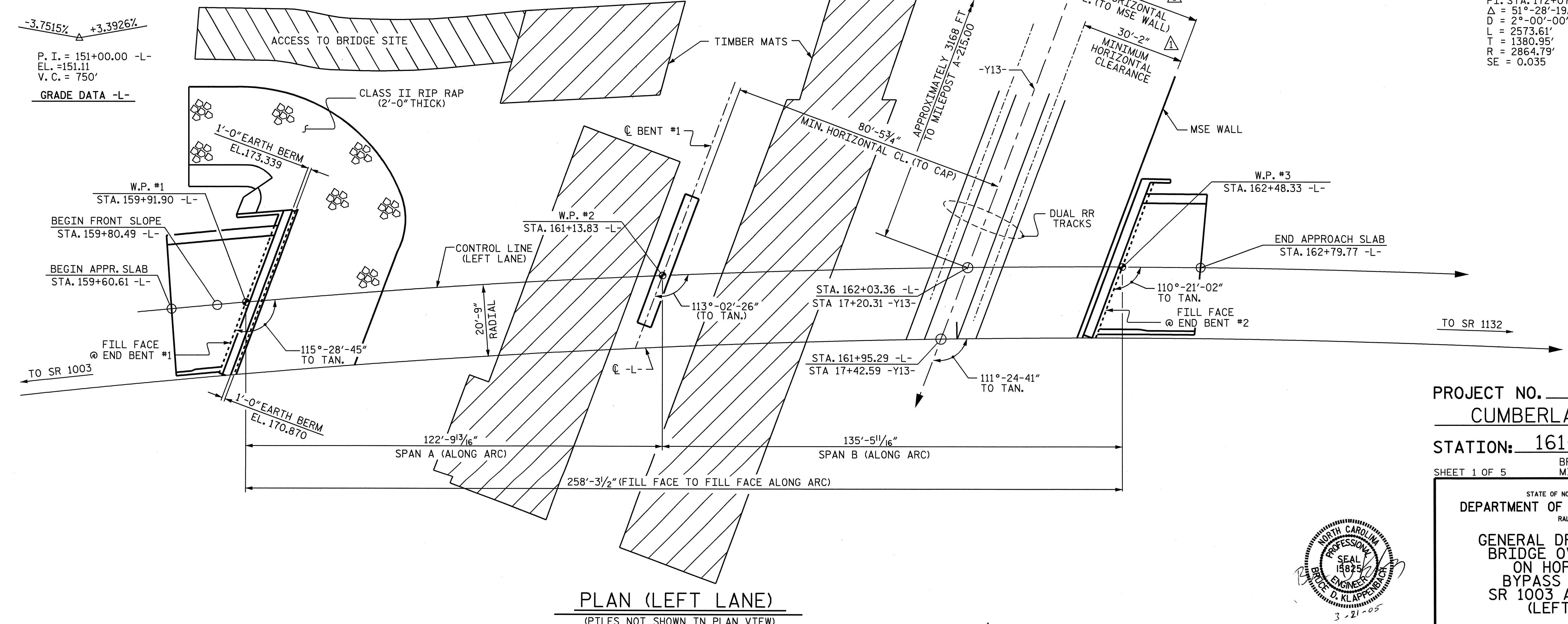

PROJECT NO. U-0620
CUMBERLAND COUNTY
 STATION: 161+95.29 -L-
 SHEET 1 OF 5
 BRIDGE No. 348
 MILEPOST A-215.60

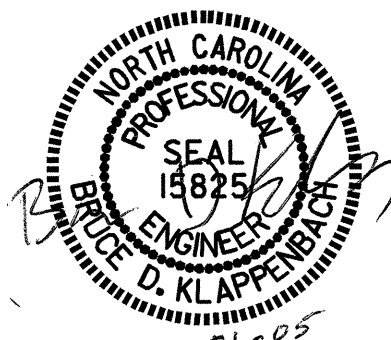

REVISION : REVISED MINIMUM HORIZONTAL CLEARANCE.
 CHANGE BRACE PILES TO VERTICAL PILES AT END BENT #2.
 BY : JBW CHECKED BY : BDK

DRAWN BY : M. G. SHAIKH DATE : 11-13-02
 CHECKED BY : A. K. PASCHAL DATE : 12-12-02

REVISIONS					SHEET NO.
NO.	BY	DATE	NO.	BY	DATE
1	JBW	3/14/05	3		
2			4		

TOTAL SHEETS: 129