

REVISIONS

12/18/02
 CONVERTED TEMPORARY CONSTRUCTION EASEMENT TO PERMANENT UTILITY EASEMENT ON PARCELS 10,14,15,16, AND 17.
 4/15/03 NEW PROPERTY LINES ON PARCEL 10,14 AND 16 NAME AND DEED BOOK CHANGES ON PARCELS 10 AND 14
 UPDATED RIGHT OF WAY AREA DATA SHEET TO REFLECT CHANGES.
 7/2/03 MOVED ROW MARKER FROM 34+00 TO 34+10 ON PARCEL 18

PROJECT REFERENCE NO. U-0620		SHEET NO. EC-29/CONST.5	
RW SHEET NO.			
ROADWAY DESIGN ENGINEER		HYDRAULICS ENGINEER	

NOTE:
 UTILIZE TEMPORARY ROCK SEDIMENT DAM TYPE - B AND/OR TEMPORARY ROCK SILT CHECK TYPE A AS STILLING BASIN WHERE APPLICABLE.

-L-
 Pls Sta 24+15.30
 $\phi_s = 1' 29'' 59.8''$
 $\phi_s = 1' 52'' 30.2''$
 $L_s = 150.00'$
 $LT = 77.80'$
 $ST = 72.24'$

-Y2-
 Pls Sta 29+53.55
 $\Delta = 18' 15'' 47.5''$
 $D = 2' 00'' 00.0''$
 $L = 913.16'$
 $T = 460.49'$
 $R = 2,864.79'$
 $SE = 0.035$
 $INC = 50$

-DET2-
 Pls Sta 34+64.56
 $\phi_s = 1' 45'' 00.0''$
 $L_s = 175.00'$
 $LT = 116.67'$
 $ST = 58.34'$

-Y1-
 Pls Sta 14+39.83
 $\Delta = 15' 38'' 28.9''$
 $D = 6' 45'' 00.0''$
 $L = 231.72'$
 $T = 116.59'$
 $R = 848.83'$
 $SE = 05$
 $INC = 36$

-DET2-
 Pls Sta 10+67.15
 $\Delta = 38' 44'' 44.0''$
 $D = 30' 00'' 00.0''$
 $L = 129.15'$
 $T = 67.15'$
 $R = 190.99'$
 $SE = SEE PLANS$

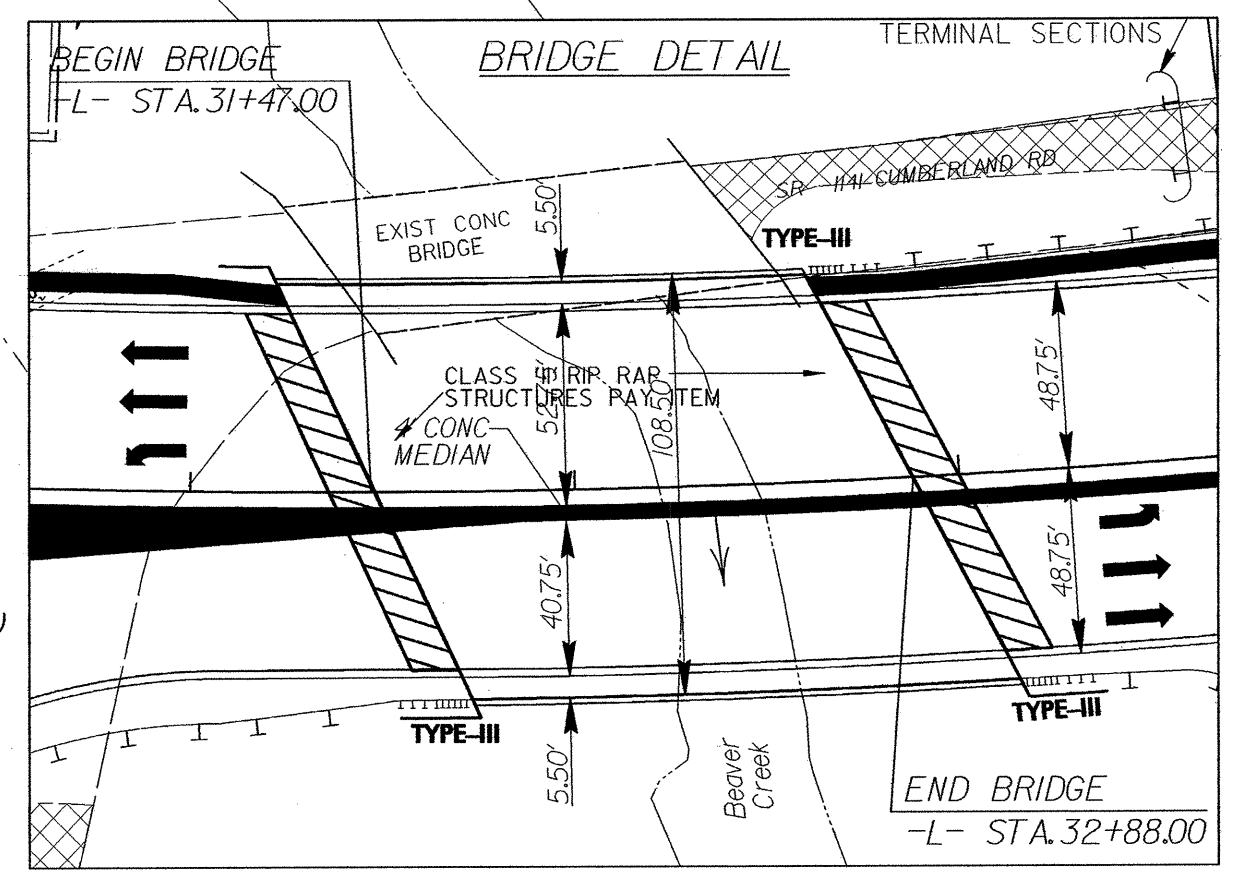
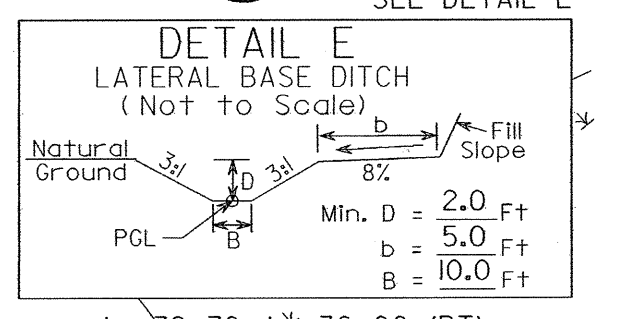
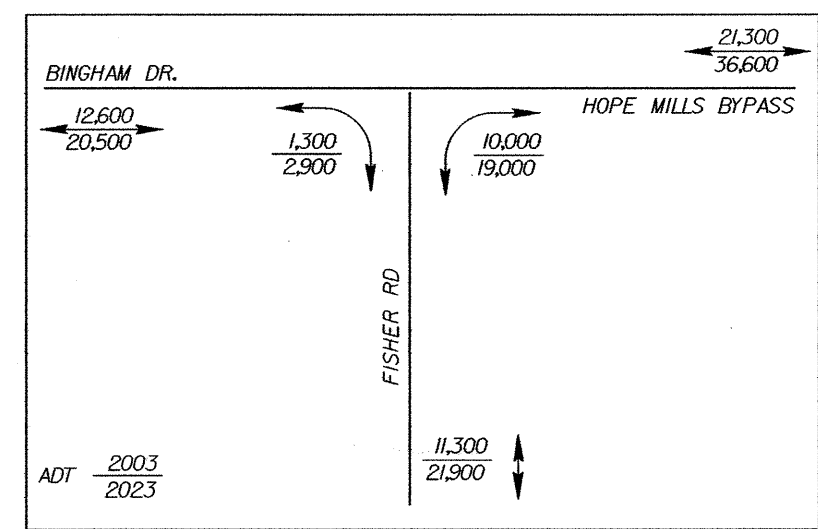
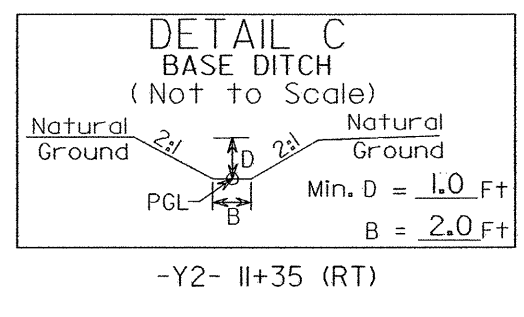
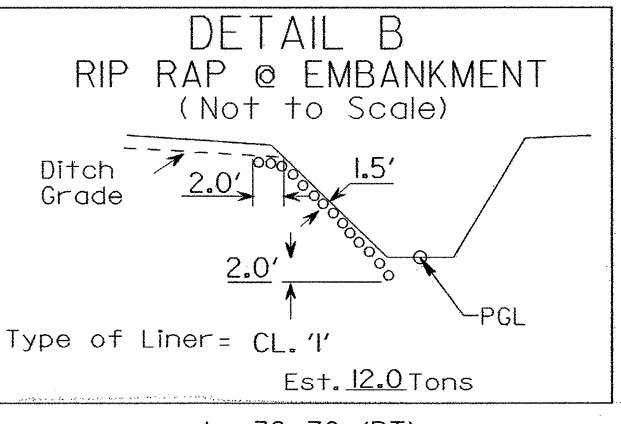
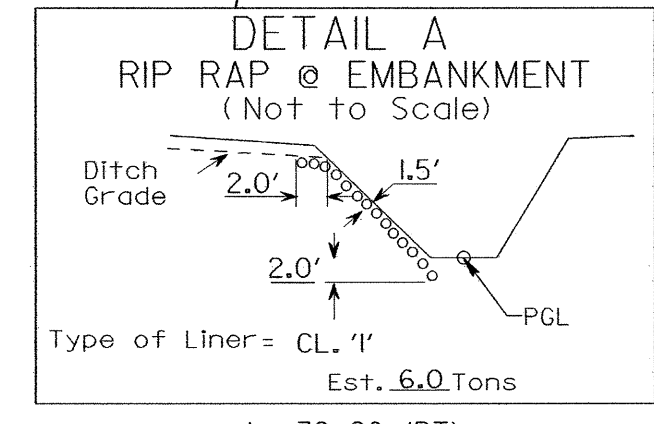
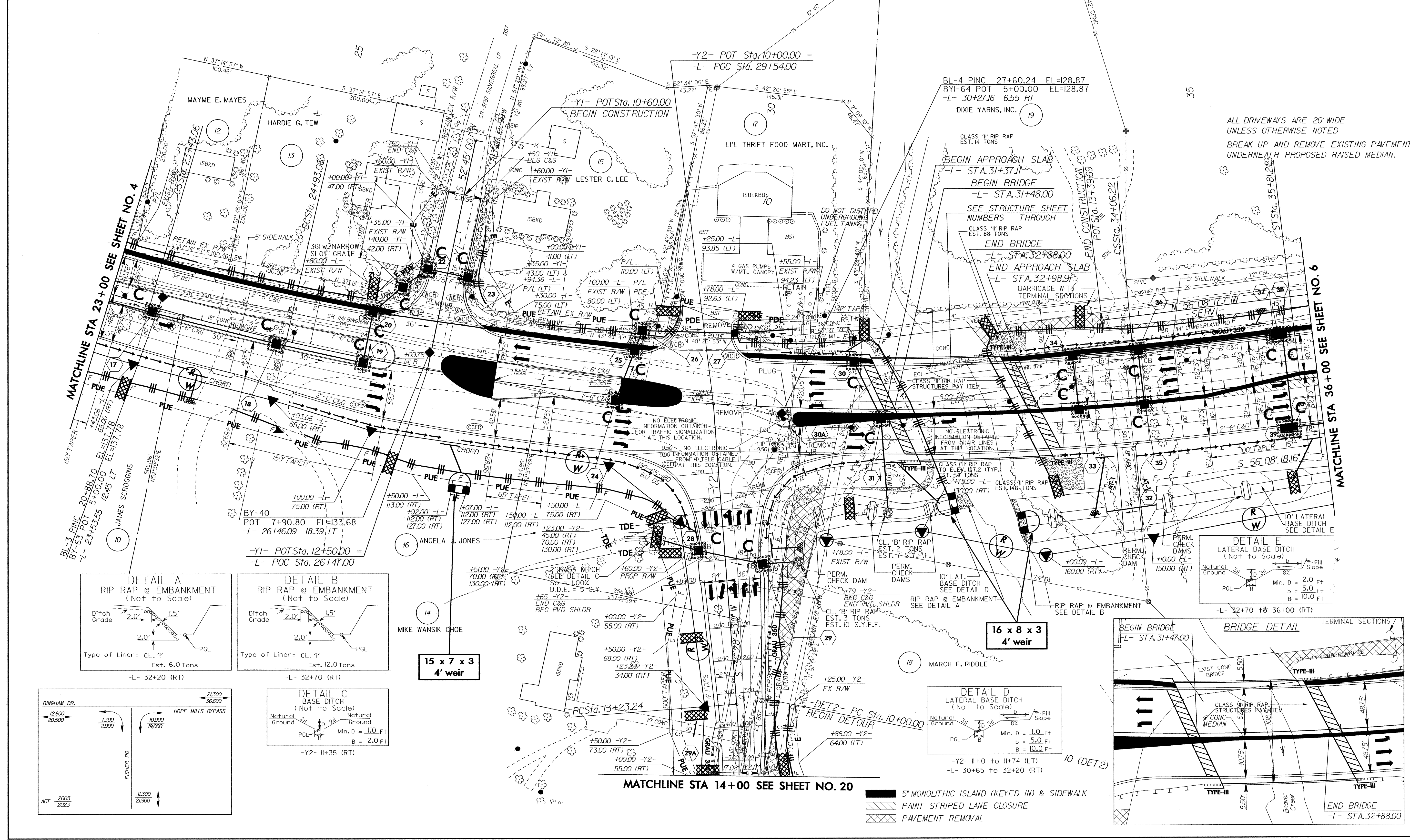

5' MONOLITHIC ISLAND (KEYED IN) & SIDEWALK
 PAINT STRIPED LANE CLOSURE
 PAVEMENT REMOVAL

ALL DRIVEWAYS ARE 20' WIDE UNLESS OTHERWISE NOTED
 BREAK UP AND REMOVE EXISTING PAVEMENT UNDERNEATH PROPOSED RAISED MEDIAN.