

REVISIONS

12/18/02 CONVERTED TEMPORARY CONSTRUCTION EASEMENT TO PERMANENT UTILITY EASEMENT ON PARCELS 20, 23, 24, 25, 114, 115, AND 116.
 COMBINED PARCELS 20 AND 21. CHANGED PARCEL 28 TO 18
 REVISED PARCEL OWNER NAMES AND DEED BOOK INFORMATION ON PARCELS 20, 24, 114, AND 116.
 4/15/03 NAME CHANGE ON PARCEL 115
 WIDENED DRIVE ON PARCEL 22.
 DEED BOOK CHANGE ON PARCEL 20
 UPDATED RIGHT OF WAY AREA DATA SHEET TO REFLECT CHANGES
 7/2/03 REVISED ROW MONUMENT ON PARCEL 116
 9/4/03 REVISED PUE ON PARCEL 20
 9/30/03 REVISED ROW AND PUE ON PARCEL 114

FUTURE PROJECT U-4421

-Y3- POT Sta. 12+68 =
 -Y4- POT Sta. 10+00.00
 BL-6 PINC 41+57.23 EL=167.95
 BY2-66 POT 16+75.77 EL=167.95
 -L- 43+33.79 349.15 LT
 -Y3- 13+00.62 63.66 LT

114
 HAYNE HENS FARM, INC.
 PB 97 PG 87
 DB 5435 PG 864

19
 DIXIE YARNS, INC.

PROJECT REFERENCE NO. U-0620		SHEET NO. EC-30/CONST.6	
RW SHEET NO.		HYDRAULICS ENGINEER	
ROADWAY DESIGN ENGINEER			

SEE SHEET 26 FOR -L- PROFILE
 SEE SHEET 33 FOR -Y3- PROFILE
 SEE SHEET 34 FOR -Y4- PROFILE
 SEE SHEET 38 FOR DIXIE PROFILE

ALL DRIVEWAYS ARE 20' WIDE UNLESS OTHERWISE NOTED
 BREAK UP AND REMOVE EXISTING PAVEMENT UNDERNEATH PROPOSED RAISED MEDIAN.
 ALL TEMPORARY TAPERS HAVE A 40 MPH DESIGN SPEED

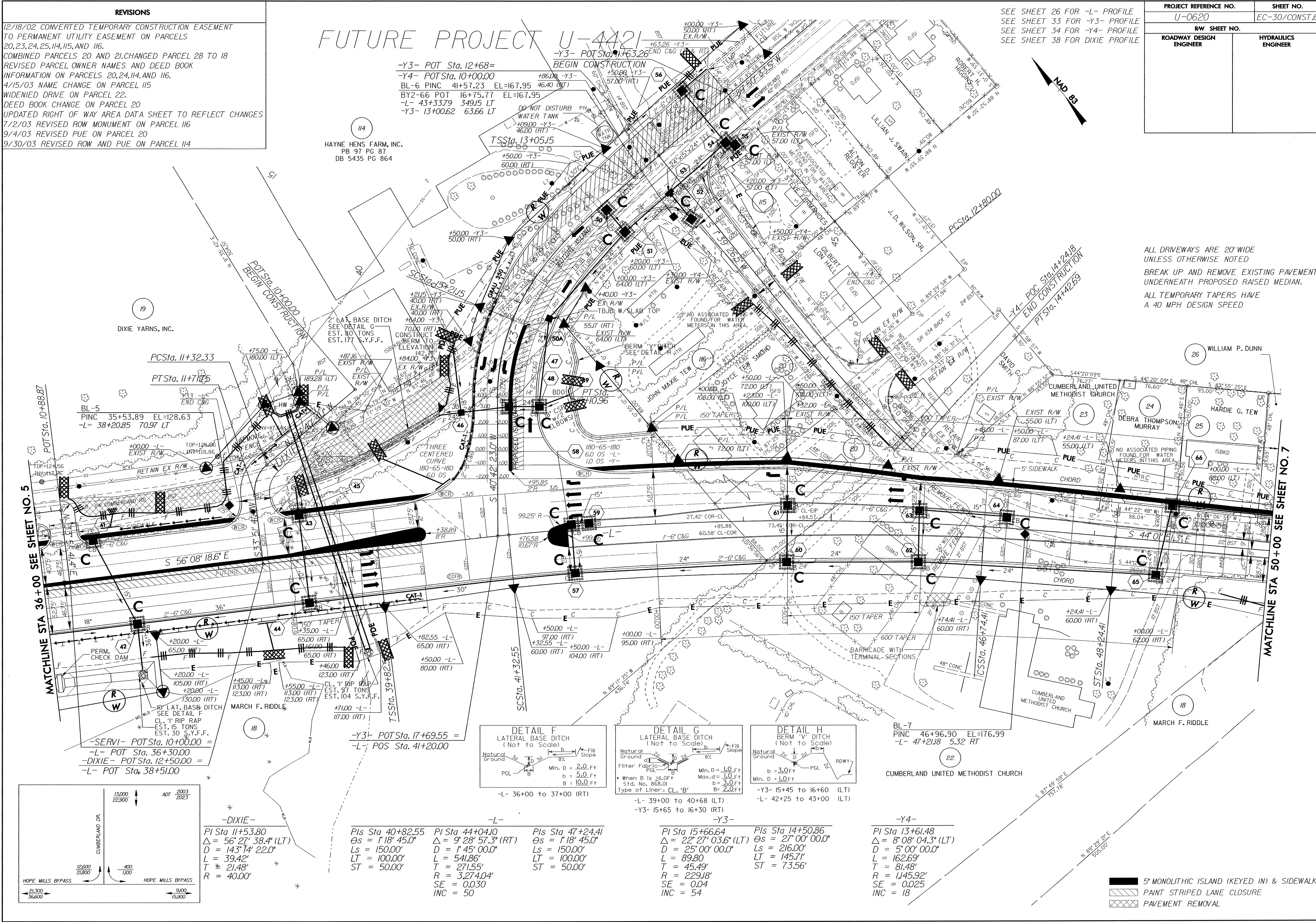

MATCHLINE STA 36+00 SEE SHEET NO. 5

MATCHLINE STA 50+00 SEE SHEET NO. 7

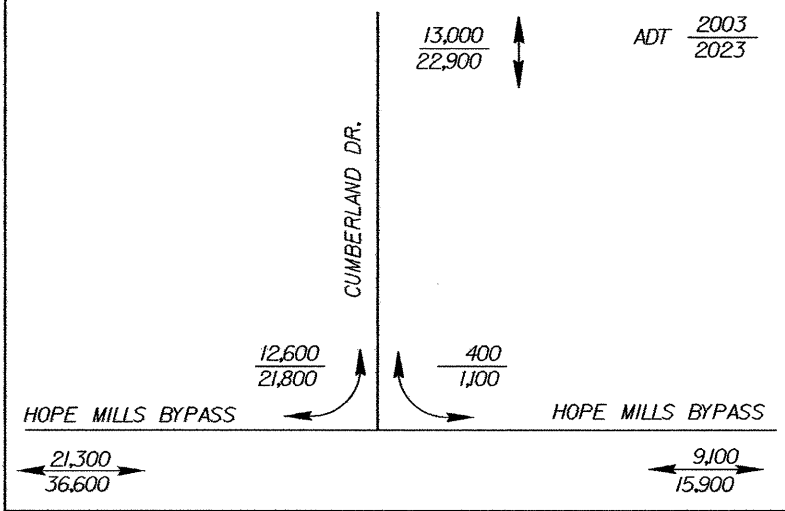

-DIXIE-
 PI Sta 11+53.80
 $\Delta = 56^{\circ} 27' 38.4''$ (LT)
 $D = 143^{\circ} 14' 22.0''$
 $L = 39.42'$
 $T = 21.48'$
 $R = 40.00'$

-L- PIs Sta 40+82.55 $\Delta = 1^{\circ} 18' 45.0''$ $D = 150.00'$ $L = 100.00'$ $ST = 50.00'$	-L- PI Sta 44+04.10 $\Delta = 9^{\circ} 28' 57.3''$ (RT) $D = 145^{\circ} 00.0''$ $L = 541.86'$ $T = 271.55'$ $R = 3,274.04'$ $SE = 0.030$ $INC = 50$	-L- PIs Sta 47+24.41 $\Delta = 22^{\circ} 27' 03.6''$ (LT) $D = 25^{\circ} 00' 00.0''$ $L = 89.80$ $T = 45.49'$ $R = 229.18'$ $SE = 0.04$ $INC = 54$
---	---	--

-Y3- PI Sta 15+66.64 $\Delta = 22^{\circ} 27' 03.6''$ (LT) $D = 25^{\circ} 00' 00.0''$ $L = 89.80$ $T = 45.49'$ $R = 229.18'$ $SE = 0.04$ $INC = 54$	-Y3- PIs Sta 14+50.86 $\Delta = 27^{\circ} 00' 00.0''$ $D = 150.00'$ $L = 145.71'$ $ST = 73.56'$
--	---

-Y4-
 PI Sta 13+61.48
 $\Delta = 8^{\circ} 08' 04.3''$ (LT)
 $D = 5^{\circ} 00' 00.0''$
 $L = 162.69'$
 $T = 81.48'$
 $R = 1,145.92'$
 $SE = 0.025$
 $INC = 18$

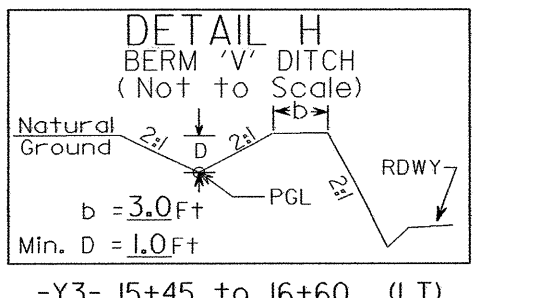
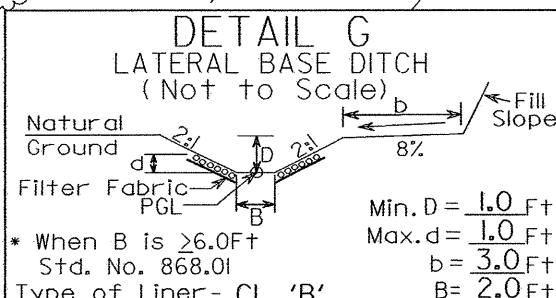
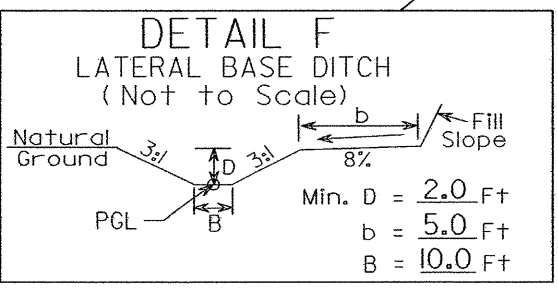

5' MONOLITHIC ISLAND (KEYED IN) & SIDEWALK
 PAINT STRIPED LANE CLOSURE
 PAVEMENT REMOVAL