

SEE SHEET 38 FOR -Y15- PROFILE

PROJECT REFERENCE NO.		SHEET NO.	
U-0620		EC-48/CONST.24	
RW SHEET NO.			
ROADWAY DESIGN ENGINEER		HYDRAULICS ENGINEER	

-Y15-  
 PI Sta. 24+08.83  
 $\Delta = 9^{\circ} 42' 43.0''$  (LT)  
 $D = 2^{\circ} 00' 00.0''$   
 $L = 485.60'$   
 $T = 243.38'$   
 $R = 2,864.79'$   
 $SE = 0.035$   
 $INC = 44$

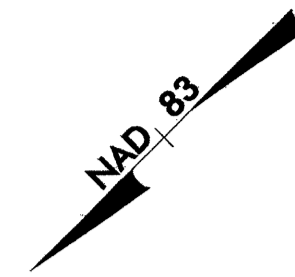

# FUTURE PROJECT U-2809B

CUMBERLAND CO. BOARD OF EDUCATION

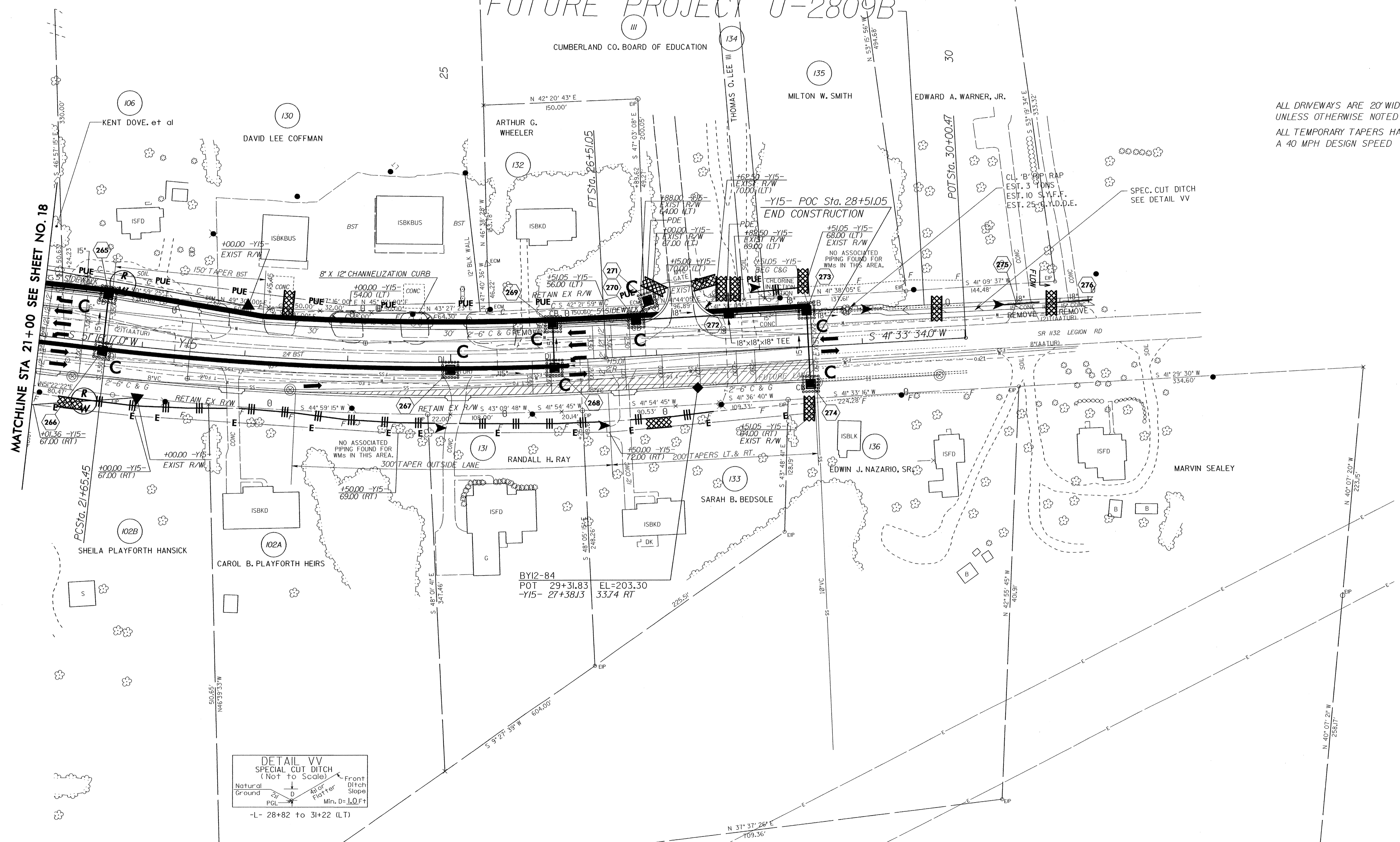

ALL DRIVEWAYS ARE 20' WIDE  
 UNLESS OTHERWISE NOTED  
 ALL TEMPORARY TAPERS HAVE  
 A 40 MPH DESIGN SPEED

MATCHLINE STA 21+00 SEE SHEET NO. 18

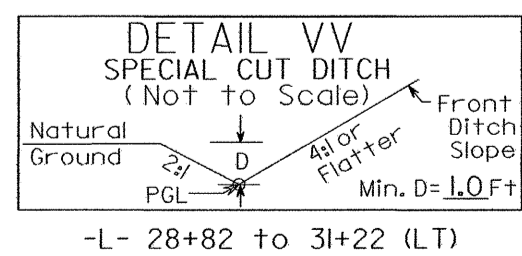

- 5' MONOLITHIC ISLAND (KEYED IN) & SIDEWALK
- PAINT STRIPED LANE CLOSURE
- PAVEMENT REMOVAL