

11/18/2003 09:45:43 AM  
H:\projects\Woodley\22810511\util1.pdw

NOTE:  
ALL PROPOSED UTILITY WORK  
SHOWN ON THIS SHEET WILL  
BE DONE BY OTHERS

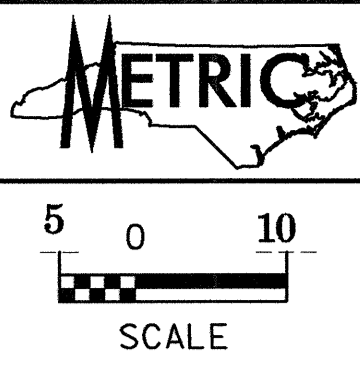

-Y13-  
PI Sta 10+62.858  
Δ = 14°16'10.3" (RT)  
L = 123.280  
T = 61.961  
R = 495.000

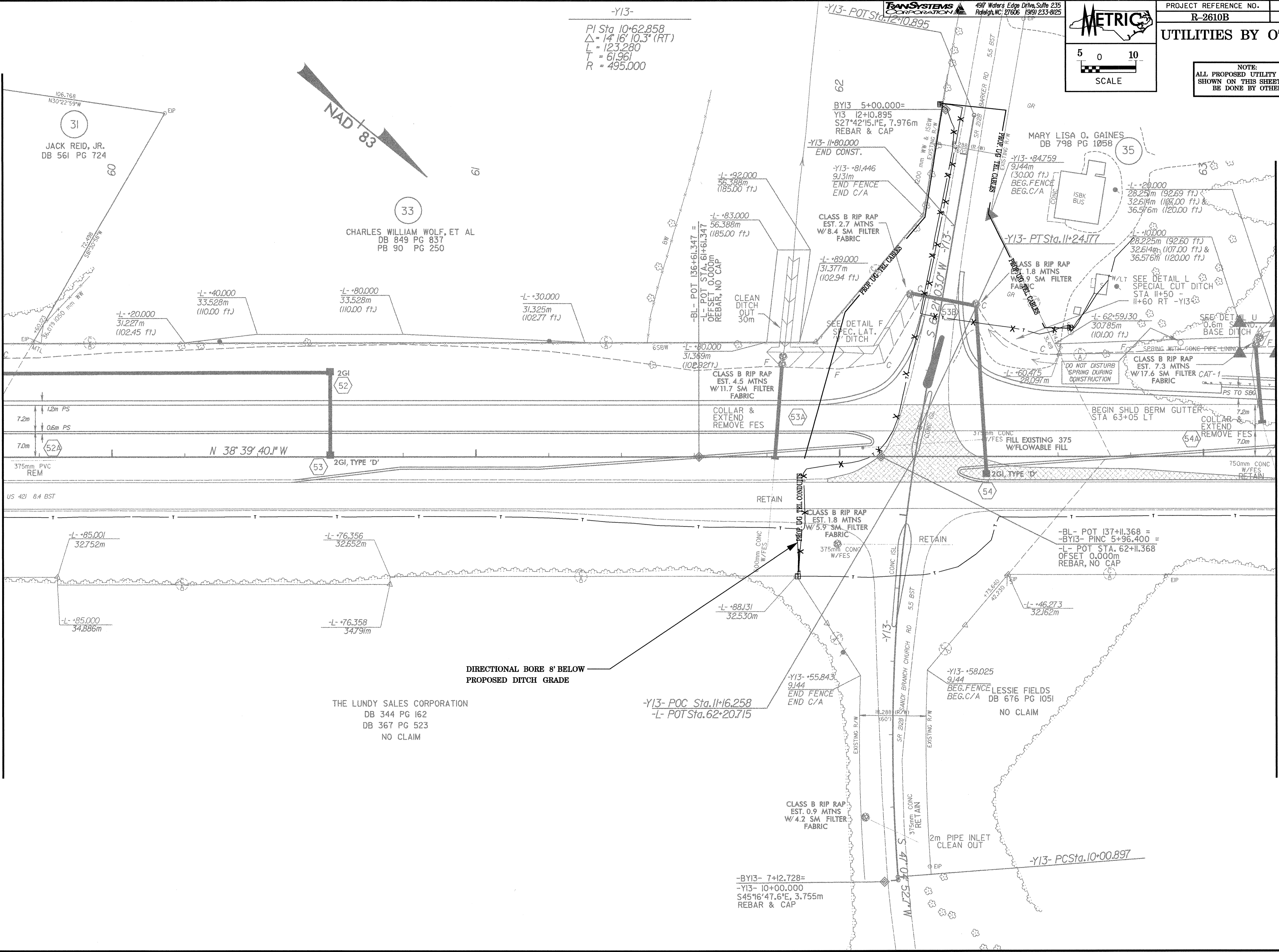

MATCHLINE 59 + 70 SEE SHEET UO-10

MATCHLINE -L- 63 + 20

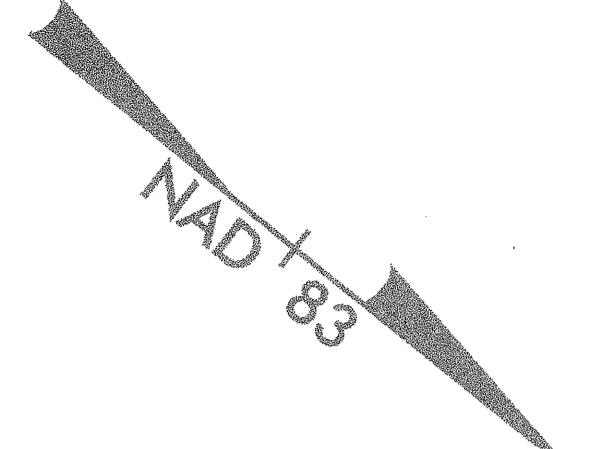

31  
JACK REID, JR.  
DB 561 PG 724

33  
CHARLES WILLIAM WOLF, ET AL  
DB 849 PG 837  
PB 90 PG 250

35  
MARY LISA O. GAINES  
DB 798 PG 1058

LESSIE FIELDS  
DB 676 PG 1051  
NO CLAIM

THE LUNDY SALES CORPORATION  
DB 344 PG 162  
DB 367 PG 523  
NO CLAIM

DIRECTIONAL BORE 8' BELOW  
PROPOSED DITCH GRADE

-Y13- POC Sta. 11+16.258  
-L- POT Sta. 62+20.715

-BY13- 7+12.728=  
-Y13- 10+00.000  
S45°16'47.6"E, 3.755m  
REBAR & CAP

-BL- POT 137+11.368 =  
-BY13- P INC 5+96.400 =  
-L- POT STA. 62+11.368  
OFFSET 0.000m  
REBAR, NO CAP

