

-BL-
Pls Sta 199+59.294
f s = 1' 08' 07.2"
Ls = 45.720
LT = 30.481
ST = 15.241

-NBL-
Pls Sta 124+85.258
Os = 1' 57' 11.8"
Ls = 75.000
LT = 50.003
ST = 25.003
SE = 045

-SBL-
Pls Sta 124+61.460
Os = 1' 57' 11.8"
Ls = 75.000
LT = 50.003
ST = 25.003
SE = 045

TRANSYSTEMS CORPORATION
4917 Waters Edge Drive, Suite 235
Raleigh, NC 27606 (919) 233-9125

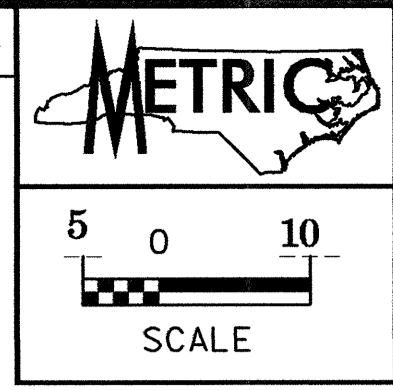

PROJECT REFERENCE NO. R-2610B
SHEET NO. UO-20

UTILITIES BY OTHERS

NOTE:
ALL PROPOSED UTILITY WORK
SHOWN ON THIS SHEET WILL
BE DONE BY OTHERS

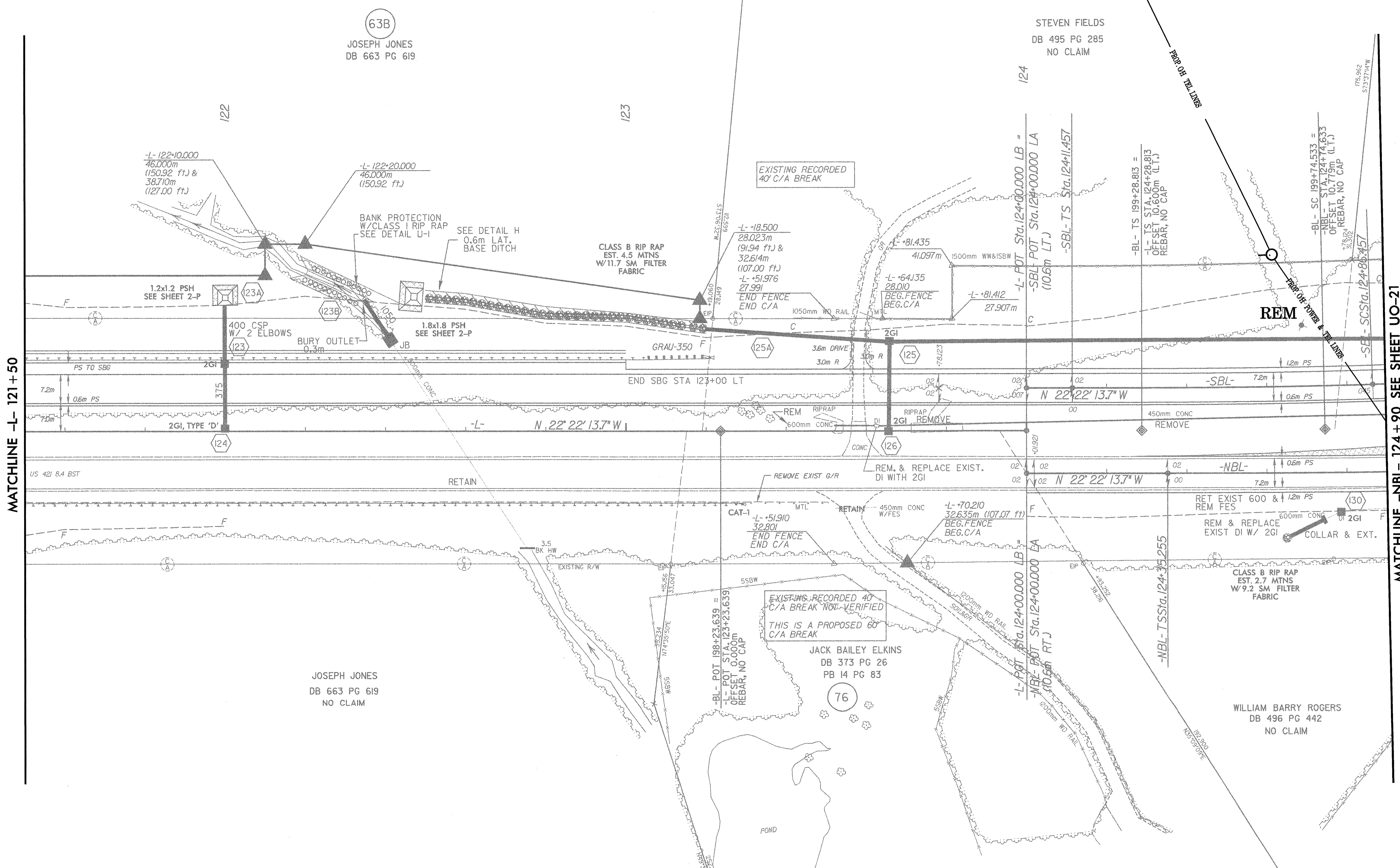
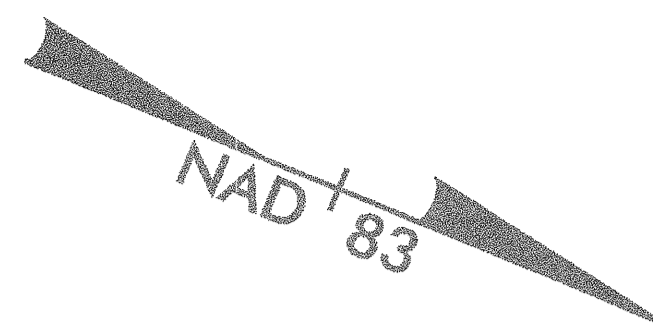

MATCHLINE -L- 121+50

MATCHLINE -NBL- 124+90 SEE SHEET UO-21