

8/17/20

23-JUN-2004 08:06
RSHILLINGAW AT 18087117

-L-
 PI Sta 19+07.683
 $\Delta = 17^{\circ} 44' 33.6''$ (RT)
 L = 544.079
 T = 274.235
 R = 1,756.976
 SE = 03
 RUNOFF = 30

-BL-
 PI Sta 94+07.682
 $D = 17^{\circ} 44' 33.7''$ (RT)
 L = 544.080
 T = 274.235
 R = 1,756.976

METRIC

CONST. REV.
 R/W REV.

PROJECT REFERENCE NO. R-2610.B	SHEET NO. 6
R/W SHEET NO.	
ROADWAY DESIGN ENGINEER RICHARD A. SHILLINGAW PROFESSIONAL ENGINEER SEAL 17691 NORTH CAROLINA	HYDRAULICS ENGINEER STEPHEN R. MORGAN PROFESSIONAL ENGINEER SEAL 22100 NORTH CAROLINA
SEE SHEET 40 & 41 FOR -L- PROFILE SEE SHEET 2-0 FOR -L- MEDIAN CROSS OVER DETAILS	

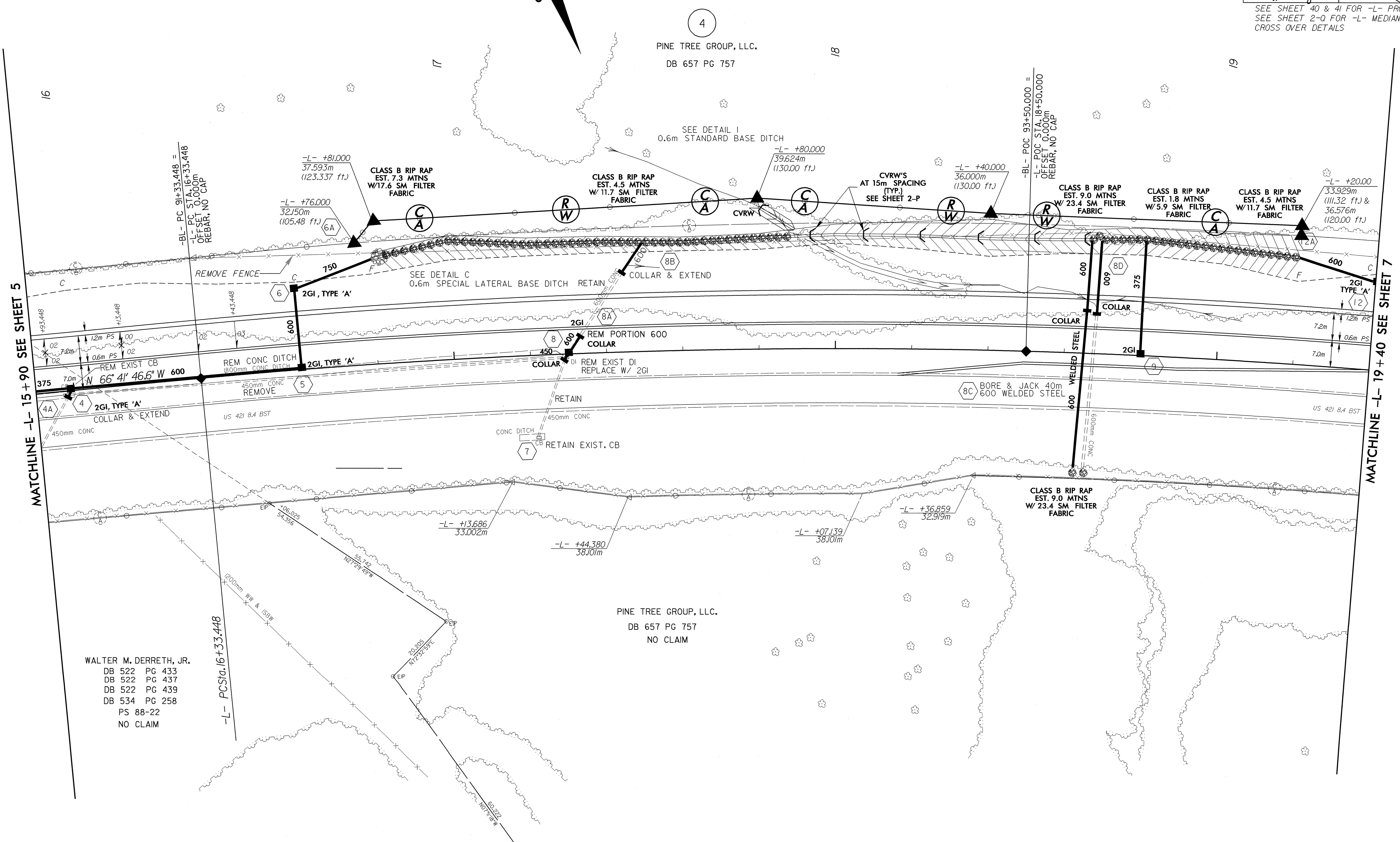

REVISIONS

MATCHLINE -L- 15+90 SEE SHEET 5

MATCHLINE -L- 19+40 SEE SHEET 7

WALTER M. DERRETH, JR.
 DB 522 PG 433
 DB 522 PG 437
 DB 522 PG 439
 DB 534 PG 258
 PS 88-22
 NO CLAIM

-L- PC Sta. 16+33.448

