

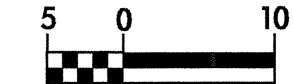

PROJECT REFERENCE NO. R-2610B	SHEET NO. 57
ROADWAY DESIGN ENGINEER 06-23-04	HYDRAULICS ENGINEER
CONST. REV.	
R / W REV.	



-SBL-

NOTE : THIS GROUND PROFILE IS ALONG THE CENTERLINE OF SBL

PI = 125+61.354
 EL = 186.2285 m
 VC = 230 m
 K = 164

PI = 127+20.000
 EL = 187.951 m
 VC = 50 m
 K = 197

BEG GRADE
 -SBL- 124+00.000
 ELEV 182.219m
 GRADE POINT &
 CROWN POINT @
 C -SBL-

BM # 19
 R/R SPIKE IN BASE OF 230mm PINE , 58.25m RIGHT
 OF BASELINE -L- 202+30.000 ELEV. 194.699m

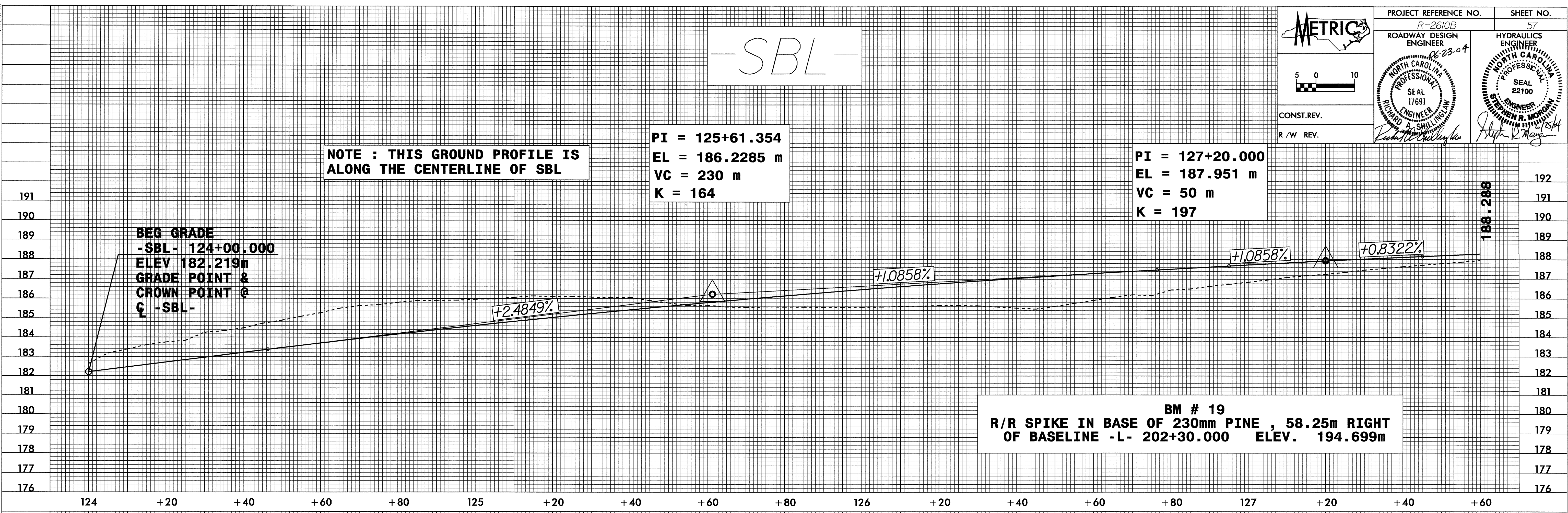

-SBL-

BM # 20
 R/R SPIKE IN BASE OF 300mm PINE , 37.84m RIGHT
 OF BASELINE -L- 207+64.410 ELEV. 191.727m

PI = 128+10.000
 EL = 188.700 m
 VC = 130 m
 K = 278

PI = 129+30.000
 EL = 190.260 m
 VC = 55 m
 K = 65

END GRADE
 -SBL- 129+71.179
 ELEV 190.445m
 GRADE POINT &
 CROWN POINT @
 C -SBL-

