

METRIC

5 0 10

CONST. REV.

R/W REV.

PROJECT REFERENCE NO. R-2610 B	SHEET NO. EC-3/CONST. 4
R/W SHEET NO.	
ROADWAY DESIGN ENGINEER	HYDRAULICS ENGINEER

DATUM DESCRIPTION

THE LOCALIZED COORDINATE SYSTEM DEVELOPED FOR THIS PROJECT IS BASED ON THE STATE PLANE COORDINATES ESTABLISHED BY NCGS FOR MONUMENT "GULF"

WITH NAD 83 STATE PLANE GRID COORDINATES OF
NORTHING: 200429.889(m) EASTING: 583653.011(m)

THE AVERAGE COMBINED GRID FACTOR USED ON THIS PROJECT (GROUND TO GRID) IS: 0.99987697

THE N.C. LAMBERT GRID BEARING
LOCALIZED HORIZONTAL GROUND DISTANCE FROM "GULF" TO -L- STATION 10+00.000 IS 6961.937m AND BEARING N 36°03'46.9" W

ALL LINEAR DIMENSIONS ARE LOCALIZED HORIZONTAL DISTANCES
VERTICAL DATUM USED IS NGVD 29

**CLEARING AND GRUBBING
EROSION CONTROL FOR
CONSTRUCTION SHEET 4**

NOTE:
PLACE TEMPORARY ROCK SEDIMENT DAMS TYPE-B AND TEMPORARY ROCK SILT CHECKS TYPE-A AT DRAINAGE OUTLETS.

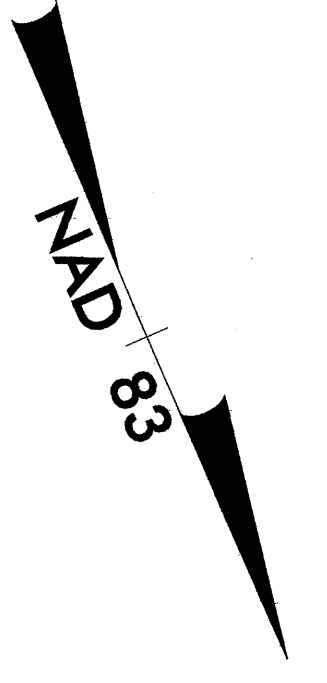

SEE SHEET 40 FOR -L- PROFILE

2
JAMES BAIN
DB 726 PG 803

1
CHARLES F. BRANCH
DB 617 PG 580
PLAT SLIDE 93-183

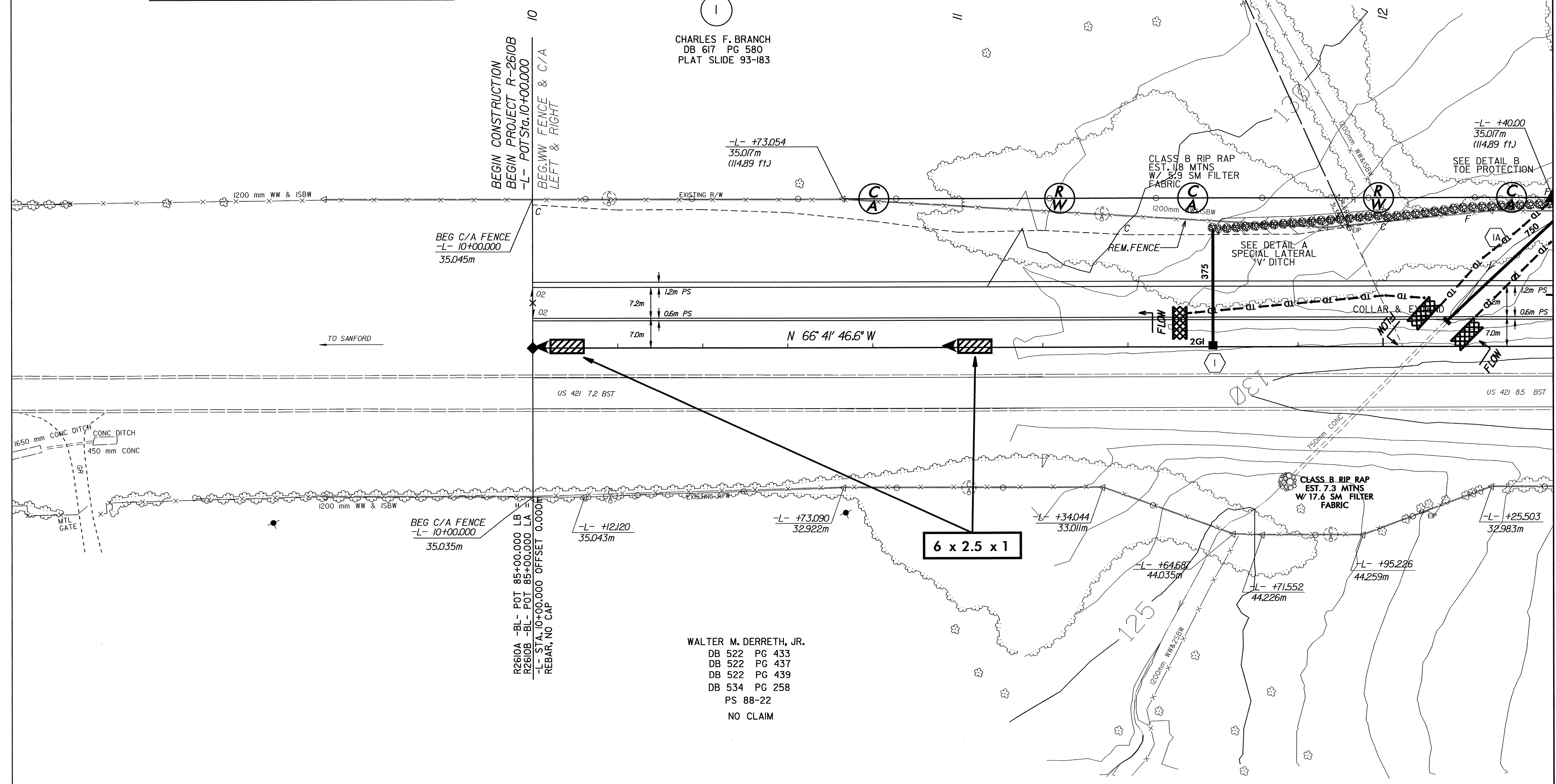

BEGIN CONSTRUCTION
BEG PROJECT R-2610B
-L- POT Sta. 10+00.000
BEG WW FENCE & C/A
LEFT & RIGHT

MATCHLINE -L- 12 + 40 SEE SHEET 5

WALTER M. DERRETH, JR.
DB 522 PG 433
DB 522 PG 437
DB 522 PG 439
DB 534 PG 258
PS 88-22
NO CLAIM