

PROJECT REFERENCE NO. R-2610 A		SHEET NO. EC-42/CONST.16	
R/W SHEET NO.			
ROADWAY DESIGN ENGINEER		HYDRAULICS ENGINEER	
CONST. REV.			
R/W REV. 03-19-02			

SEE SHEET 32 & 33 FOR -L- PROFILE  
SEE SHEETS 2-H & 2-I FOR DITCH DETAILS  
SEE SHEET 32 FOR DITCH PROFILES

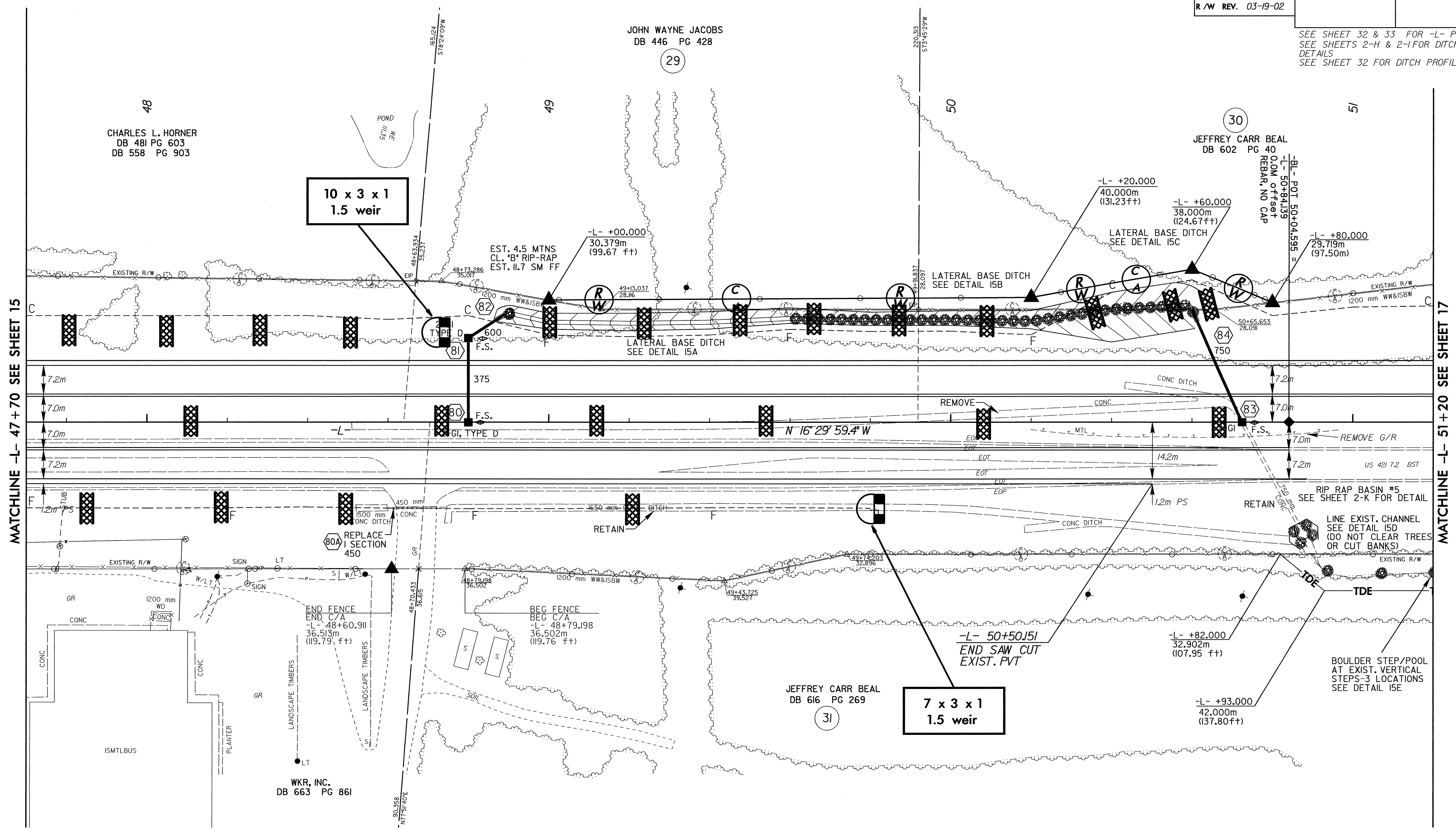
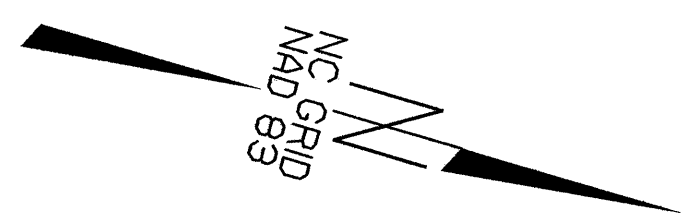

MATCHLINE -L- 47+70 SEE SHEET 15

MATCHLINE -L- 51+20 SEE SHEET 17

48  
CHARLES L. HORNER  
DB 481 PG 603  
DB 558 PG 903

JOHN WAYNE JACOBS  
DB 446 PG 428

30  
JEFFREY CARR BEAL  
DB 602 PG 40

JEFFREY CARR BEAL  
DB 616 PG 269

WKR, INC.  
DB 663 PG 861

8/17/99  
  
 I:\NOV-2003\1548  
 d:\yves\cur\al\2610a\proj\2610a\16.msh  
 mlaughach