

8/17/94

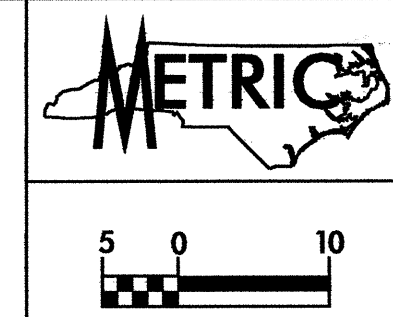

PROJECT REFERENCE NO.	SHEET NO.
R-2610 A	EC-53/CONST.27
R/W SHEET NO.	
ROADWAY DESIGN ENGINEER	HYDRAULICS ENGINEER
CONST.REV.	
R/W REV. 02-05-02	

SEE SHEET 37 FOR -L- PROFILE
 SEE SHEETS 2-H & 2-I FOR DITCH DETAILS
 SEE SHEET 37 FOR DITCH PROFILES

CHARLES F. BRANCH
 DB 617 PG 580
 PLAT SLIDE 93-183

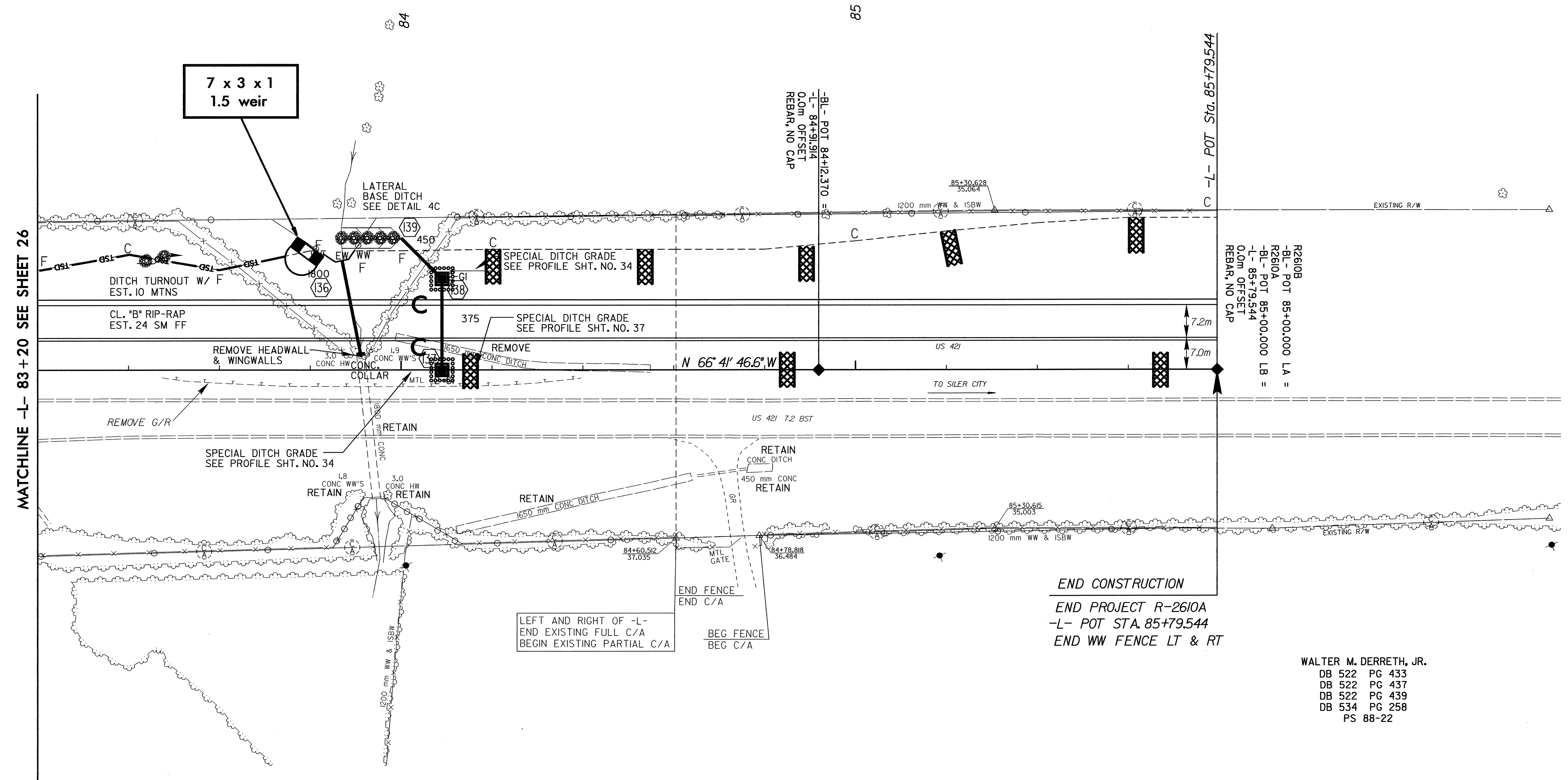

MATCHLINE -L- 83+20 SEE SHEET 26

R2610B
 -BL- POT 85+00.000 LA =
 R2610A
 -L- POT 85+00.000 LB =
 -L- 85+79.544
 0.0m OFFSET
 REBAR, NO CAP

LEFT AND RIGHT OF -L-
 END EXISTING FULL C/A
 BEGIN EXISTING PARTIAL C/A

END CONSTRUCTION
 END PROJECT R-2610A
 -L- POT STA. 85+79.544
 END WW FENCE LT & RT

WALTER M. DERRETH, JR.
 DB 522 PG 433
 DB 522 PG 437
 DB 522 PG 439
 DB 534 PG 258
 PS 88-22

I:\NOV-2003\1416\dl\New\Revised\2610a\p\o\1\2610a27.psh