

TEMPORARY SHIFT 2
 PI Sta 11+80.72
 $\Delta = 6' 13'' 14.2''$ (RT)
 $D = 14' 59'' 56.0''$
 $L = 41.47'$
 $T = 20.76'$
 $R = 382.00'$

TEMPORARY SHIFT 2
 PI Sta 13+87.98
 $\Delta = 3' 21'' 56.5''$ (LT)
 $D = 14' 59'' 56.0''$
 $L = 22.44'$
 $T = 11.22'$
 $R = 382.00'$

PLEASE NOTE: DO NOT DISTURB THE EXIST. 16" WATER LINE OR THE EXIST. 6" FORCE MAIN DURING CONSTRUCTION

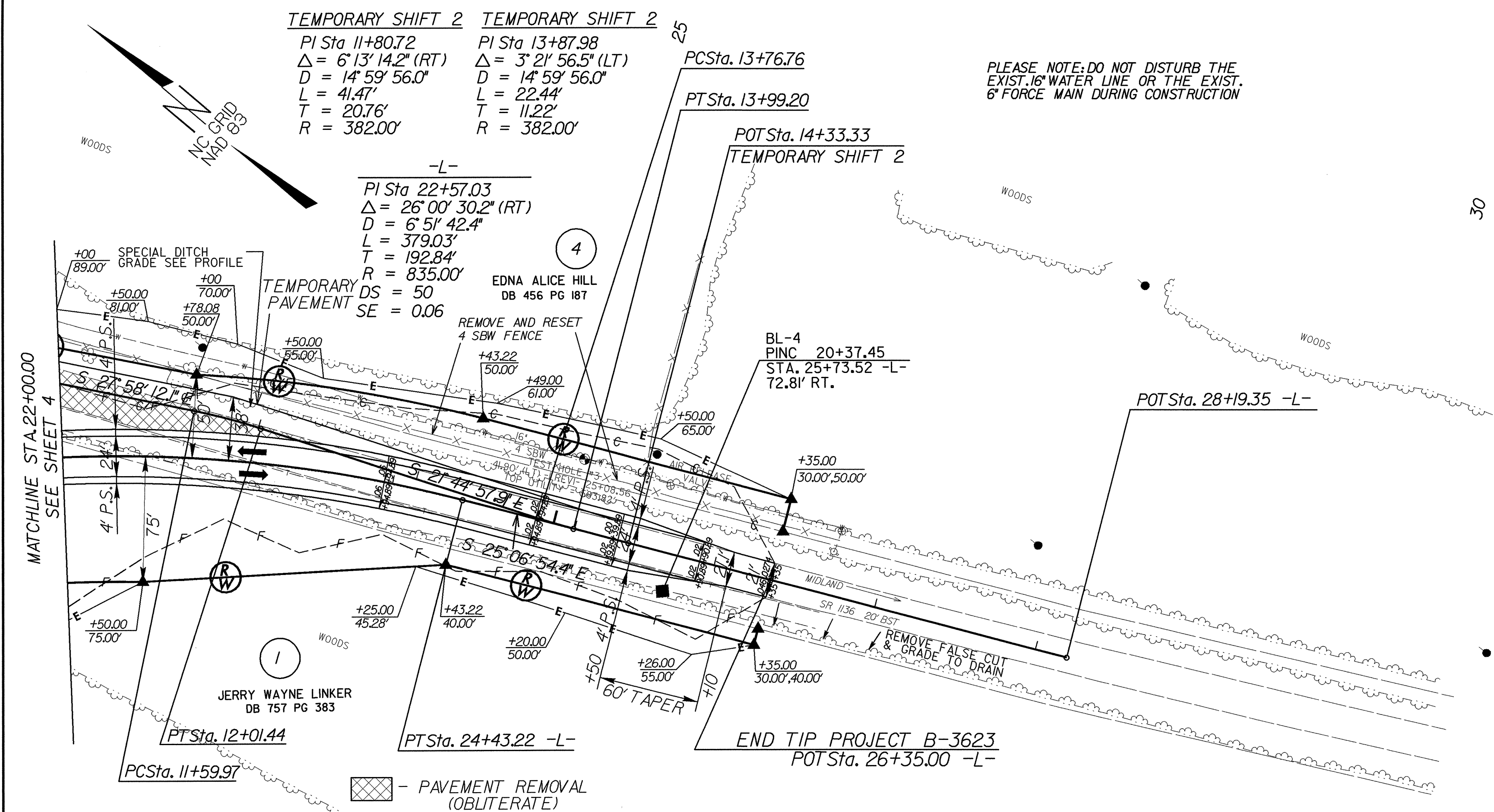

* DESIGN EXCEPTION REQUIRED FOR SAG VERTICAL CURVE K VALUE AND VERTICAL STOPPING SIGHT DISTANCE.

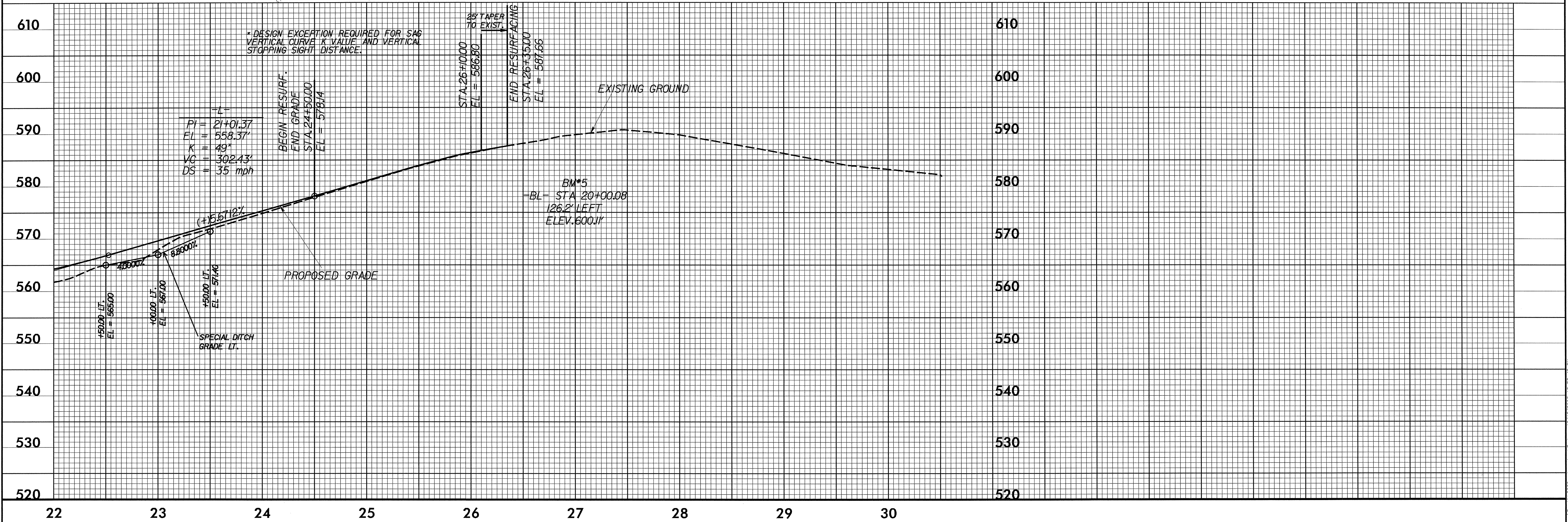

* DESIGN EXCEPTION REQUIRED FOR SAG VERTICAL CURVE K VALUE AND VERTICAL STOPPING SIGHT DISTANCE.