

5/14/99

PROJECT REFERENCE NO.	SHEET NO.
B-3901	1C
LOCATION AND SURVEYS	

B-3901 SURVEY CONTROL SHEET

NOTES

I. THE CONTROL DATA FOR THIS PROJECT CAN BE FOUND ELECTRONICALLY BY SELECTING PROJECT CONTROL DATA AT:

HTTP:\WWW.DOH.DOT.STATE.NC.US/PRECONSTRUCT/HIGHWAY/LOCATION/PROJECT/
FILE: b3901_ls_control_030619.txt

SITE CALIBRATION INFORMATION HAS NOT BEEN PROVIDED FOR THIS PROJECT. IF FURTHER INFORMATION IS NEEDED, PLEASE CONTACT THE LOCATION AND SURVEYS UNIT.

CONTROL DATA

BL POINT	DESC.	NORTH	EAST	ELEVATION	L STATION	OFFSET
3	"BL-3"	1012573.3599	1753176.3057	723.19	OUTSIDE PROJECT LIMITS	
4	"BL-4"	1012339.3369	1753557.1287	696.82	13+79.06	16.49 RT
5	"BL-5"	1012000.1748	1754387.5818	624.55	22+74.65	14.72 RT
1	GPS "B3901-1"	1011788.2130	1755170.7130	672.60	30+82.18	24.03 RT
2	GPS "B3901-2"	1011991.5760	1755829.4100	707.16	37+67.63	31.50 RT

BENCHMARK DATA

.....
 BM1 ELEVATION = 708.99
 N 1012429 E 1753249
 L STATION 10+77 83 RIGHT
 RR SPIKE SET IN BASE OF 24' WHITE OAK

 BM2 ELEVATION = 615.03
 N 1012210 E 1754408
 L STATION 22+32 192 LEFT
 RR SPIKE SET IN BASE OF 18' SYCAMORE

 BM3 ELEVATION = 697.64
 N 1012121 E 1755844
 L STATION 38+37 79 LEFT
 RR SPIKE SET IN BASE OF 20' RED OAK

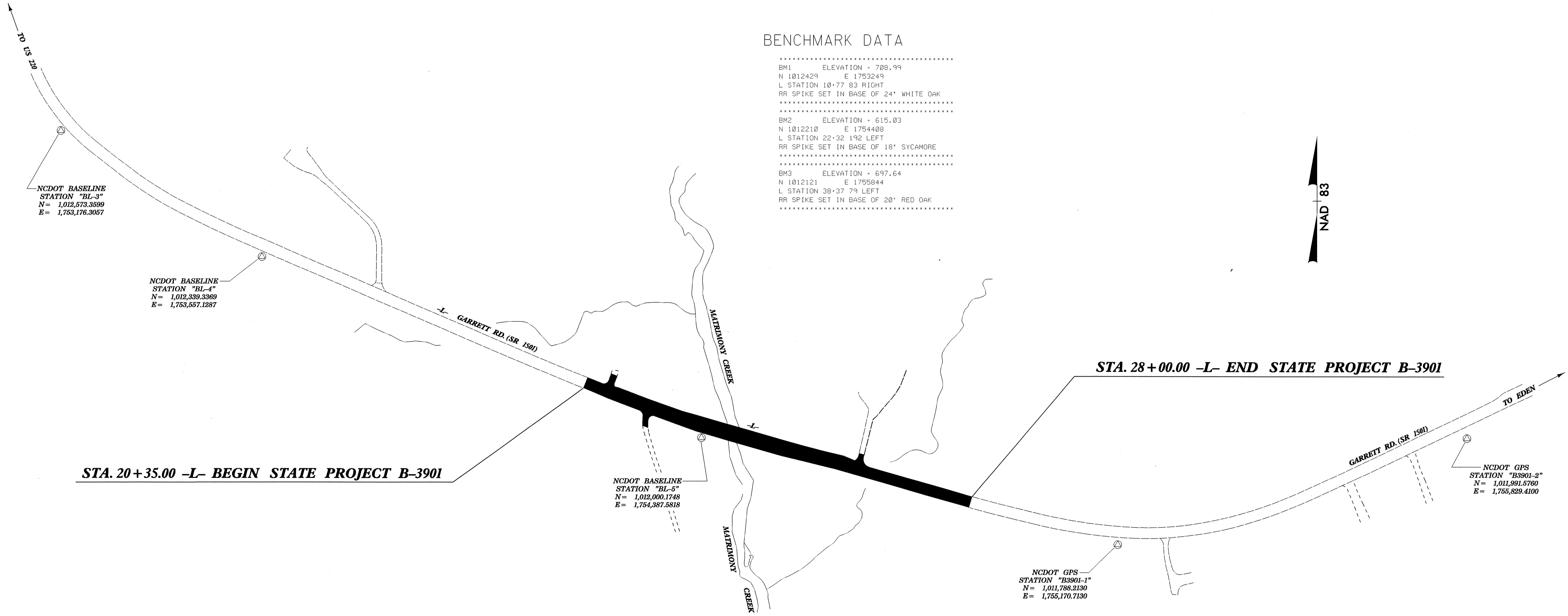

DATUM DESCRIPTION

THE LOCALIZED COORDINATE SYSTEM DEVELOPED FOR THIS PROJECT IS BASED ON THE STATE PLANE COORDINATES ESTABLISHED BY NCDOT FOR MONUMENT "B3901-1" WITH NAD 1983/95 STATE PLANE GRID COORDINATES OF NORTHING: 1011788.213(Ft) EASTING: 1755170.713(Ft) THE AVERAGE COMBINED GRID FACTOR USED ON THIS PROJECT (GROUND TO GRID) IS: 1.00009353 THE N.C. LAMBERT GRID BEARING AND LOCALIZED HORIZONTAL GROUND DISTANCE FROM "B3901-1" TO L- STATION 20+35.00 IS N 73° 00' 27.100" W DISTANCE = 1050.35 ft ALL LINEAR DIMENSIONS ARE LOCALIZED HORIZONTAL DISTANCES VERTICAL DATUM USED IS NAVD 88

⊙ INDICATES GEODETIC CONTROL MONUMENTS USED OR SET FOR HORIZONTAL PROJECT CONTROL BY THE NCDOT LOCATION AND SURVEYS UNIT. ALL COORDINATES SHOWN ARE LOCALIZED PROJECT COORDINATES.
 PROJECT CONTROL ESTABLISHED USING GLOBAL POSITIONING SYSTEM.
 NETWORK ESTABLISHED FROM NGS ONLINE POSITIONING USER SERVICE (OPUS)

NOTE: DRAWING NOT TO SCALE

23-JUN-2004 08:02
H:\Projects\B3901\ls_1c_030619.dgn
twb