

TIP PROJECT: B-3901

CONTRACT: C201072

STRUCTURE

STATE	STATE PROJECT REFERENCE NO.	
N.C.	B-3901	
STATE PROJ. NO.	F.A. PROJ. NO.	DESCRIPTION
33337.1.1	BRZ-1501(4)	PE
33337.2.1	BRZ-1501(4)	R/W & UTIL.
33337.3.1	BRZ-1501(7)	CONST.

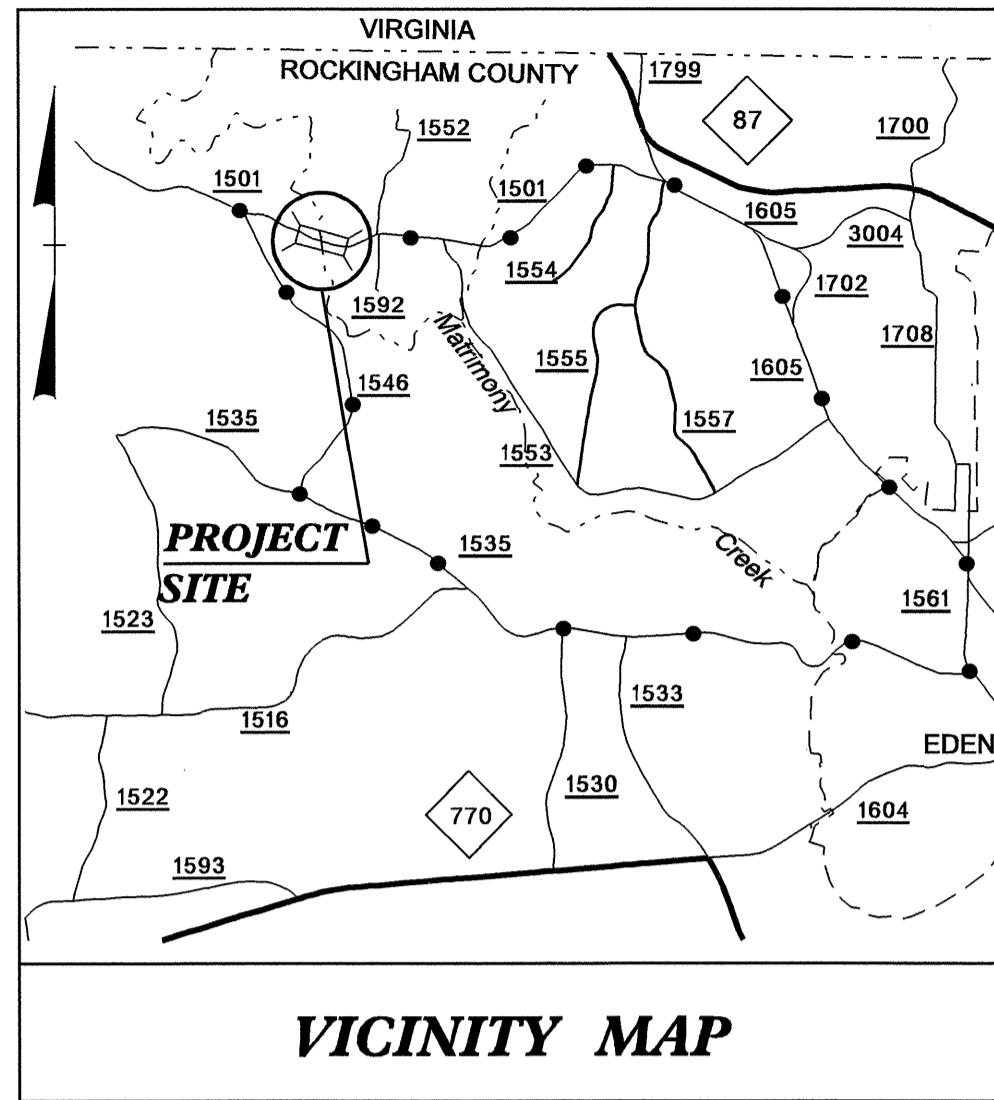

VICINITY MAP

--- DENOTES OFFSITE DETOUR

STATE OF NORTH CAROLINA
DIVISION OF HIGHWAYS

ROCKINGHAM COUNTY

LOCATION: BRIDGE NO. 181 OVER MATRIMONY CREEK
ON SR 1501

TYPE OF WORK: GRADING, DRAINAGE, PAVING, GUARDRAIL,
AND STRUCTURE

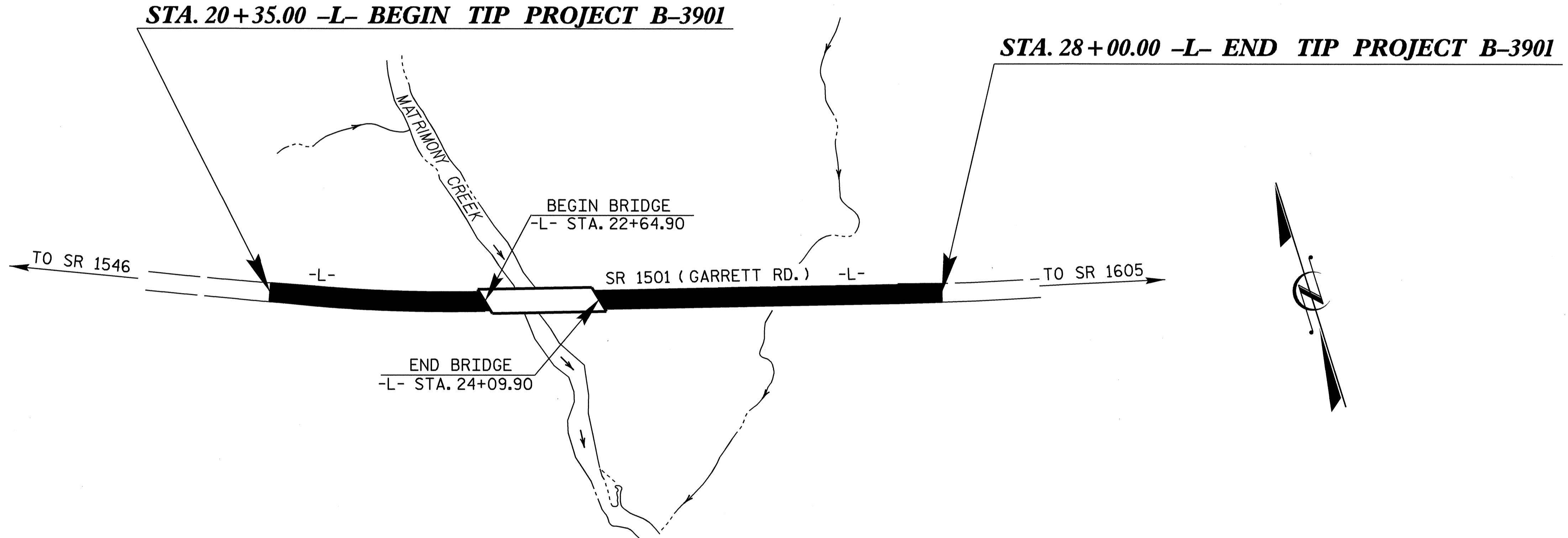

DESIGN DATA
 ADT 2004 = 464
 ADT 2024 = 784
 DHV = 10 %
 D = 60 %
 * T = 3 %
 * TTST 1% + DUAL 2%
 ** V = 60 mph
 ** DESIGN EXCEPTION REQUIRED FOR MAXIMUM GRADE, SAG VERTICAL CURVE AND VERTICAL SSD

PROJECT LENGTH

LENGTH ROADWAY TIP PROJECT B-3901	= 0.118 MILES
LENGTH STRUCTURE TIP PROJECT B-3901	= 0.027 MILES
TOTAL LENGTH OF TIP PROJECT B-3901	= 0.145 MILES

2002 STANDARDS SPECIFICATION

LETTING DATE:
AUGUST 17, 2004

Prepared In the Office of:
DEPARTMENT OF TRANSPORTATION
DIVISION OF HIGHWAYS
 1000 Birch Ridge Drive Raleigh, N.C. 27610

B. S. COX, P. E.
 PROJECT ENGINEER

D. E. PETREY, P. E.
 PROJECT DESIGN ENGINEER

STRUCTURE DESIGN UNIT

Gregory R. Peretti
7/21/04

DIVISION OF HIGHWAYS
STATE OF NORTH CAROLINA

 P.E.
 STATE HIGHWAY ENGINEER - DESIGN

DEPARTMENT OF TRANSPORTATION
FEDERAL HIGHWAY ADMINISTRATION

APPROVED FOR
DIVISION ADMINISTRATOR

DATE