

CONTRACT: C200757 TIP PROJECT: B-3884

See Sheet 1-A For Index of Sheets
 See Sheet 1-B for Symbology Information

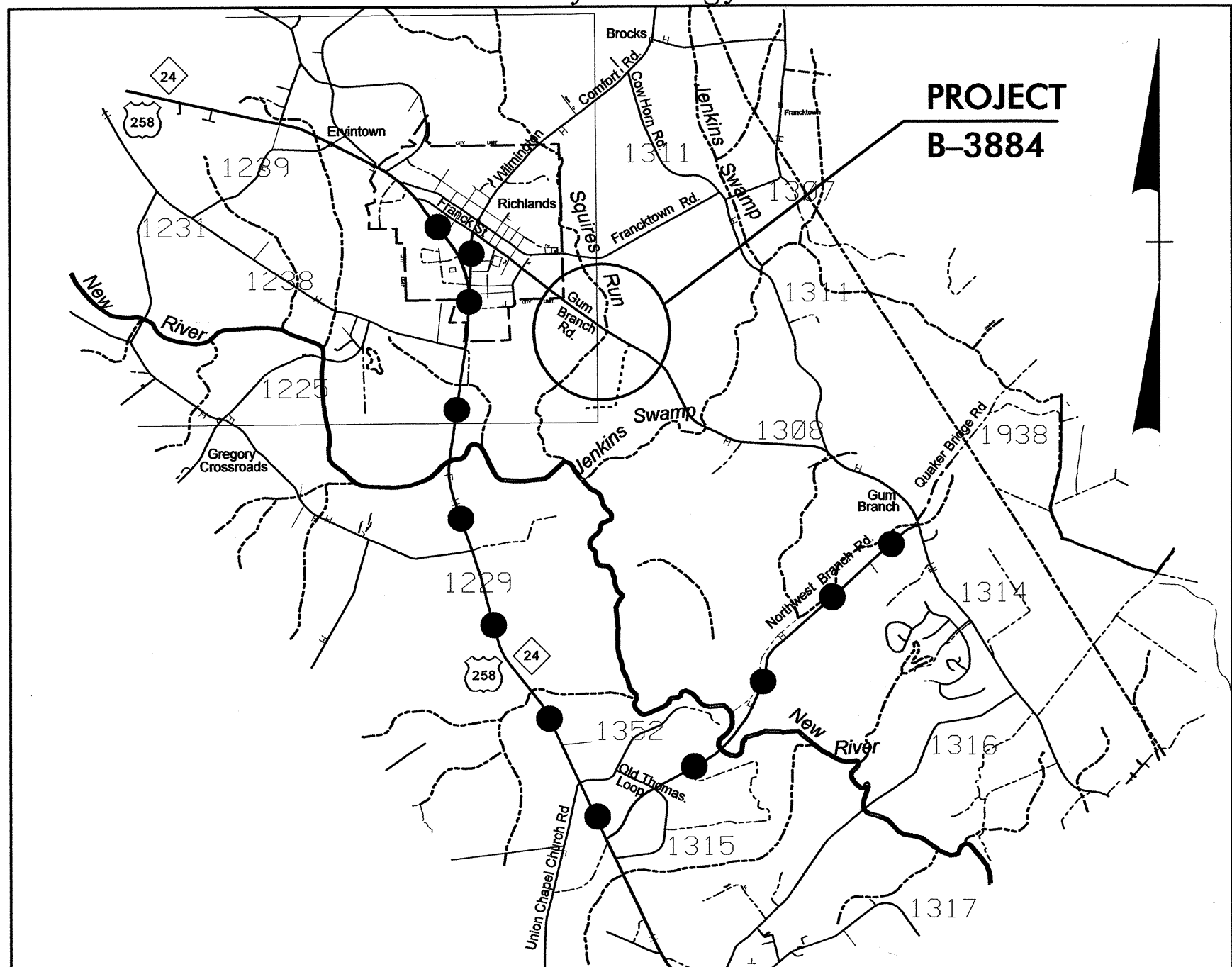

VICINITY MAP
 OFFSITE DETOUR ROUTE ●—●—●—●

STATE OF NORTH CAROLINA
 DIVISION OF HIGHWAYS

ONSLOW COUNTY

**LOCATION: BRIDGE NO. 40 AND APPROACHES OVER SQUIRES RUN
 ON SR 1308**

**TYPE OF WORK: PAVEMENT, GRADING, STRUCTURES, DRAINAGE,
 AND GUARDRAIL**

STATE	STATE PROJECT REFERENCE NO.	SHEET NO.	TOTAL SHEETS
N.C.	B-3884	1	
STATE PROJ. NO.	F.A. PROJ. NO.	DESCRIPTION	
33324.1.1	BRSTP-1308(3)	PE/UTIL	
33324.2.2	BRSTP-1308(3)	RW	
33324.3.1	BRSTP-1308(5)	CONST	

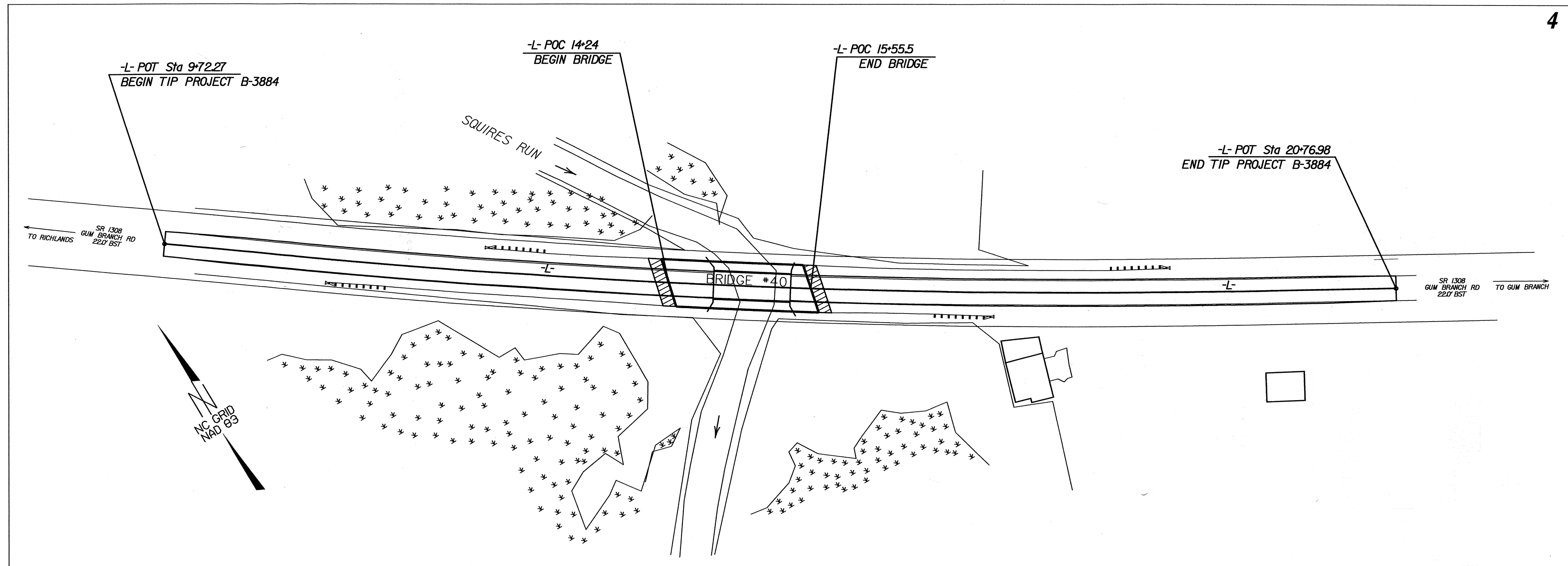

THIS PROJECT DOES NOT LIE WITHIN THE RICHLANDS CITY LIMITS.

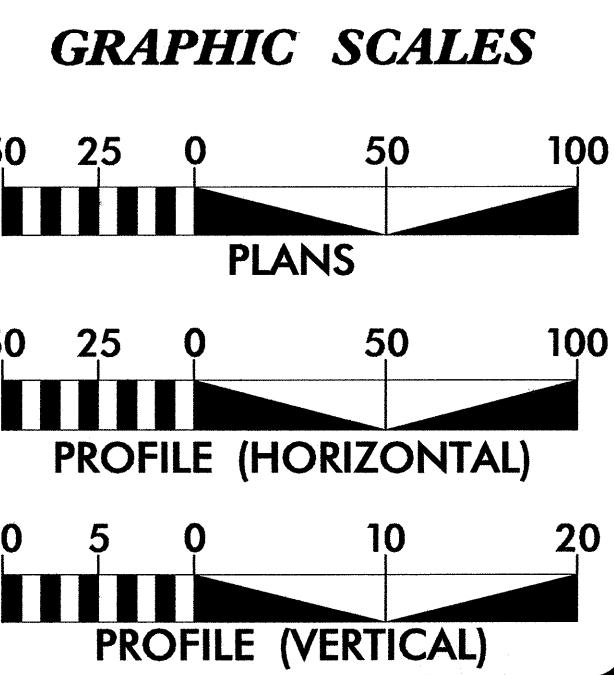

DESIGN DATA

ADT 2003 =	8,500
ADT 2023 =	12,400
DHV =	12 %
D =	60 %
T =	3 % *
V =	60 MPH
* TTST 1%	DUAL 2%

PROJECT LENGTH

LENGTH OF ROADWAY TIP PROJECT B-3884 = 0.184 MILE
 LENGTH OF STRUCTURE TIP PROJECT B-3884 = 0.025 MILE
 LENGTH OF TIP PROJECT B-3884 = 0.209 MILE

NCDOT CONTACT:

CATHY HOUSER, PE
 PROJECT ENGINEER - DESIGN SERVICES

Prepared for NCDOT in the Office of:
CH ENGINEERING, PLLC
 4601 LAKE BOONE TRAIL, RALEIGH, NC 27607

RIGHT OF WAY DATE:
 AUGUST 29, 2002

LETTING DATE:
 August 17, 2004

THOMAS R. HEPLER, PE
 PROJECT ENGINEER

CAROLYN E. KESLER, PE
 PROJECT DESIGN ENGINEER

HYDRAULICS ENGINEER

THOMAS R. HEPLER
 SIGNATURE: 7/2/03

ROADWAY DESIGN ENGINEER

CAROLYN E. KESLER
 SIGNATURE: 6/23/04

**DIVISION OF HIGHWAYS
 STATE OF NORTH CAROLINA**

P.E.

STATE DESIGN ENGINEER

**DEPARTMENT OF TRANSPORTATION
 FEDERAL HIGHWAY ADMINISTRATION**

APPROVED: _____ DATE: _____

SYSTEMS \$\$\$\$\$\$ CONSULTANTS \$\$\$\$\$\$ SURVIVAL \$\$\$\$\$\$