

5/14/99

PROJECT REFERENCE NO. B-3884	SHEET NO. 5
ROADWAY DESIGN ENGINEER NORTH CAROLINA PROFESSIONAL ENGINEER 14455 THOMAS R. HEPLER 5/22/03	HYDRAULICS ENGINEER NORTH CAROLINA PROFESSIONAL ENGINEER 14455 ED L. BARTELT 5/22/03

STRUCTURE HYDRAULIC DATA	
DRAINAGE AREA	= 20.31 SQ MI
DESIGN DISCHARGE	= 1,900 CFS
DESIGN HW FREQUENCY	= 25 YRS
DESIGN HW ELEVATION	= 23.7 FT
BASE DISCHARGE	= 3,090 CFS
BASE HW ELEVATION	= 25.0 FT
OVERTOPPING FREQUENCY	= 100+ YRS
OVERTOPPING DISCHARGE	= 3,240 CFS
OVERTOPPING ELEVATION	= 46.8 FT
BASE WATERWAY OPENING (EX)	= 447 SF
BASE WATERWAY OPENING (PR)	= 608 SF
WHITE OAK RIVER BASIN	

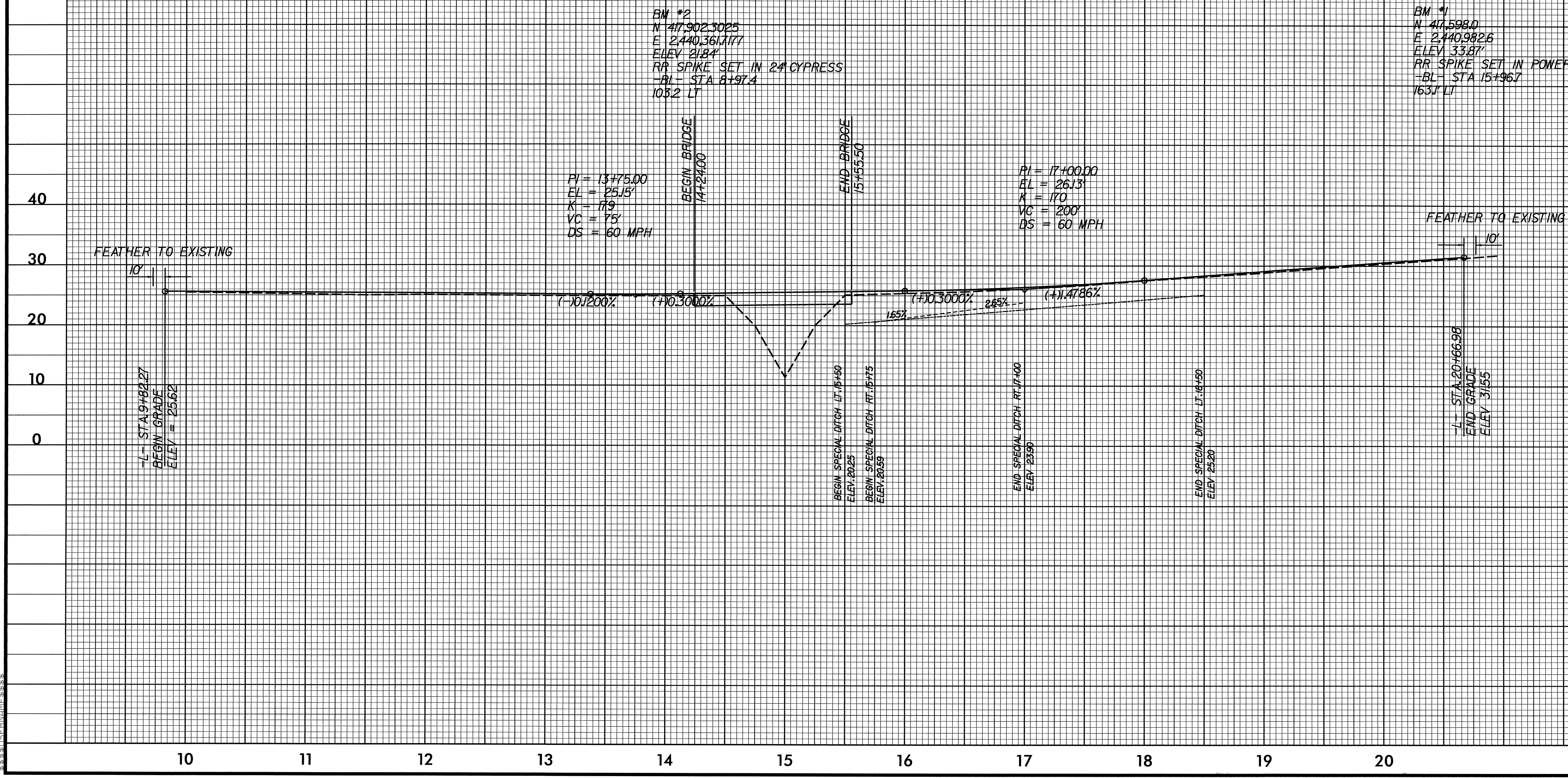

5/14/99