

NOTE:
PLACE TEMPORARY ROCK SEDIMENT DAMS TYPE-B
AND TEMPORARY ROCK SILT CHECKS TYPE-A AT
DRAINAGE OUTLETS.

CLEARING AND GRUBBING
EROSION CONTROL FOR
CONSTRUCTION SHEET 4a

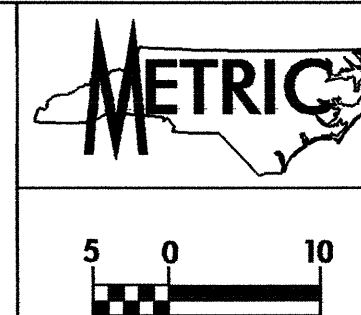

PROJECT REFERENCE NO. U-2734	SHEET NO. EC-3/CONST. 4a
R/W SHEET NO. ROADWAY DESIGN ENGINEER	4a HYDRAULICS ENGINEER
CONST. REV.	
R/W REV.	

-L- STA.13+10.000 BEGIN TIP PROJECT U-2734

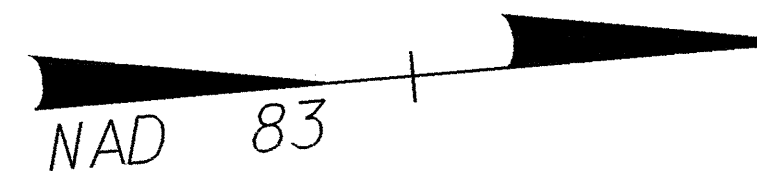

NOTE: SEE SHEET NO.17 FOR -L- PROFILE

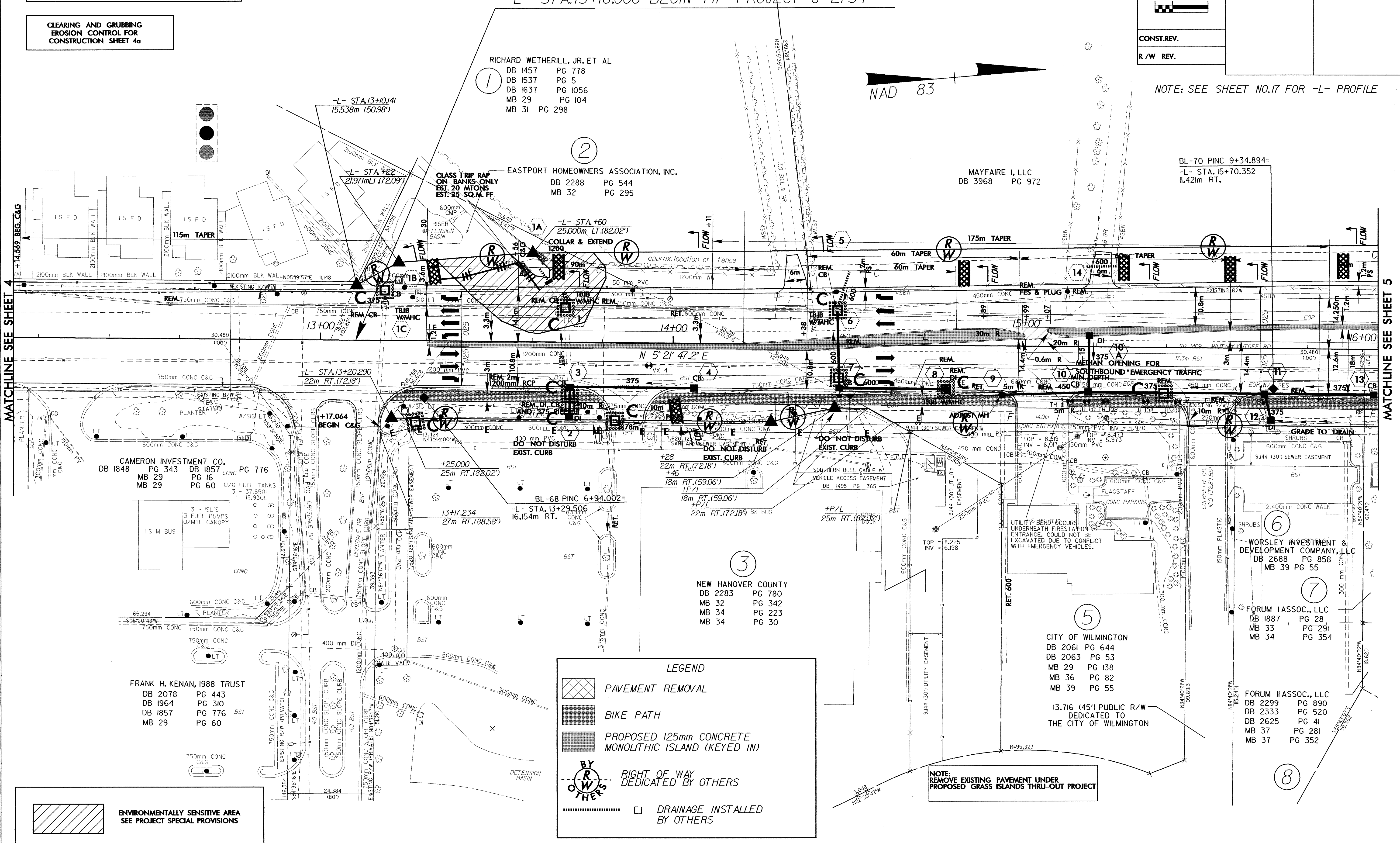

LEGEND

- PAVEMENT REMOVAL
- BIKE PATH
- PROPOSED 125mm CONCRETE MONOLITHIC ISLAND (KEYED IN)
- RIGHT OF WAY DEDICATED BY OTHERS
- DRAINAGE INSTALLED BY OTHERS

ENVIRONMENTALLY SENSITIVE AREA
SEE PROJECT SPECIAL PROVISIONS

MATCHLINE SEE SHEET 4

MATCHLINE SEE SHEET 5

NOTE:
REMOVE EXISTING PAVEMENT UNDER
PROPOSED GRASS ISLANDS THRU-OUT PROJECT

CAMERON INVESTMENT CO.
DB 1848 PG 343 DB 1857 PG 776
MB 29 PG 16 PG 60

FRANK H. KENAN, 1988 TRUST
DB 2078 PG 443
DB 1964 PG 310
DB 1857 PG 776
MB 29 PG 60

RICHARD WETHERILL, JR. ET AL
DB 1457 PG 778
DB 1537 PG 5
DB 1637 PG 1056
MB 29 PG 104
MB 31 PG 298

EASTPORT HOMEOWNERS ASSOCIATION, INC.
DB 2288 PG 544
MB 32 PG 295

MAYFAIRE I, LLC
DB 3968 PG 972

BL-70 PINC 9+34.894=
-L- STA. 15+70.352
11.421m RT.

BL-68 PINC 6+94.002=
-L- STA. 13+29.506
16.154m RT.

NEW HANOVER COUNTY
DB 2283 PG 780
MB 32 PG 342
MB 34 PG 223
MB 34 PG 30

CITY OF WILMINGTON
DB 2061 PG 644
DB 2063 PG 53
MB 29 PG 138
MB 36 PG 82
MB 39 PG 55

WORSLEY INVESTMENT &
DEVELOPMENT COMPANY, LLC
DB 2688 PG 858
MB 39 PG 55

FORUM I ASSOC., LLC
DB 1887 PG 28
MB 33 PG 291
MB 34 PG 354

FORUM II ASSOC., LLC
DB 2299 PG 890
DB 2333 PG 520
DB 2625 PG 41
MB 37 PG 281
MB 37 PG 352